



Madison, Wisconsin

CITY OF MADISON

CITY ENGINEERING DIVISION DEPARTMENT OF PUBLIC WORKS

PLAN OF PROPOSED IMPROVEMENT

PUBLIC IMPROVEMENT PROJECT APPROVED

NOVEMBER 30, 2010

BY THE COMMON COUNCIL OF MADISON, WISCONSIN

PUBLIC IMPROVEMENT DESIGN APPROVED BY:

[Signature]
City Engineer

4/30/13
Date

SIDEWALK DESIGNED BY:

NA - EAST STORM SEWER ONLY

ELECTRICAL DESIGNED BY:

NA - EAST STORM SEWER ONLY

SANITARY SEWER DESIGNED BY:

NA - EAST STORM SEWER ONLY

STORM SEWER DESIGNED BY:

STAMPED SHEETS C1.04 & C1.08

INDEX OF SHEETS

SHEET NO. C1.04 EAST STORM SEWER PLAN AND PROFILE
SHEET NO. C1.08 DETAILS

SHEET NO. C1.05X PUBLIC UTILITIES WITHIN PRIVATE DRIVE PLAN AND PROFILE

EDGEWATER REDEVELOPMENT UTILITIES ONLY (EAST STORM SEWER AND STORM SEWER WITHIN PRIVATE DRIVE)

CITY PROJECT NO. 53B2241
CONTRACT NO. 2241

AND STORM SEWER WITHIN PRIVATE DRIVE

CONVENTIONAL SIGNS	
FIELD VERIFY ALL UTILITY LOCATIONS	
GAS	— G —
STORM SEWER	— ST —
SANITARY SEWER	— SAN —
WATER	— W —
OVERHEAD ELECTRIC	— OH —
POWER POLE	⊕
ADA COMPLIANT RAMP W/ DETECTABLE WARNING FIELD	
COMBUSTIBLE FLUIDS	

CONSTRUCTION PROJECT LOCATION

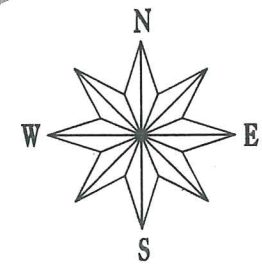
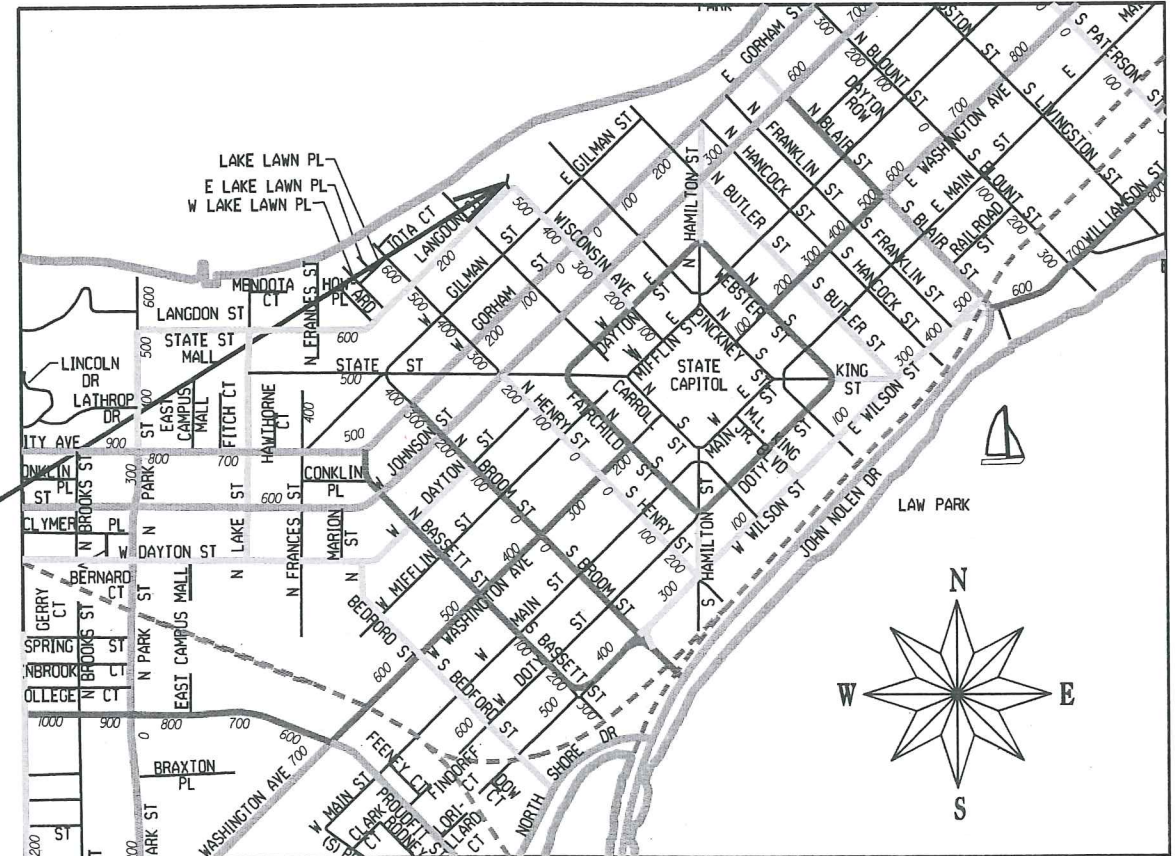

PLOT SCALE:

PLOT NAME:

REV. DATE:

ORIGINATOR: CITY OF MADISON, STREETS DIVISION

- LEGEND**
- EXISTING GRADE (1' CONTOUR)
 - EXISTING GRADE (5' CONTOUR)
 - EXISTING TREELINE/VEGETATION
 - EXISTING SHORELINE
 - PROPERTY LINE (SUBJECT PROPERTY)
 - PROPERTY LINE/RIGHT-OF-WAY
 - E --- PROPOSED ELECTRIC UTILITY
 - SA --- PROPOSED SANITARY SEWER
 - ST --- PROPOSED STORM SEWER
 - W --- PROPOSED WATER MAIN
 - MH1 --- PROPOSED MANHOLE
 - IN1 --- PROPOSED STORM INLET
 - ⊙ --- PROPOSED SEDIMENT TRAP

- GENERAL NOTES:**
1. RIGHT-OF-WAY AND PROPERTY LINES BASED ON CERTIFIED SURVEY MAP 13401.
 2. TOPOGRAPHIC CONTOURS, VEGETATION, AND UTILITY LOCATIONS BASED ON SITE SURVEY PERFORMED BY BT SQUARED, INC. ON JUNE 30, 2009 AND UPDATED BY SCS BT SQUARED, NOVEMBER 2012.
 3. PROPOSED SITE FEATURES OBTAINED FROM ELKUS MANFREDI ARCHITECTS.
 4. EDGEWATER ADDITION ROOF DRAINS, AUTO COURT, AND PLAZA YARD DRAINS DISCHARGE THROUGH BUILDING TO LAKE MENDOTA PER PLUMBING CONTRACTOR.
 5. INSTALL UTILITIES IN ACCORDANCE WITH CITY OF MADISON STANDARD SPECIFICATION UNLESS OTHERWISE NOTED.
 6. PUBLIC STORM SEWER SHALL BE ADS SANITITE HP PIPE MEETING CITY OF MADISON 504.2(b) HAVING A CORRUGATED EXTERIOR AND A SMOOTH INNER LINER. PIPE SHALL BE BEDDED IN ACCORDANCE WITH CITY OF MADISON'S STANDARD DRAWING DETAIL 5.2.1. FITTINGS SHALL BE SANITITE HP DUAL WALL COUPLERS.
 7. ALL PUBLIC IMPROVEMENTS TO BE CONSTRUCTED IN ACCORDANCE WITH THE PLANS APPROVED BY THE CITY ENGINEER PER CITY PROJECT NUMBER 53B2241.
 8. STORM SEWER PIPE SLOPE SHOWN IS FROM THE OUTSIDE TO OUTSIDE OF MANHOLE STRUCTURES.
 9. PIPE LINEAR FOOTAGE MEASURED ALONG THE SLOPE OF THE PIPE.
 10. CAST IRON LUGS SHALL BE INSTALLED ON EACH SIDE OF EVERY PIPE JOINT.
 11. PROPOSED FINISHED SURFACE PROFILE PROVIDED BY ARCHITECT.
 12. REINFORCED CONCRETE PIPE SHALL BE INSTALLED ACCORDANCE WITH SECTION 607 & 608 OF THE WISDOT STANDARD SPECIFICATIONS FOR HIGHWAY AND STRUCTURE CONSTRUCTION 2013 EDITION
 13. ALL REINFORCED CONCRETE PIPE AND ENDWALLS SHALL BE JOINTED TIED TOGETHER IN ACCORDANCE WITH WISDOT STANDARD DETAIL DRAWING 8F4 (JOINT TIES FOR CONCRETE PIPE)
 14. RESTORATION OF PIPE TRENCH SHALL BE TOP DRESSED WITH A MINIMUM OF 6" OF TOPSOIL, AND SEEDED WITH NO MOW FESCUE (4 LBS/1000 SQ FT AND A COVER CROP OF OATS 2 LBS/1000 SQ FT), POLYMER APPLIED, AND MATTED WITH CLASS 2 TYPE B - ORGANIC MATTING.
 15. PRIVATE DRIVE UTILITIES WILL BE APPROVED SEPARATELY.
 16. ALL EROSION CONTROL MEASURES SHALL BE IN ACCORDANCE WITH THE APPROVED EROSION CONTROL PERMIT ON FILE WITH THE CITY OF MADISON.
 17. CITY OF MADISON VERTICAL DATUM = 0.00
NAVD 88 VERTICAL DATUM = 845.40
 18. RIP RAP SHALL MEET CITY OF MADISON'S HEAVY RIP RAP SPECIFICATION.

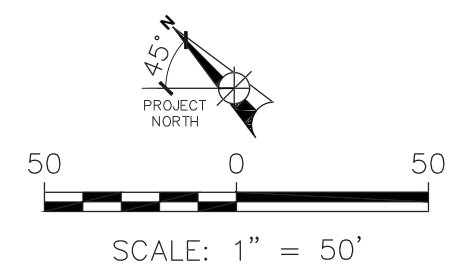
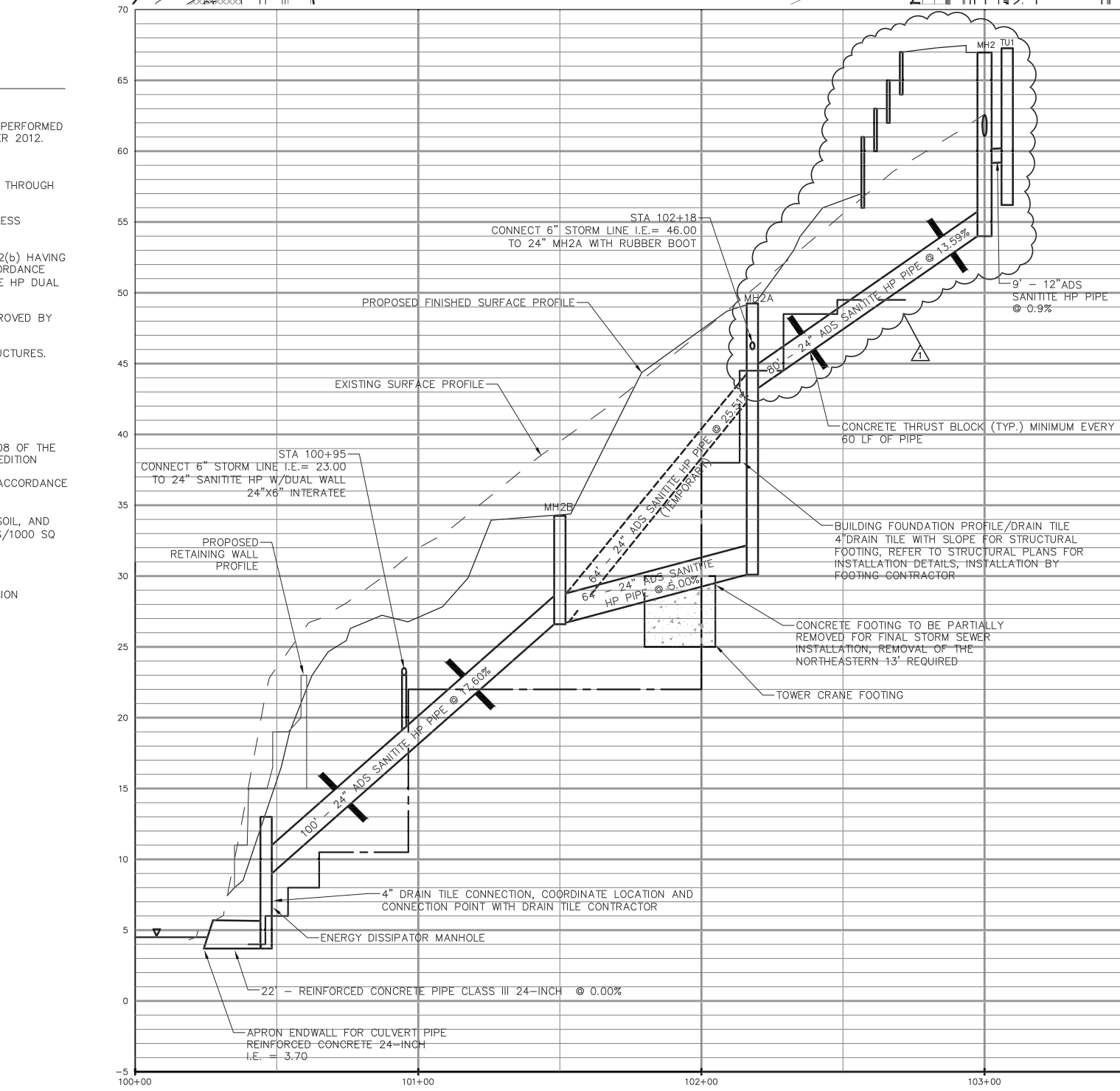
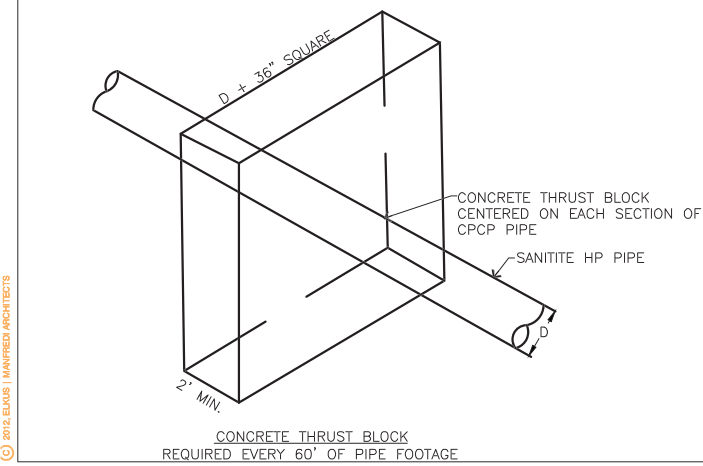
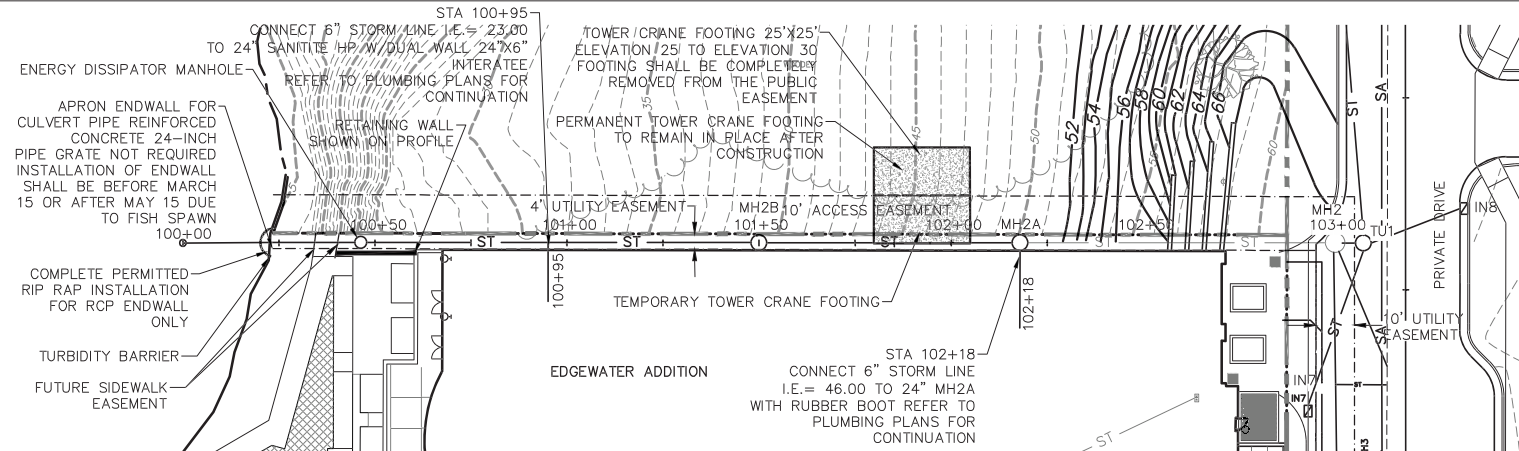

ENERGY DISSIPATOR MANHOLE - 100+46.30
 NEENAH R-1917 ANCHORED TO ROOF W/ANCHOR-TITE CONCRETE ANCHORS
 MANHOLE SHALL BE FIELD POURED W/ADDITIONAL 3.5' OVER POUR AROUND PERIMETER (SEE DETAIL C 1.08)
 STRUCTURE SHALL BE REINFORCED PER CITY OF MADISON SDD 5.7.3, AND THE ROOF SHALL BE POURED INTEGRAL TO THE WALLS AND TIED WITH #4 L BARS 8" O.C. AROUND THE PERIMETER OF THE STRUCTURE
 RIM = 13.00
 NWE = 3.70 (24" RCP)
 SEIE = 9.00 (24" SANITITE HP)

MH2 - 103+00.00
 NEENAH R-1550 W/LOGO LID 1550-0054 (S.D.D. 5.7.16)
 TYPE C LID NON-ROCKING, MANHOLES 5-FT DIAMETER
 RIM = 66.96
 NWE = 54.00 (24" SANITITE HP)
 SIE = 54.60 (6" CPEP)
 SWIE = 61.05 (18" RCP)
 SEIE = 59.11 (12" SANITITE HP)
 NEIE = 58.83 (12" CPEP)

MH2A - 102+18.00
 NEENAH R-1917 ANCHORED TO ROOF W/ANCHOR-TITE CONCRETE ANCHORS
 MANHOLE SHALL BE FIELD POURED W/ADDITIONAL 3.5' OVER POUR AROUND PERIMETER (SEE DETAIL C 1.08)
 STRUCTURE SHALL BE REINFORCED PER CITY OF MADISON SDD 5.7.3, AND THE ROOF SHALL BE POURED INTEGRAL TO THE WALLS AND TIED WITH #4 L BARS 8" O.C. AROUND THE PERIMETER OF THE STRUCTURE
 RIM = 49.25
 SWIE = 46.00 (6" PVC)
 NWE = 30.10 (24" SANITITE HP)
 NWE = 43.03 (24" SANITITE HP - TEMPORARY)
 NEIE = 43.13 (24" SANITITE HP)

MH2B - 101+50.00
 NEENAH R-1550 W/LOGO LID 1550-0054 (S.D.D. 5.7.16)
 TYPE C LID NON-ROCKING, MANHOLES 4-FT DIAMETER
 RIM = 34.25
 NWE = 26.70 (24" SANITITE HP)
 NEIE = 26.60 (24" SANITITE HP)



The Edgewater Hotel
 666 Wisconsin Avenue
 Madison, WI 53703

Owner:
Edgewater Hotel Company, LLC
 22 East Mifflin Street, Suite 800
 Madison, WI 53703

Developer:
Hammes Company
 22 East Mifflin Street, Suite 800
 Madison, WI 53703

Civil Engineer:
SCS Engineers
 2830 Dairy Drive
 Madison, WI 53718

Landscape Architect:
Ken Saiki Design, Inc.
 303 S. Patterson, Suite One
 Madison, WI 53703

MEP/FP/IT/Lighting Design:
KJWW Engineering Consultants
 802 West Broadway, Suite 312
 Madison, WI 53713

Structural Engineer:
Pierce Engineers, Inc.
 10 West Mifflin Street, Suite 205
 Madison, WI 53713

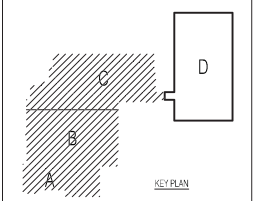

PACKAGE #7:
 CONSTRUCTION DOCUMENTS

PROJECT NUMBER: 08105.03

DATE: APRIL 29, 2014

REVISIONS:
 05/02/14 - MH2 PIPE INVERTS LOWERED

SCALE: 1" = 50'

DRAWING NAME:

EAST STORM SEWER
 PLAN AND PROFILE

DRAWING NUMBER:



REVISED 5/7/14 BT2

C1.04



The Edgewater Hotel

666 Wisconsin Avenue
Madison, WI 53703

Owner:
Edgewater Hotel Company, LLC
22 East Mifflin Street, Suite 800
Madison, WI 53703

Developer:
Hammes Company
22 East Mifflin Street, Suite 800
Madison, WI 53703

Civil Engineer:
SCS Engineers
2830 Dairy Drive
Madison, WI 53718

Landscape Architect:
Ken Saiki Design, Inc.
303 S. Patterson, Suite One
Madison, WI 53703

MEP/FP/IT/Lighting Design:
KJWW Engineering Consultants
802 West Broadway, Suite 312
Madison, WI 53713

Structural Engineer:
Pierce Engineers, Inc.
10 West Mifflin Street, Suite 205
Madison, WI 53713

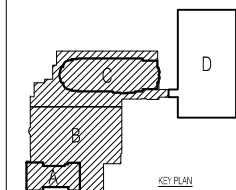

CITY ISSUED PLAN

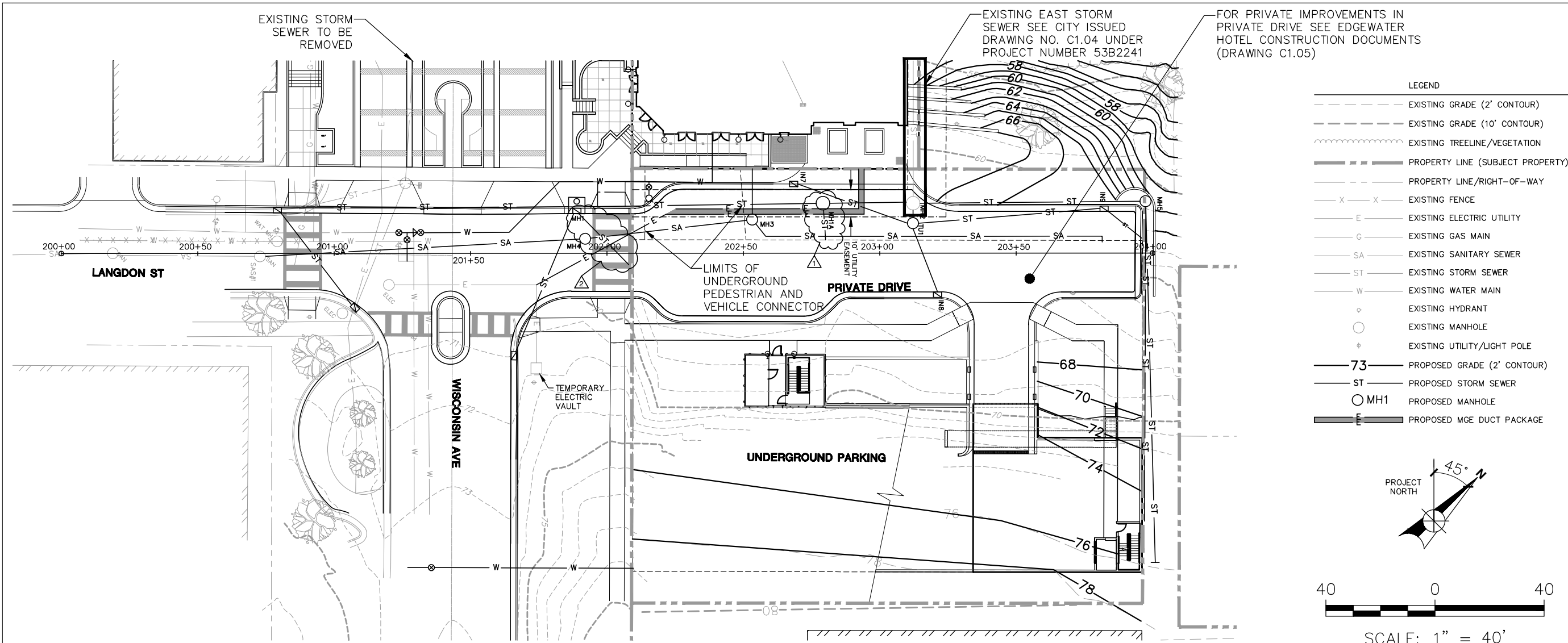

LEGEND

- - - - - EXISTING GRADE (2' CONTOUR)
- - - - - EXISTING GRADE (10' CONTOUR)
- ~~~~~ EXISTING TREELINE/VEGETATION
- ===== PROPERTY LINE (SUBJECT PROPERTY)
- - - - - PROPERTY LINE/RIGHT-OF-WAY
- X - X - EXISTING FENCE
- E - EXISTING ELECTRIC UTILITY
- G - EXISTING GAS MAIN
- SA - EXISTING SANITARY SEWER
- ST - EXISTING STORM SEWER
- W - EXISTING WATER MAIN
- o EXISTING HYDRANT
- o EXISTING MANHOLE
- o EXISTING UTILITY/LIGHT POLE
- 73 PROPOSED GRADE (2' CONTOUR)
- ST PROPOSED STORM SEWER
- MH1 PROPOSED MANHOLE
- E PROPOSED MGE DUCT PACKAGE

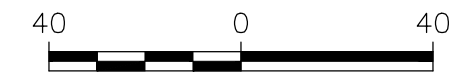
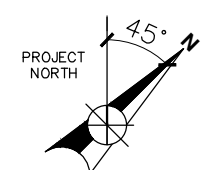

SCALE: 1" = 40'

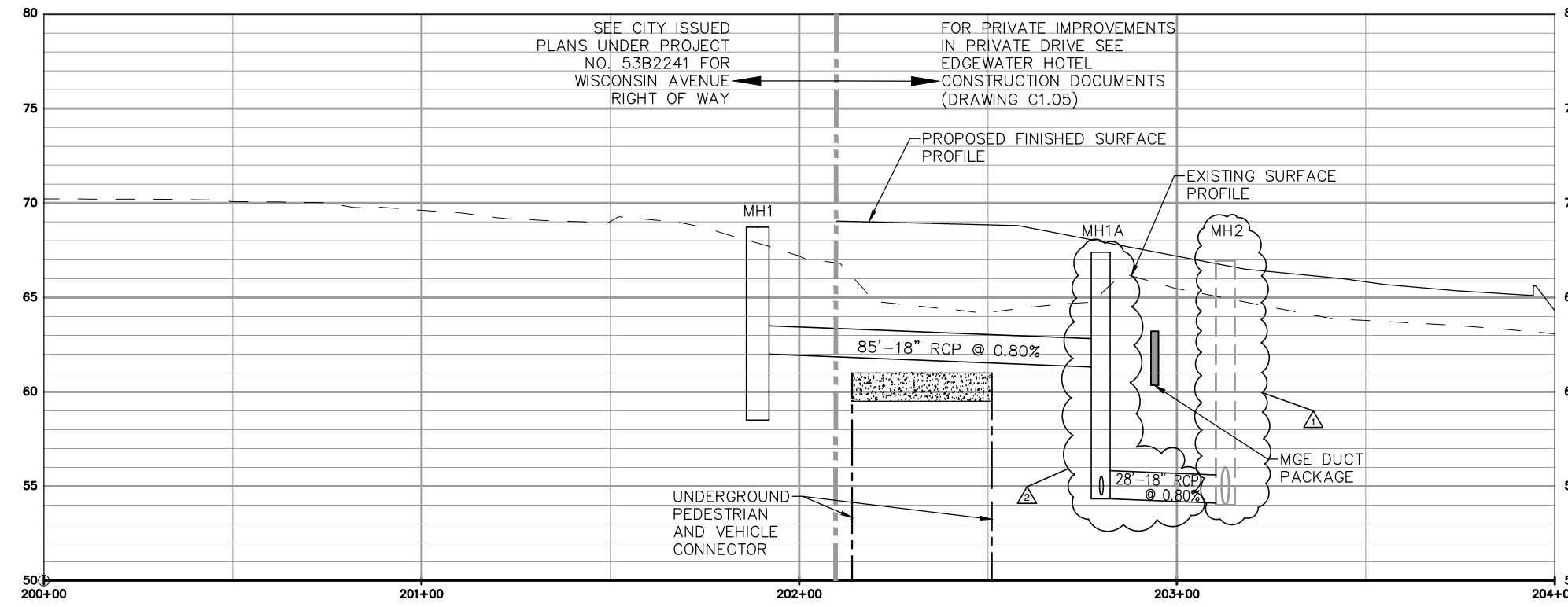

STORM SEWER STRUCTURES

MH 1 - 201+89.00 16.69' LT
6'x6' CATCH BASIN W/ 3' SUMP (15.62' LT TO R-3067 CASTING FACE OF CURB; 18.25' LT TO R-1550 CASTING CENTER)
MADISON STANDARD 5.7.4
TOP OF CASING FOR R-3067-7004=69.12
TOP OF CASING FOR R-1550-0054 LOGO LID=69.16
WE = 62.25 (PROVIDE 15" BOX OUT FOR FUTURE PIPE)
EIE = 62.00
SWE = 62.25 (PROVIDE 15" BOX OUT FOR FUTURE PIPE)
SEIE = 63.00 (4" CPEP - FIELD VERIFY)
SUMP FLOOR = 59.00
NOTE: INVERTS ARE FROM "PROJECT NORTH"

MH2 - 103+00.00
NEENAH R-1500-0054 (S.D.D. 5.7.16) TYPE C LID NON-ROCKING, MANHOLES 5-FT DIAMETER
RIM = 66.96
NWE = 54.00 (24" SANITITE HP)
SWE = 54.10 (18" RCP)
SEIE = 59.11 (12" SANITITE HP)
NEIE = 58.83 (12" CPEP)

MH1A - 102+79.23 18.31' LT
NEENAH R-1500-0054 (S.D.D. 5.7.16) TYPE C LID NON-ROCKING, MANHOLES 5-FT DIAMETER
RIM = 67.39
SWE = 61.32 (18" RCP)
NEIE = 54.32 (18" RCP)
SEIE = 54.70 (6" CPEP)

NOTES:

1. EXISTING BUILDING LOCATIONS BASED ON ALTA SURVEY PREPARED BY BADGER SURVEYING AND MAPPING SERVICE, JULY 17, 1997.
2. RIGHT-OF-WAY AND PROPERTY LINES BASED ON CERTIFIED SURVEY MAP 13401.
3. TOPOGRAPHIC CONTOURS, VEGETATION, AND UTILITY LOCATIONS BASED ON SITE SURVEY PERFORMED BY BT SQUARED, INC. ON JUNE 30, 2009 AND UPDATED BY SCS BT SQUARED, NOVEMBER 2012.
4. PROPOSED SITE FEATURES OBTAINED FROM ELKUS MANFREDI ARCHITECTS.
5. INSTALL UTILITIES IN ACCORDANCE WITH CITY OF MADISON STANDARD SPECIFICATIONS UNLESS OTHERWISE NOTED.
6. ALL PUBLIC IMPROVEMENTS TO BE CONSTRUCTED IN ACCORDANCE WITH THE PLANS APPROVED BY THE CITY ENGINEER PER CITY PROJECT NUMBER 53B2241.

PROJECT NUMBER: 08105.03

DATE: APRIL 29, 2014

- REVISIONS:
- 05/02/14 - MH2 PIPE INVERTS LOWERED
 - 05/19/14 - ADD MH1A

SCALE: 1" = 40'

DRAWING NAME:
PUBLIC UTILITIES WITHIN PRIVATE DRIVE PLAN AND PROFILE

DRAWING NUMBER:

C1.05X



The Edgewater Hotel
866 Wisconsin Avenue
Madison, WI 53703

Owner:
Edgewater Hotel Company, LLC
22 East Mifflin Street, Suite 800
Madison, WI 53703

Developer:
Hammes Company
22 East Mifflin Street, Suite 800
Madison, WI 53703

Civil Engineer:
SCS Engineers
2830 Dairy Drive
Madison, WI 53718

Landscape Architect:
Ken Saiki Design, Inc.
303 S. Patterson, Suite One
Madison, WI 53703

MEP/FP/IT/Lighting Design:
KJWW Engineering Consultants
802 West Broadway, Suite 312
Madison, WI 53713

Structural Engineer:
Pierce Engineers, Inc.
10 West Mifflin Street, Suite 205

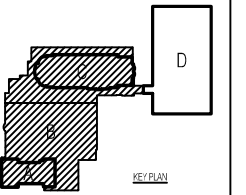

PACKAGE #7:
CONSTRUCTION DOCUMENTS

PROJECT NUMBER: 08105.03

DATE: APRIL 25, 2013

REVISIONS:

SCALE: 1" = 20'

DRAWING NAME:

UTILITY CROSS SECTION
AND DETAILS

DRAWING NUMBER:

C1.08

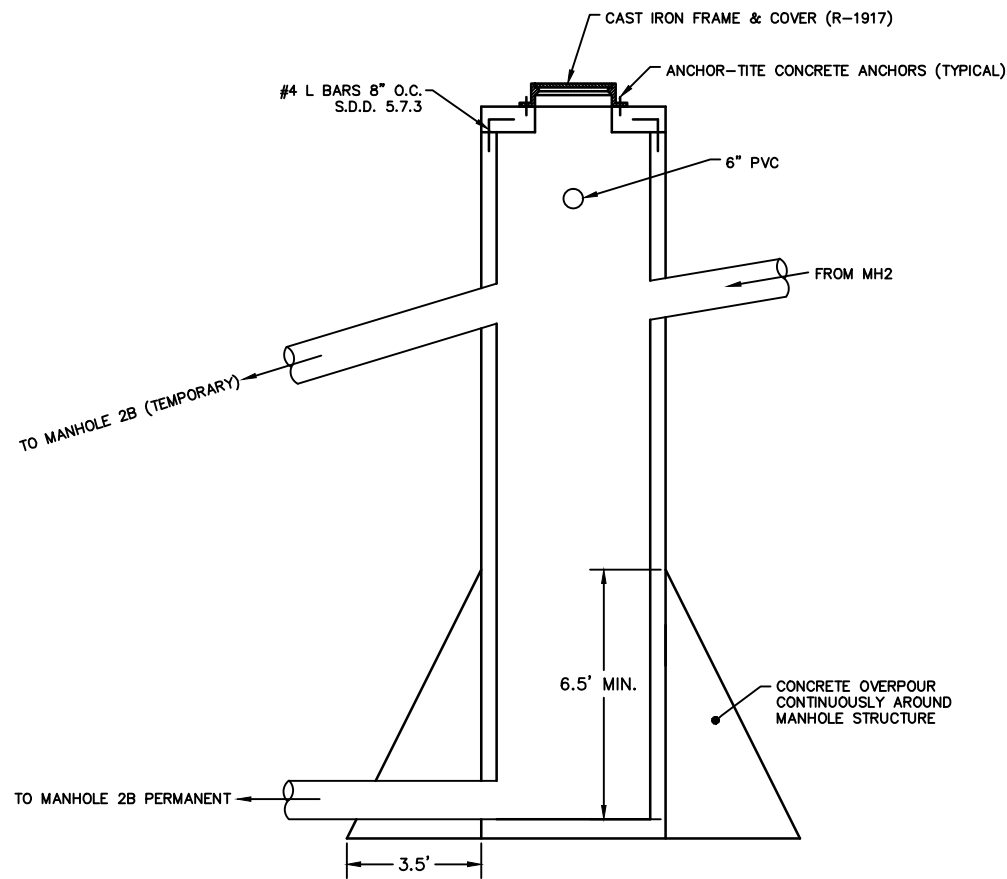

MH 2A
SCALE: 1" = 5'

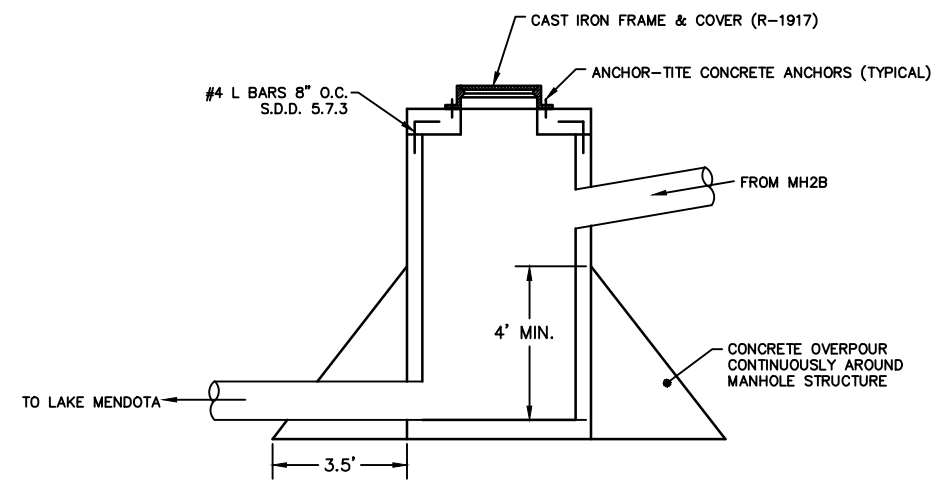

ENERGY DISSIPATOR MANHOLE
SCALE: 1" = 5'

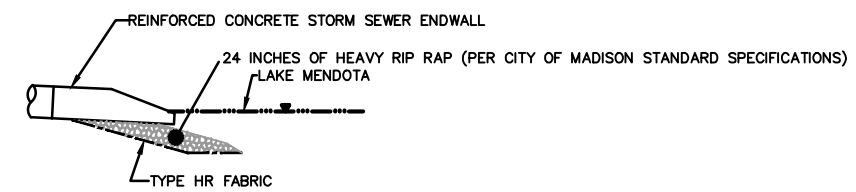

STORM SEWER OUTLET DETAIL
SCALE: 1" = 5'

