

# BOWMAN BASEBALL BACKSTOP REPLACEMENT

## CONTRACT 7841

### MUNIS NO. 10617 -51 -130

City of Madison  
 Department of Public Works  
**PARKS DIVISION**

City-County Building, Suite 104  
 210 Martin Luther King, Jr. Blvd.  
 PO Box 2987  
 Madison, WI 53701-2987



PROJECT:  
*BOWMAN BASEBALL  
 BACKSTOP  
 REPLACEMENT*

*DUANE F. BOWMAN PARK  
 1801 FISH HATCHERY RD.  
 MADISON, WI 53713*

Although every effort has been made in preparing these plans and checking them for accuracy, the contractor and subcontractors must check all details and dimensions of their trade and be responsible for the same.

ITEM	DATE
Drawn by:	xx-xx-xxxx
Approved by:	xx-xx-xxxx

PUBLIC WORKS PROJECT #:  
**7841**

SHEET TITLE:  
***TITLE SHEET***

SHEET NUMBER:

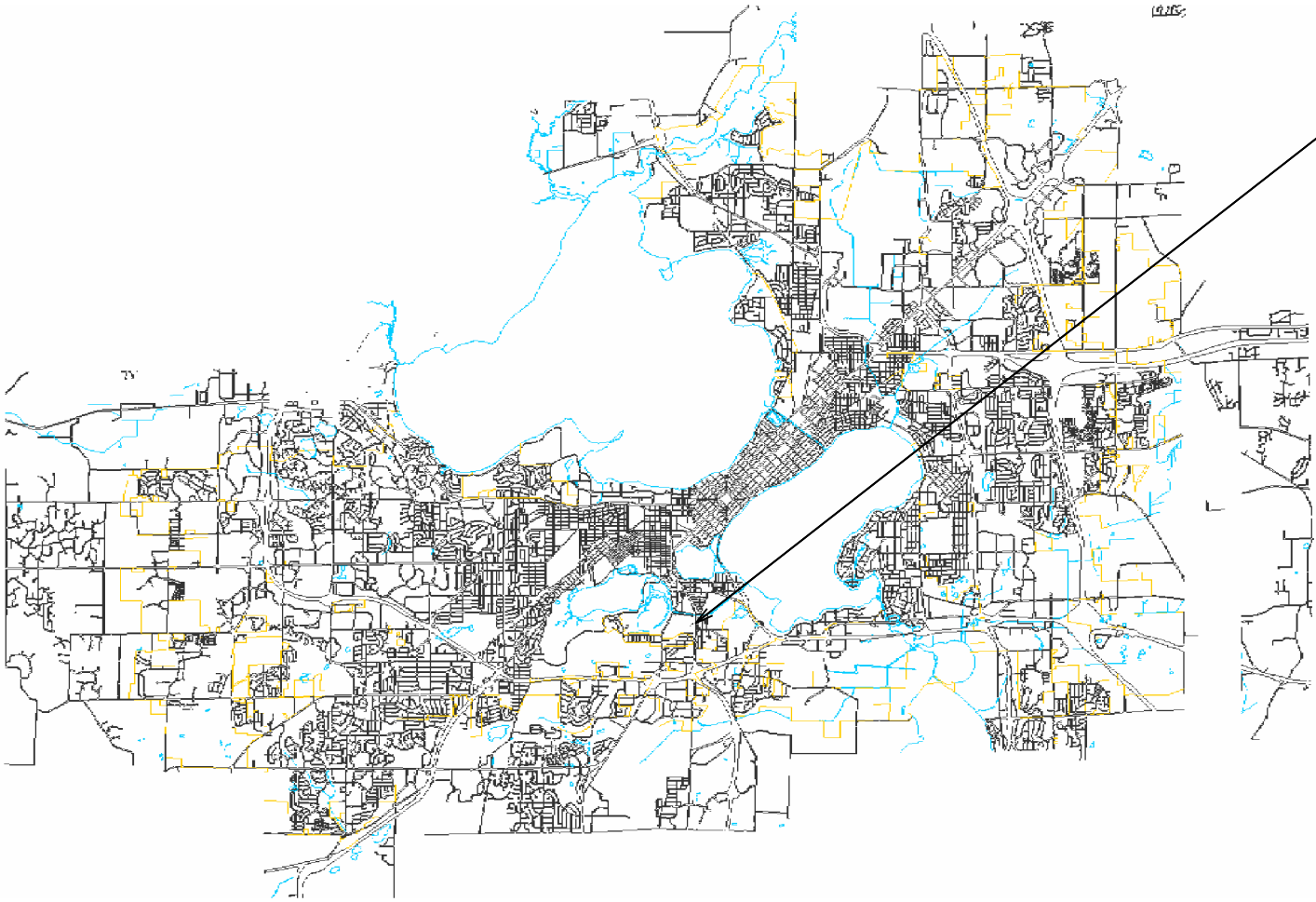

DUANE F. BOWMAN PARK  
 1801 FISH HATCHERY RD.

- SHEET SCHEDULE**
- 1.1 EXISTING SITE
  - 1.2 DEMOLITION AND EROSION CONTROL PLAN
  - 1.3 SITE PLAN
  - 1.4 CHAINLINK FENCE DETAILS
  - 1.5 CHAINLINK FENCE DETAILS
  - 1.6 CHAINLINK FENCE LAYOUT

**ATTACHMENT A - BACKSTOP NETTING SYSTEM AND SUPPORT POLES BASIS OF DESIGN**

**ATTACHMENT B - SOIL BORINGS**

Graphical Scale

0 40 ft



PROJECT:  
**BOWMAN BASEBALL  
BACKSTOP  
REPLACEMENT**

**DUANE F. BOWMAN PARK  
1801 FISH HATCHERY RD.  
MADISON, WI 53713**

Although every effort has been made in preparing these plans and checking them for accuracy, the contractor and subcontractors must check all details and dimensions of their trade and be responsible for the same.

ITEM	DATE
Drawn by:	xx-xx-xxxx
Approved by:	xx-xx-xxxx

PUBLIC WORKS PROJECT #:  
**7841**

SHEET TITLE:  
**EXISTING SITE**

SHEET NUMBER:  
**1.1**

**Fish Hatchery Rd.**

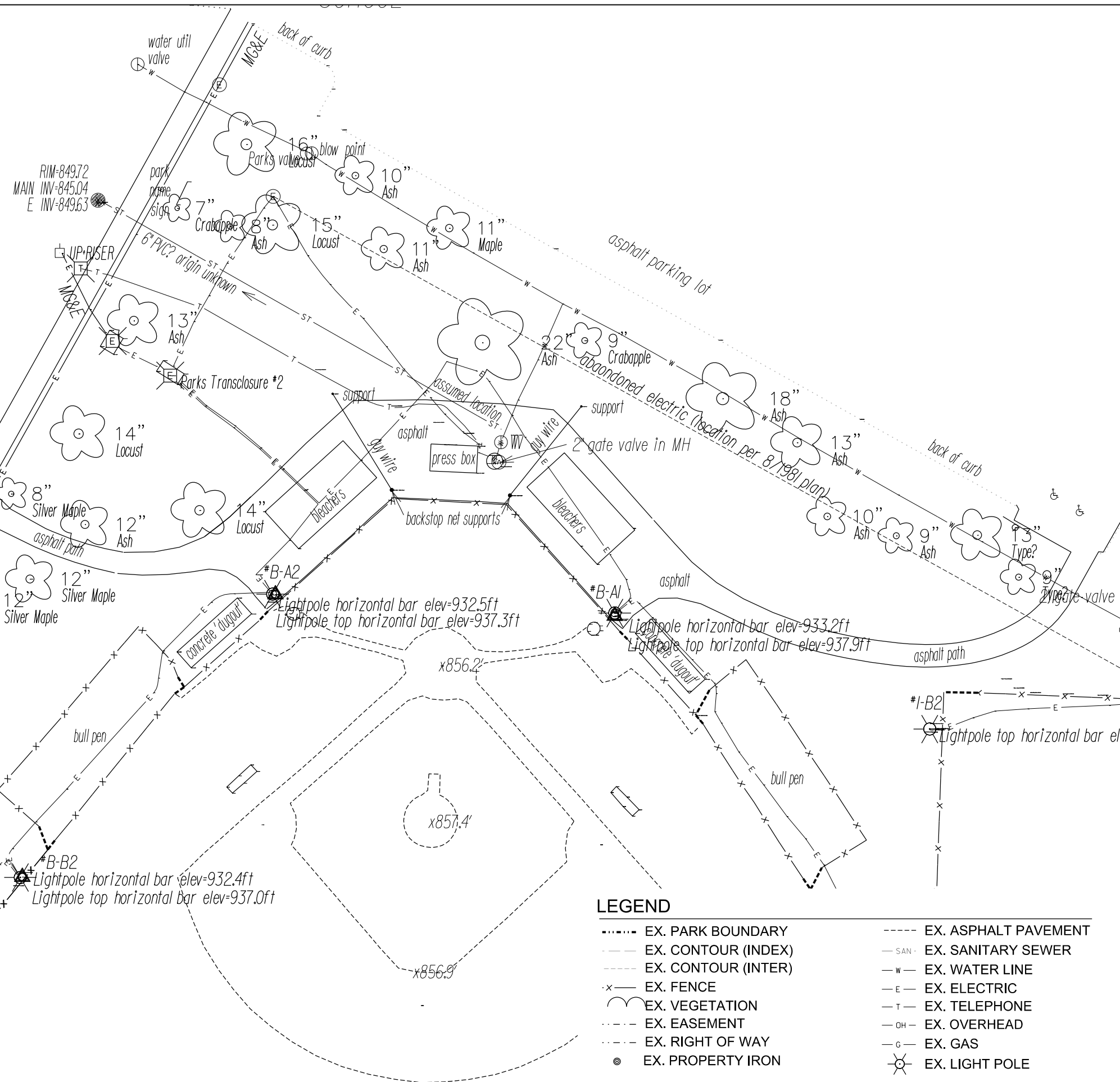

**LEGEND**

- |                               |                                |
|-------------------------------|--------------------------------|
| - - - - - EX. PARK BOUNDARY   | - - - - - EX. ASPHALT PAVEMENT |
| - - - - - EX. CONTOUR (INDEX) | - SAN - EX. SANITARY SEWER     |
| - - - - - EX. CONTOUR (INTER) | - W - EX. WATER LINE           |
| - X - EX. FENCE               | - E - EX. ELECTRIC             |
| - - - - - EX. VEGETATION      | - T - EX. TELEPHONE            |
| - - - - - EX. EASEMENT        | - OH - EX. OVERHEAD            |
| - - - - - EX. RIGHT OF WAY    | - G - EX. GAS                  |
| ⊙ EX. PROPERTY IRON           | ⊙ EX. LIGHT POLE               |

City of Madison  
Department of Public Works  
**PARKS DIVISION**

City-County Building, Suite 104  
210 Martin Luther King, Jr. Blvd.  
PO Box 2987  
Madison, WI 53701-2987

*play*  
**MADISON  
PARKS**

Graphical Scale

0 20 ft



PROJECT:

**BOWMAN BASEBALL  
BACKSTOP  
REPLACEMENT**

**DUANE F. BOWMAN PARK  
1801 FISH HATCHERY RD.  
MADISON, WI 53713**

Although every effort has been made in preparing these plans and checking them for accuracy, the contractor and subcontractors must check all details and dimensions of their trade and be responsible for the same.

ITEM	DATE
Drawn by:	xx-xx-xxxx
Approved by:	xx-xx-xxxx

PUBLIC WORKS PROJECT #:

**7841**

SHEET TITLE:

**DEMOLITION AND  
EROSION CONTROL  
PLAN**

SHEET NUMBER:

**1.2**

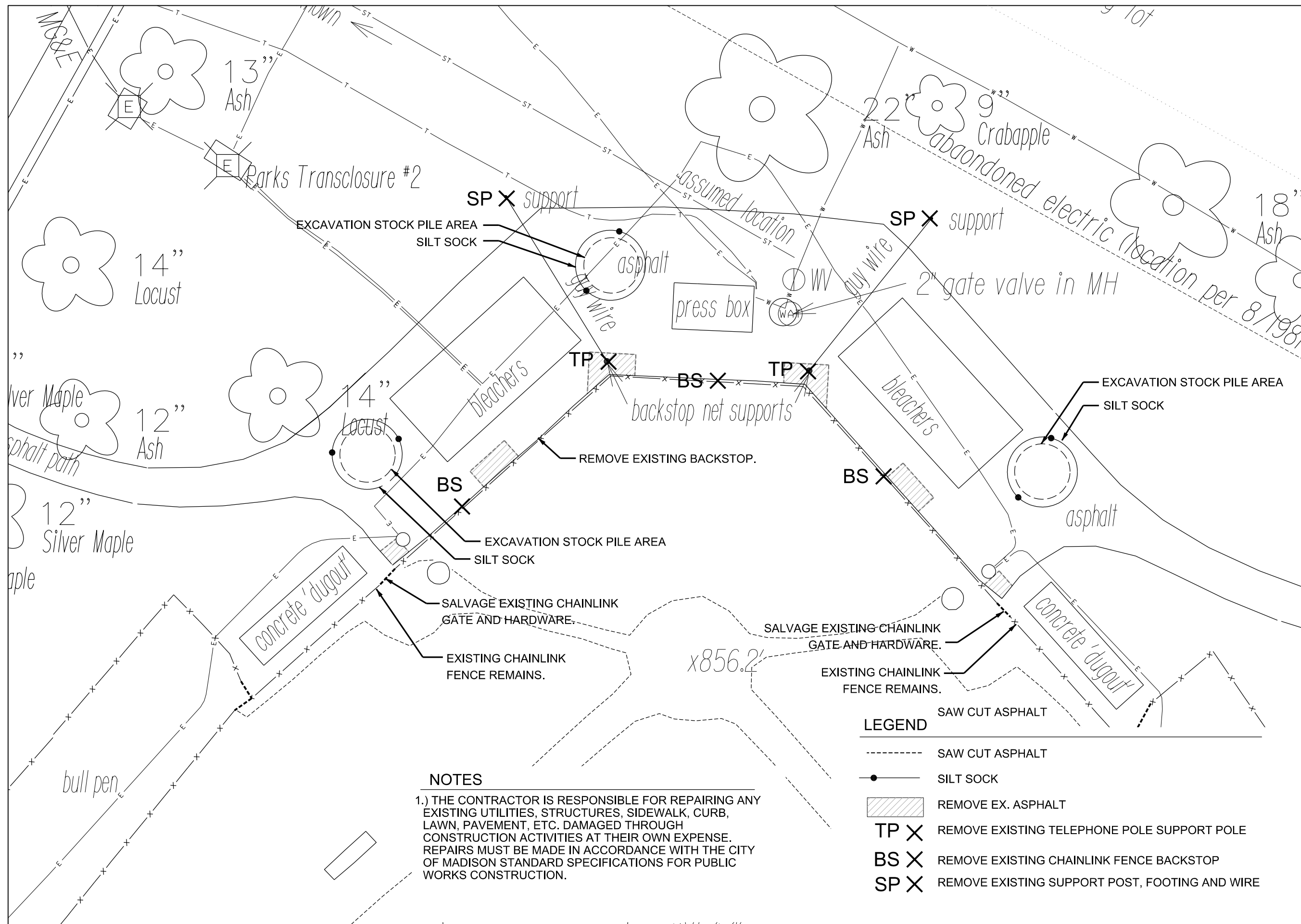

**NOTES**

1.) THE CONTRACTOR IS RESPONSIBLE FOR REPAIRING ANY EXISTING UTILITIES, STRUCTURES, SIDEWALK, CURB, LAWN, PAVEMENT, ETC. DAMAGED THROUGH CONSTRUCTION ACTIVITIES AT THEIR OWN EXPENSE. REPAIRS MUST BE MADE IN ACCORDANCE WITH THE CITY OF MADISON STANDARD SPECIFICATIONS FOR PUBLIC WORKS CONSTRUCTION.

**LEGEND**

- SAW CUT ASPHALT
- SILT SOCK
- ▨ REMOVE EX. ASPHALT
- TP X REMOVE EXISTING TELEPHONE POLE SUPPORT POLE
- BS X REMOVE EXISTING CHAINLINK FENCE BACKSTOP
- SP X REMOVE EXISTING SUPPORT POST, FOOTING AND WIRE

City of Madison  
Department of Public Works  
**PARKS DIVISION**

City-County Building, Suite 104  
210 Martin Luther King, Jr. Blvd.  
PO Box 2987  
Madison, WI 53701-2987

*play*  
**MADISON  
PARKS**

Graphical Scale  
0 20 ft



PROJECT:  
**BOWMAN BASEBALL  
BACKSTOP  
REPLACEMENT**

**DUANE F. BOWMAN PARK  
1801 FISH HATCHERY RD.  
MADISON, WI 53713**

Although every effort has been made in preparing these plans and checking them for accuracy, the contractor and subcontractors must check all details and dimensions of their trade and be responsible for the same.

ITEM	DATE
Drawn by:	xx-xx-xxxx
Approved by:	xx-xx-xxxx

PUBLIC WORKS PROJECT #:  
**7841**

SHEET TITLE:  
**SITE PLAN**

SHEET NUMBER:  
**1.3**

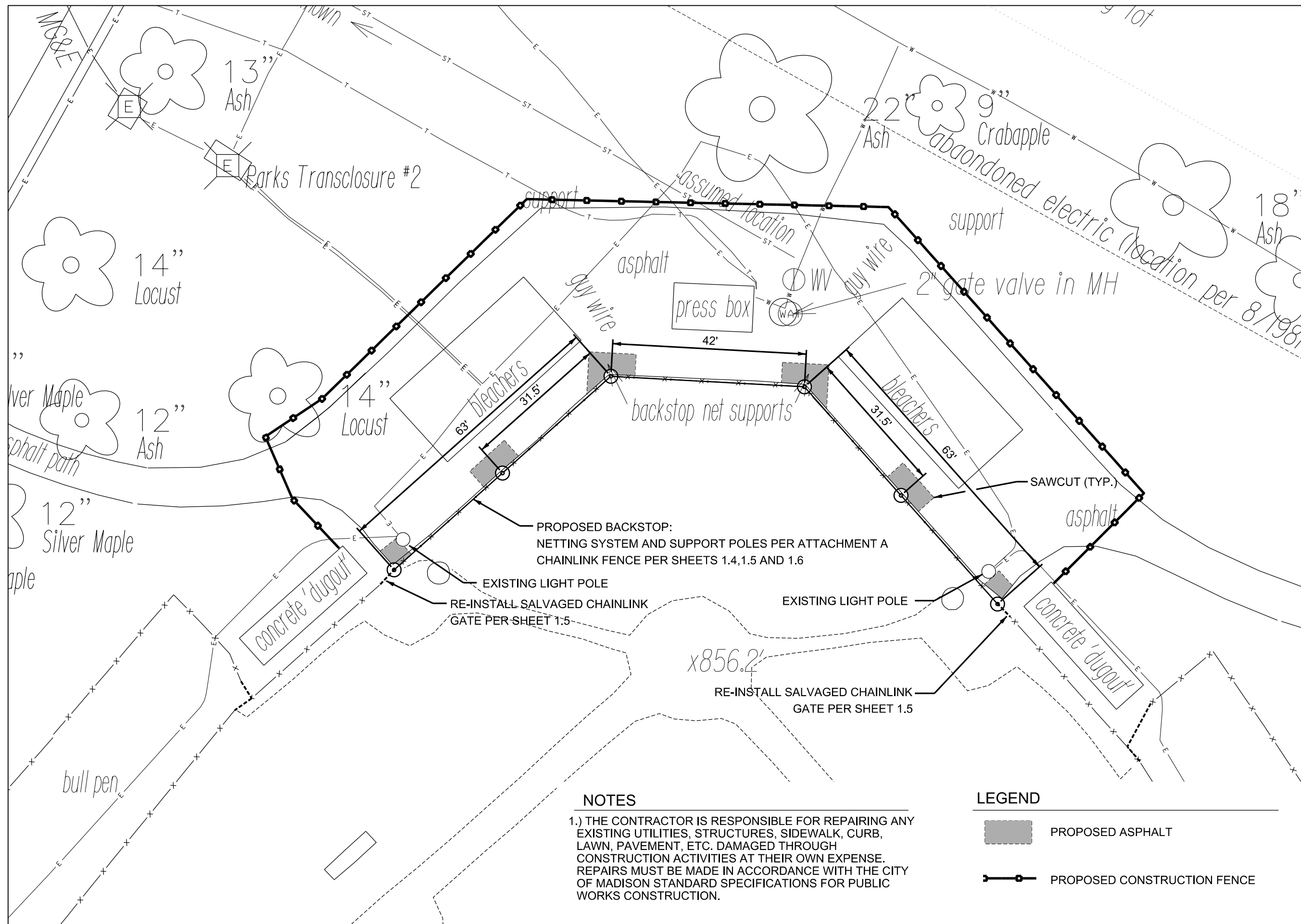

**NOTES**

- 1.) THE CONTRACTOR IS RESPONSIBLE FOR REPAIRING ANY EXISTING UTILITIES, STRUCTURES, SIDEWALK, CURB, LAWN, PAVEMENT, ETC. DAMAGED THROUGH CONSTRUCTION ACTIVITIES AT THEIR OWN EXPENSE. REPAIRS MUST BE MADE IN ACCORDANCE WITH THE CITY OF MADISON STANDARD SPECIFICATIONS FOR PUBLIC WORKS CONSTRUCTION.

**LEGEND**

- PROPOSED ASPHALT
- PROPOSED CONSTRUCTION FENCE

City of Madison  
Department of Public Works  
**PARKS DIVISION**

City-County Building, Suite 104  
210 Martin Luther King, Jr. Blvd.  
PO Box 2987  
Madison, WI 53701-2987

*play*  
**MADISON  
PARKS**

PROJECT:  
**BOWMAN BASEBALL  
BACKSTOP  
REPLACEMENT**

**DUANE F. BOWMAN PARK  
1801 FISH HATCHERY RD.  
MADISON, WI 53713**

Although every effort has been made in preparing these plans and checking them for accuracy, the contractor and subcontractors must check all details and dimensions of their trade and be responsible for the same.

ITEM	DATE
Drawn by:	xx-xx-xxxx
Approved by:	xx-xx-xxxx

PUBLIC WORKS PROJECT #:  
**7841**

SHEET TITLE:  
**CHAINLINK FENCE  
DETAILS**

SHEET NUMBER:  
**1.4**

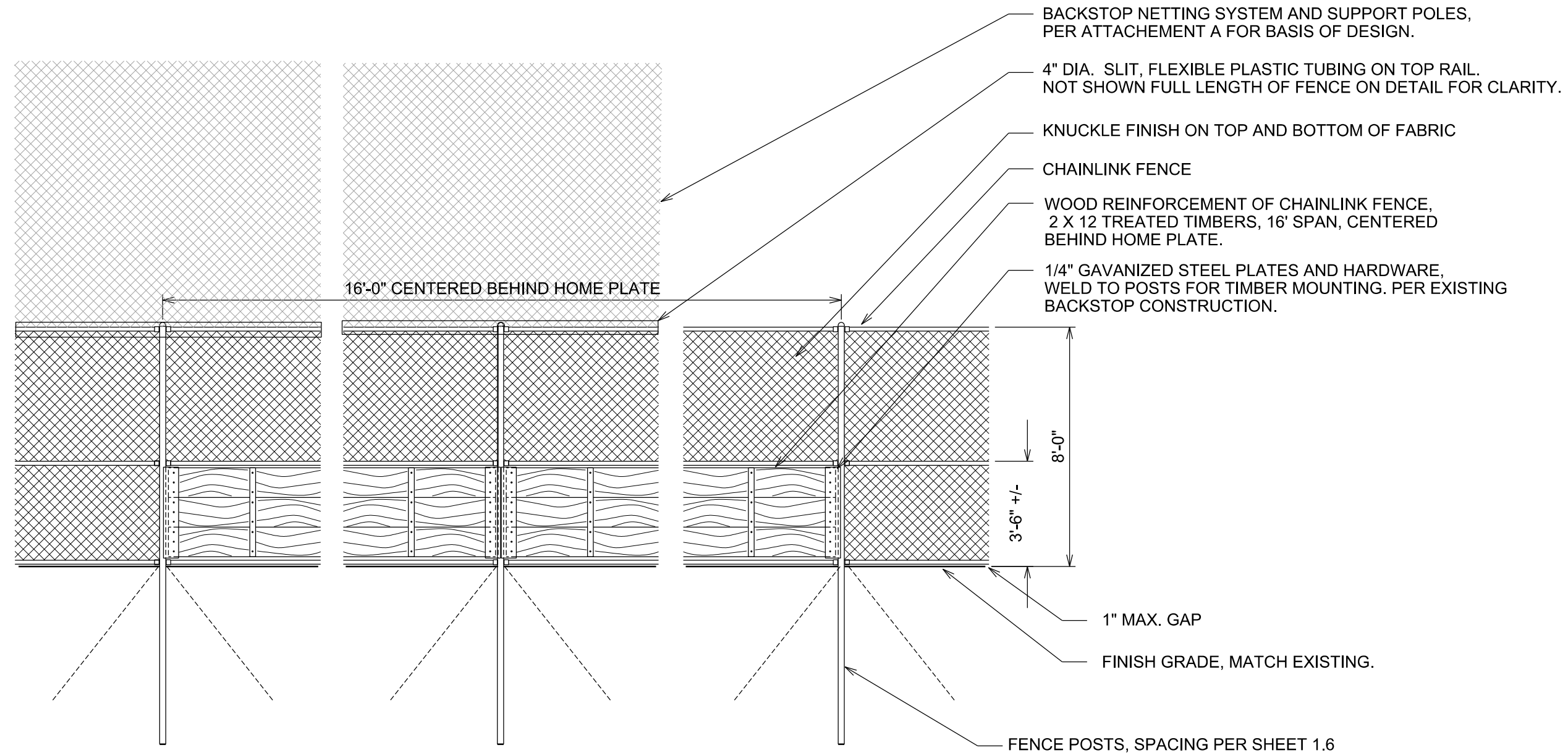

NOTES:

1. ALL FENCE HARDWARE SHALL BE GALVANIZED FINISH.
2. FENCE POSTS SHALL BE 2-1/2" O.D. SCHEDULE 40 PIPE, 10'-0" NOMINAL SPACING.
3. FENCE RAILS SHALL BE 1-5/8" O.D. SCHEDULE 40 PIPE.
4. STRETCHER BARS SHALL BE 1/4" X 3/4" WITH 1"X1/8" STRETCHER BANDS, 10" O.C. MAX.
5. FABRIC TIES SHALL BE #9 GAUGE WIRE, 12" O.C. MAX.
6. FENCE FABRIC SHALL BE 9 GAGE ALUMINUM COATED CHAIN LINE.
7. ALL POSTS SHALL BE DRIVEN TO A MINIMUM DEPTH OF 6 FT.
8. ALL POSTS TO HAVE ANCHORS ATTCHED AT 45 DEG. UNDERGROUND.

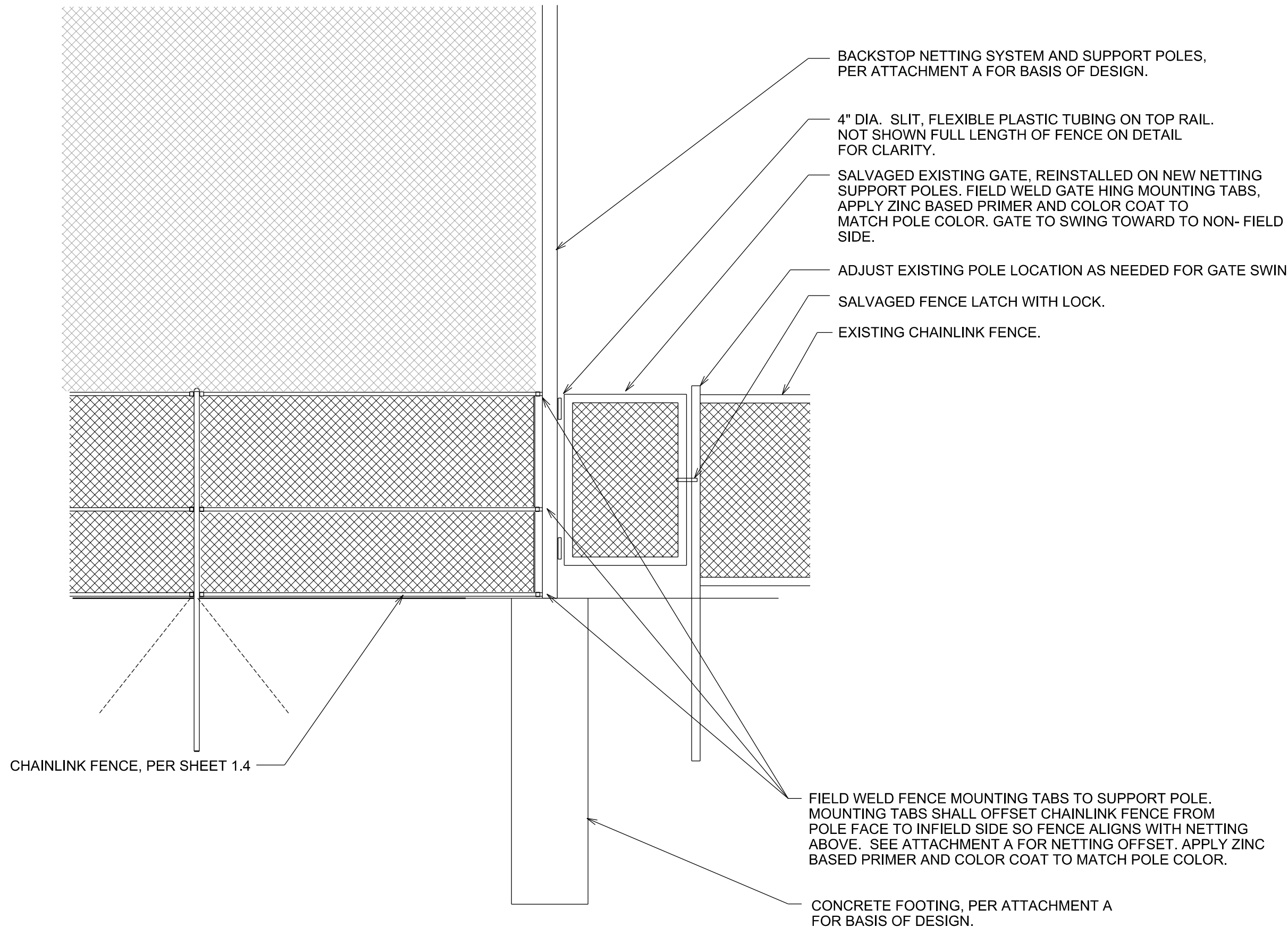

City of Madison  
Department of Public Works  
**PARKS DIVISION**

City-County Building, Suite 104  
210 Martin Luther King, Jr. Blvd.  
PO Box 2987  
Madison, WI 53701-2987

*play*  
**MADISON  
PARKS**

PROJECT:  
**BOWMAN BASEBALL  
BACKSTOP  
REPLACEMENT**

**DUANE F. BOWMAN PARK  
1801 FISH HATCHERY RD.  
MADISON, WI 53713**

Although every effort has been made in preparing these plans and checking them for accuracy, the contractor and subcontractors must check all details and dimensions of their trade and be responsible for the same.

ITEM	DATE
Drawn by:	xx-xx-xxxx
Approved by:	xx-xx-xxxx

PUBLIC WORKS PROJECT #:  
**7841**

SHEET TITLE:  
**CHAINLINK FENCE  
DETAILS**

SHEET NUMBER:  
**1.5**

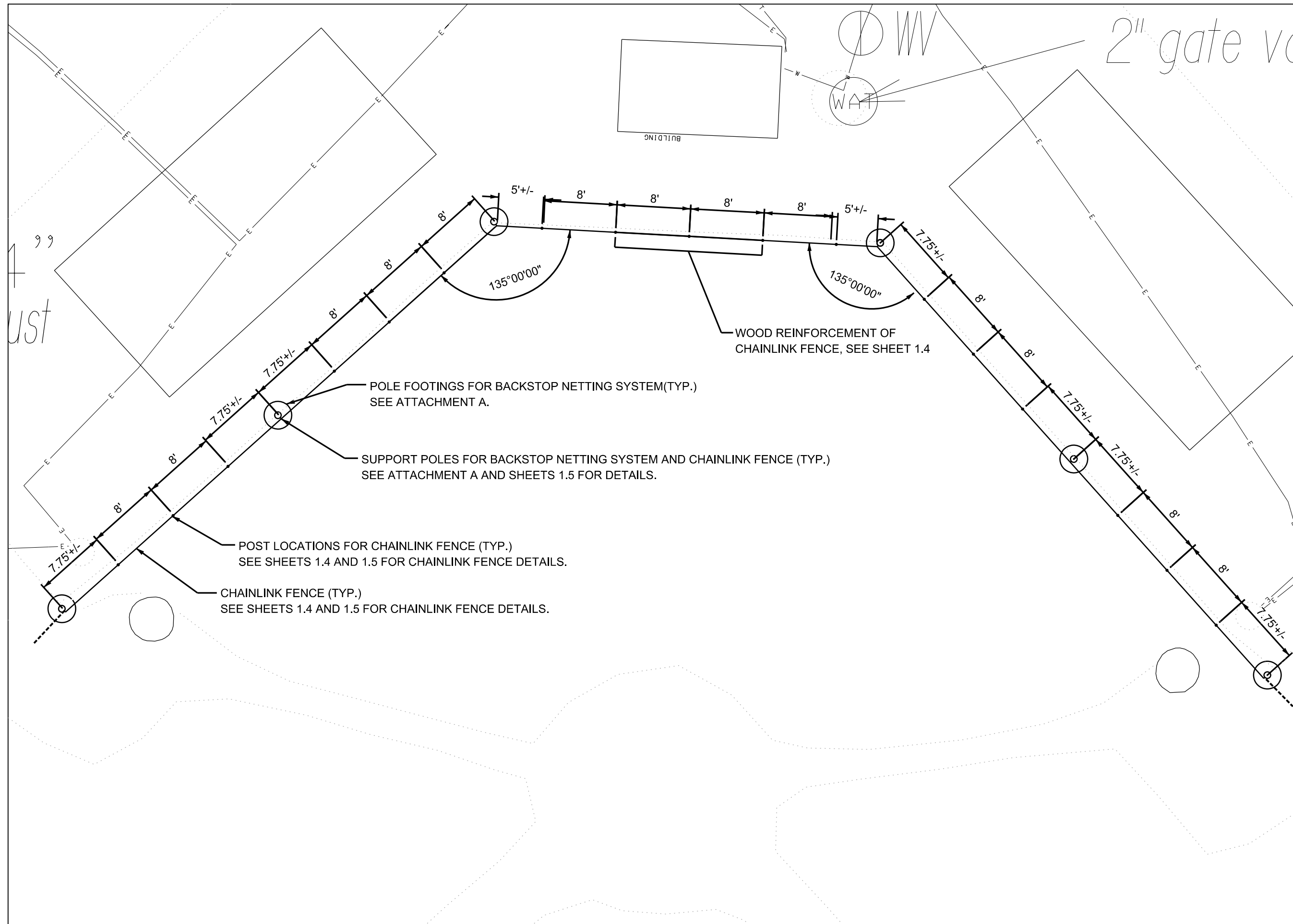

City of Madison  
 Department of Public Works  
**PARKS DIVISION**

City-County Building, Suite 104  
 210 Martin Luther King, Jr. Blvd.  
 PO Box 2987  
 Madison, WI 53701-2987

*play*  
**MADISON  
 PARKS**

Graphical Scale

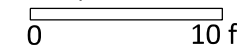

PROJECT:  
**BOWMAN BASEBALL  
 BACKSTOP  
 REPLACEMENT**

**DUANE F. BOWMAN PARK  
 1801 FISH HATCHERY RD.  
 MADISON, WI 53713**

Although every effort has been made in preparing these plans and checking them for accuracy, the contractor and subcontractors must check all details and dimensions of their trade and be responsible for the same.

ITEM	DATE
Drawn by:	xx-xx-xxxx
Approved by:	xx-xx-xxxx

PUBLIC WORKS PROJECT #:  
**7841**

SHEET TITLE:  
**CHAINLINK FENCE  
 LAYOUT**

SHEET NUMBER:  
**1.6**