

Madison, Wisconsin

CITY OF MADISON

CITY ENGINEERING DIVISION

DEPARTMENT OF PUBLIC WORKS

PLAN OF PROPOSED IMPROVEMENT

INDEX OF SHEETS

SHEET NO. D1	STANDARD NOTES
SHEET NO. D2	TYPICAL SECTION
SHEET NO. P1	PLAN & PROFILE
SHEET NO. U1-U2	UTILITY PLAN
SHEET NO. X1	CROSS SECTIONS
NO MAINTENANCE PLAN REQUIRED	

133 W WILSON ST

CITY PROJECT NO. 14619
CONTRACT NO. 9305

PROJECT LOCATION

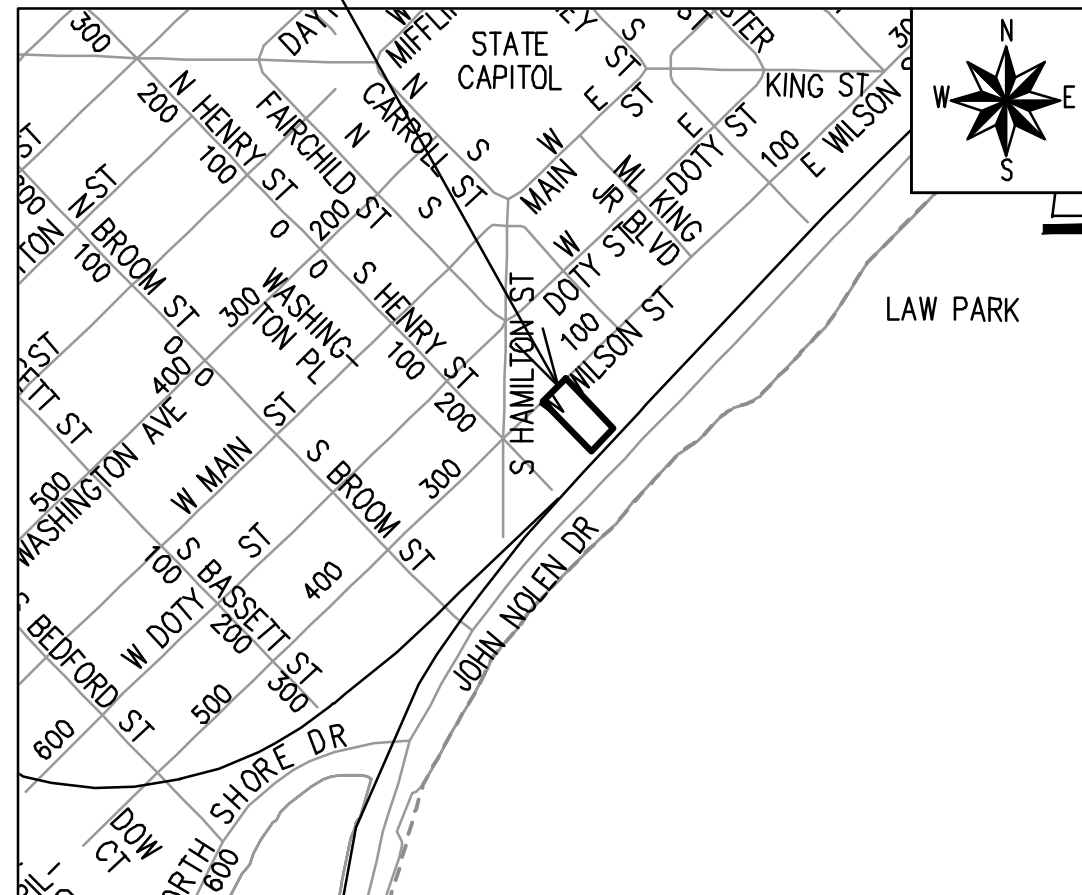

PUBLIC IMPROVEMENT PROJECT APPROVED

MAY 16, 2023

BY THE COMMON COUNCIL OF MADISON, WISCONSIN

PUBLIC IMPROVEMENT DESIGN APPROVED BY:

Sep 4, 2024

City Engineer

Date

STREET DESIGNED BY:



Sep 4, 2024

STORM & SANITARY SEWER DESIGNED BY:

LATERALS ONLY

WATER DESIGNED BY:

LATERALS ONLY

PLOT SCALE: 1" = 30'

PLOT NAME: 11

REV. DATE: 7/25/2024 9:33 AM

ORIGINATOR: CITY OF MADISON

THE LOCATION AND INFORMATION FOR PROPOSED NEW TREES, IN THE PUBLIC RIGHT OF WAY OR ON PUBLIC LANDS ARE APPROXIMATE AND ARE SHOWN FOR REFERENCE ONLY. THE LOCATIONS, SPECIFICATIONS AND PLANTING METHODS OF ALL PROPOSED NEW OR REPLACEMENT TREES IN THE PUBLIC RIGHT OF WAY OR ON PUBLIC LANDS SHALL BE APPROVED BY THE CITY FORESTER PRIOR TO INSTALLATION.

NO TREES IN THE RIGHT OF WAY OR ON PUBLIC LANDS SHALL BE TRIMMED, PRUNED, REMOVED OR ADVERSELY AFFECTED IN ANY WAY UNTIL THE DEVELOPER HAS RECEIVED WRITTEN PERMISSION FROM THE CITY ENGINEER OR CITY FORESTER. SAID WRITTEN PERMISSION SHALL INCLUDE LANGUAGE INDICATING THAT SECTION 10.101 OF THE MADISON GENERAL ORDINANCES AND ADMINISTRATIVE PROCEDURE MEMORANDUM NO. 6-2, REFERRING TO NOTIFICATION OF PROPERTY OCCUPANTS AND/OR OWNERS, HAS BEEN COMPLIED WITH.

DEVELOPER MUST SUBMIT A TRAFFIC CONTROL PLAN TO CITY TRAFFIC ENGINEERING AT LEAST 14 DAYS PRIOR TO THE START OF WORK. WORK SHALL NOT PROCEED UNTIL AN APPROVED TRAFFIC CONTROL PLAN IS IN PLACE.

CONTACT THE PROJECT ENGINEER AND DESIGNER, GRECIA IZQUIERDO, AT GIZQUIERDO@CITYOFMADISON.COM FOR CAD FILES AND ALIGNMENT DATA PRIOR TO STAKING.

UNDERDRAINS SHALL BE INSTALLED PER STANDARD DETAIL DRAWING 4.05 FOR 75' ON EACH SIDE OF THE LOW POINT, OR TO THE NEAREST CURB HIGH POINT. ALL UNDERDRAIN SHALL BE WRAPPED.

ALL GUTTERS SHALL DRAIN WITH A MINIMUM GRADE OF 0.5% TOWARD STORM SEWER INLETS.

ALL DITCHES SHALL DRAIN WITH A MINIMUM GRADE OF 0.5%

THE CROSS SLOPE OF SIDEWALKS AND BARRIER FREE SIDEWALK CURB RAMPS SHALL TYPICALLY BE 1.5%. THE LONGITUDINAL GRADE OF BARRIER FREE SIDEWALK CURB RAMPS SHALL NOT EXCEED 8.33%. ALL SIDEWALK RAMPS SHALL BE CONSTRUCTED ACCORDING TO S.D.D. 3.04. AT ALL OTHER LOCATIONS THE LONGITUDINAL GRADE OF SIDEWALKS SHALL NOT EXCEED 5.0 % OR THE ADJACENT STREET GRADE WHICHEVER IS GREATER NOR BE LESS THAN 0.5% AND SHALL DRAIN TOWARD STORM SEWER INLETS. SIDE SLOPES WITHIN TEN FEET OF A PUBLIC SIDEWALK SHALL NOT EXCEED 4:1. ALL SIDEWALK AND SIDEWALK RAMP ELEVATIONS AND GRADES SHALL BE FIELD VERIFIED AND SET TO COMPLY WITH THE CITY OF MADISON STANDARD SPECIFICATIONS AND THE A.D.A. GUIDELINES.

OBTAIN A PRINT OUT OF THE ALIGNMENTS FROM THE CITY PROJECT ENGINEER PRIOR TO STAKING THIS PROJECT. THE CITY PROJECT ENGINEER IS GRECIA IZQUIERDO, EMAIL: GIZQUIERDO@CITYOFMADISON.COM

CURB STATION AND OFFSETS SHALL BE TO THE EDGE OF PAVEMENT UNLESS OTHERWISE INDICATED. CURB ELEVATIONS SHALL BE TO THE EDGE OF PAVEMENT UNLESS OTHERWISE INDICATED.

POWER POLES AND OTHER OBSTRUCTIONS SHALL BE MOVED TO PROVIDE 2 FEET MINIMUM OF CLEAR DISTANCE FROM ANY FACE OF CURB OR EDGE OF SIDEWALK UNLESS OTHERWISE INDICATED ON THE PLANS.

ANY INFORMATION SHOWN ON THIS PLAN, WHICH IS NOT PART OF THIS RIGHT-OF-WAY PROJECT, IS PRELIMINARY AND NOT FOR CONSTRUCTION.

THERE MAY BE EXISTING UTILITIES OR OTHER FEATURES WHICH ARE EITHER NOT SHOWN OR SHOWN INCORRECTLY ON THIS PLAN. IT IS THE RESPONSIBILITY OF THE DEVELOPER TO LOCATE AND IDENTIFY ALL UTILITIES AND TOPOGRAPHY WHICH MAY AFFECT THE CONSTRUCTION OF THESE IMPROVEMENTS.

ALL PERMANENT SIGNING AND POSTING WILL BE DETERMINED AND PROVIDED BY THE TRAFFIC ENGINEERING DIVISION, FOLLOWING CONSTRUCTION OF THESE IMPROVEMENTS.

THE DEVELOPER SHALL PROVIDE, INSTALL AND MAINTAIN ALL STREET END BARRICADES, SIGNING AND TRAFFIC CONTROL, AS REQUIRED BY THE CITY TRAFFIC ENGINEER.

PAVEMENT SAWCUTS SHALL BE AS DIRECTED BY THE CITY CONSTRUCTION ENGINEER. SAWCUTS SHOWN ON THE PLAN ARE APPROXIMATE.



CURB ON CUL DE SACS SHALL BE INSTALLED ACCORDING TO S.D.D 3.05.

ALL WORK IN THE RIGHT OF WAY AND PUBLIC EASEMENTS SHALL BE IN ACCORDANCE WITH THE CITY OF MADISON STANDARD SPECIFICATIONS FOR PUBLIC WORKS CONSTRUCTION LATEST EDITION.

ALL PROPOSED IMPROVEMENTS IN THE RIGHT-OF-WAY ARE BASED ON SURVEY DATA PROVIDED BY THE DEVELOPER OR ITS CONSULTANT. IN THE CASE THAT THE PROPOSED IMPROVEMENTS CAN NOT BE INSTALLED PER THESE PLANS OR THE CITY OF MADISON STANDARD SPECIFICATION FOR PUBLIC WORKS CONSTRUCTION, LATEST EDITION, THE DEVELOPER SHALL BE RESPONSIBLE FOR THE COST OF EXTRA WORK DUE TO INACCURACIES OF THE SURVEY.

ALL UTILITY VERIFICATIONS AND ACCURACY OF THE DRAWINGS ARE THE RESPONSIBILITY OF THE DEVELOPER. ANY CONFLICTS THAT ARISE FROM MISSING OR ERRONEOUS INFORMATION WILL BE AT THE EXPENSE OF THE DEVELOPER. NO PRECAST STRUCTURES WILL BE APPROVED FOR STORM OR SANITARY SEWER UNTIL ALL POTENTIAL UTILITY CONFLICTS ARE RESOLVED.

IN LOCATIONS WHERE PAVEMENT RESTORATION IS NOT IDENTIFIED ADJACENT TO CURB AND REPLACEMENT, IT IS ASSUMED THAT CURB AND GUTTER WILL BE REPLACED WITHOUT DAMAGING ADJACENT PAVEMENT. IF DAMAGED, THE PAVEMENT RESTORATION LIMITS SHALL BE EXTENDED BY THE CITY CONSTRUCTION ENGINEER AS NECESSARY TO MEET THE STANDARD PATCHING CRITERIA.

CONVENTIONAL SIGNS	
FIELD VERIFY ALL UTILITY LOCATIONS	
GAS	—— G ——
STORM SEWER	—— ST ——
SANITARY SEWER	—— SAN ——
WATER	—— W ——
BURIED ELECTRIC	—— E ——
OVERHEAD ELECTRIC	—— OH ——
POWER POLE	
ADA COMPLIANT RAMP W/ DETECTABLE WARNING FIELD	
COMBUSTIBLE FLUIDS	

DATE	BY
14619	D-1
DESIGNED BY: GCI	DATE: 8/16/2024 9:08 AM
MARK	REVISION

14619
MADISON, WI
9305
CONTRACT NO:

STANDARD NOTES
133 W WILSON ST
M:\DESIGN\Projects\14619\CAD\Streets\14619EN-Details.dwg



14619
D-1

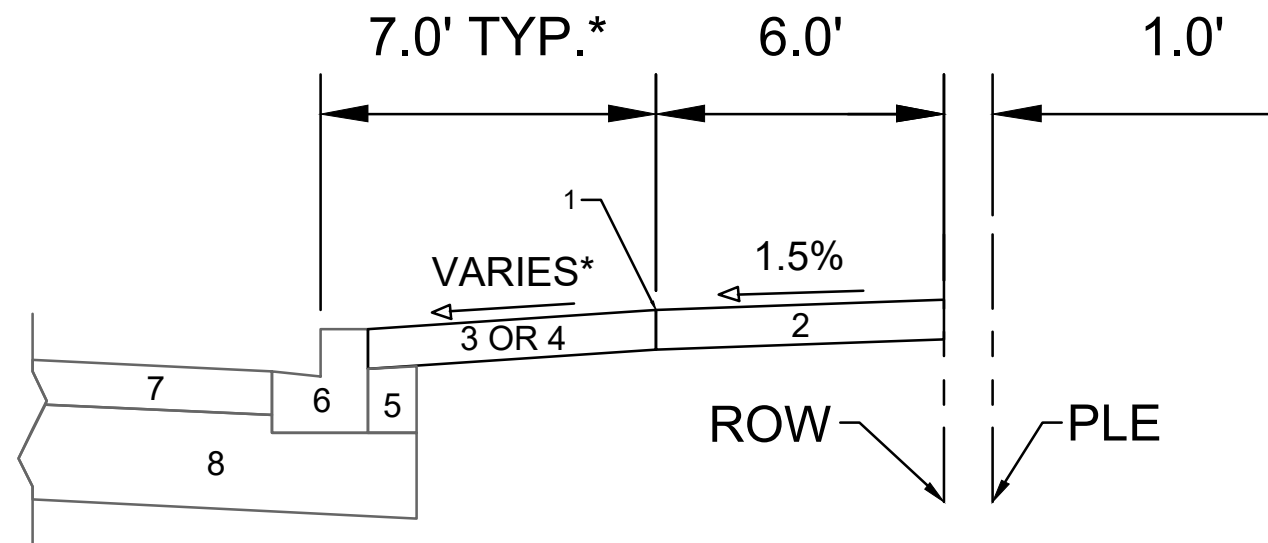

**TYPICAL SECTION
W WILSON ST**

- 1 POINT REFERRED TO ON PROFILE
- 2 5" CONCRETE SIDEWALK
- 3 5" COLORED CONCRETE TERRACE. COLOR SHALL BE 'NATURAL BARK' OR APPROVED EQUAL
- 4 PLANTING AREA TO BE PERFORMED BY DEVELOPER, SEE SHEET P-1 FOR SPECIFIC LOCATIONS
- 5 EXISTING FILL TO REMAIN, INSTALL AT CURB REPLACEMENT LOCATIONS
- 6 EXISTING CONCRETE CURB TYPE 'H', REPLACE AT LOCATIONS SHOWN IN SHEET P-1 OR AS DETERMINED BY CONSTRUCTION ENGINEER
- 7 EXISTING ASPHALTIC PAVEMENT TO REMAIN
- 8 EXISTING ROAD BASE TO REMAIN

SPECIAL NOTES:

* SEE X-SHEETS AND P-SHEETS FOR CROSS SECTIONS AND SLOPES

MARK	REVISION	DATE	BY
14619	08/16/2024 8:08 AM		

14619
MADISON, WI
9305
CONTRACT NO:

TYPICAL SECTION
133 W WILSON ST
M:\DESIGN\Projects\14619\CAD\Streets\14619EN-Details.dwg



14619
D-2

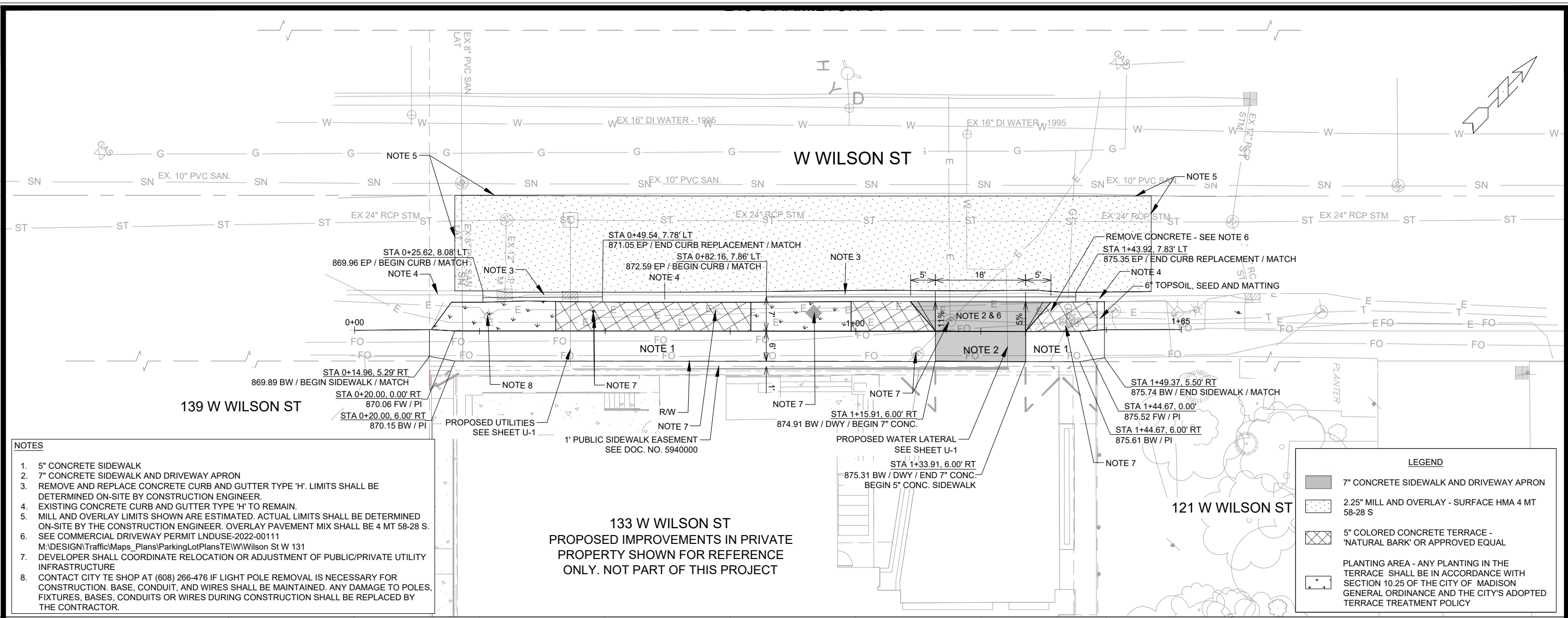

- NOTES**
- 5" CONCRETE SIDEWALK
 - 7" CONCRETE SIDEWALK AND DRIVEWAY APRON
 - REMOVE AND REPLACE CONCRETE CURB AND GUTTER TYPE 'H'. LIMITS SHALL BE DETERMINED ON-SITE BY CONSTRUCTION ENGINEER.
 - EXISTING CONCRETE CURB AND GUTTER TYPE 'H' TO REMAIN.
 - MILL AND OVERLAY LIMITS SHOWN ARE ESTIMATED. ACTUAL LIMITS SHALL BE DETERMINED ON-SITE BY THE CONSTRUCTION ENGINEER. OVERLAY PAVEMENT MIX SHALL BE 4 MT 58-28 S.
 - SEE COMMERCIAL DRIVEWAY PERMIT LNDUSE-2022-00111
M:\DESIGN\Traffic\Maps_Plans\ParkingLotPlans\TE\WWilson St W 131
 - DEVELOPER SHALL COORDINATE RELOCATION OR ADJUSTMENT OF PUBLIC/PRIVATE UTILITY INFRASTRUCTURE
 - CONTACT CITY TE SHOP AT (608) 266-476 IF LIGHT POLE REMOVAL IS NECESSARY FOR CONSTRUCTION. BASE, CONDUIT, AND WIRES SHALL BE MAINTAINED. ANY DAMAGE TO POLES, FIXTURES, BASES, CONDUITS OR WIRES DURING CONSTRUCTION SHALL BE REPLACED BY THE CONTRACTOR.

LEGEND

	7" CONCRETE SIDEWALK AND DRIVEWAY APRON
	2.25" MILL AND OVERLAY - SURFACE HMA 4 MT 58-28 S
	5" COLORED CONCRETE TERRACE - 'NATURAL BARK' OR APPROVED EQUAL
	PLANTING AREA - ANY PLANTING IN THE TERRACE SHALL BE IN ACCORDANCE WITH SECTION 10.25 OF THE CITY OF MADISON GENERAL ORDINANCE AND THE CITY'S ADOPTED TERRACE TREATMENT POLICY

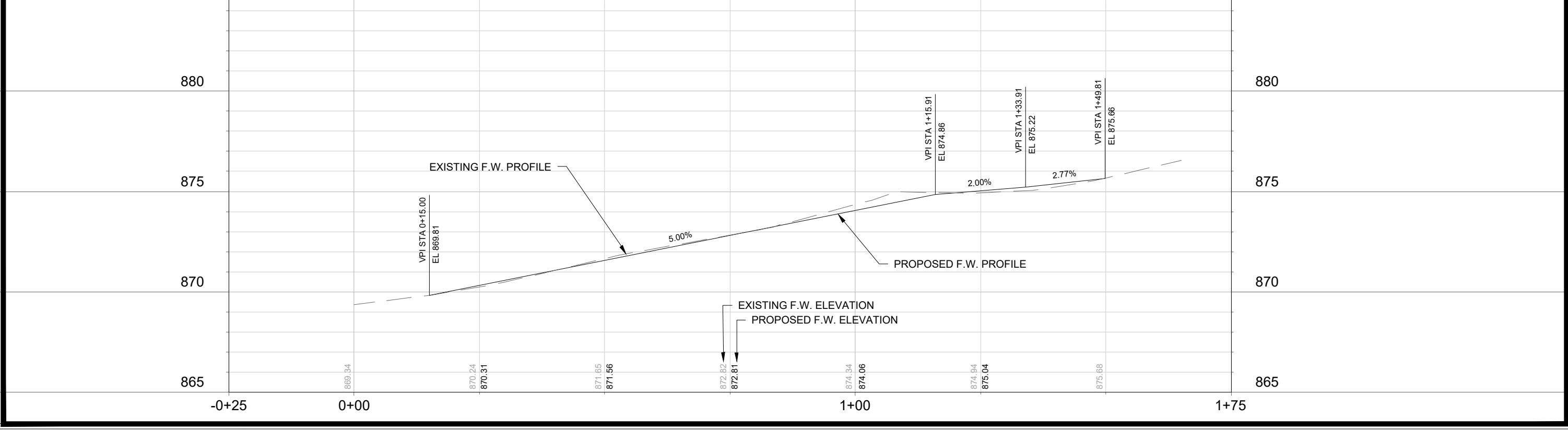

14619	MADISON, WI	9305	CONTRACT NO.:
14619 P-1			

PLAN & PROFILE - W WILSON ST
 133 W WILSON ST
 M:\DESIGN\Projects\14619\CAD\Streets\14619EN-PnP.dwg

14619
 MADISON, WI
 9305
 CONTRACT NO.:

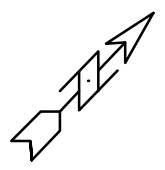
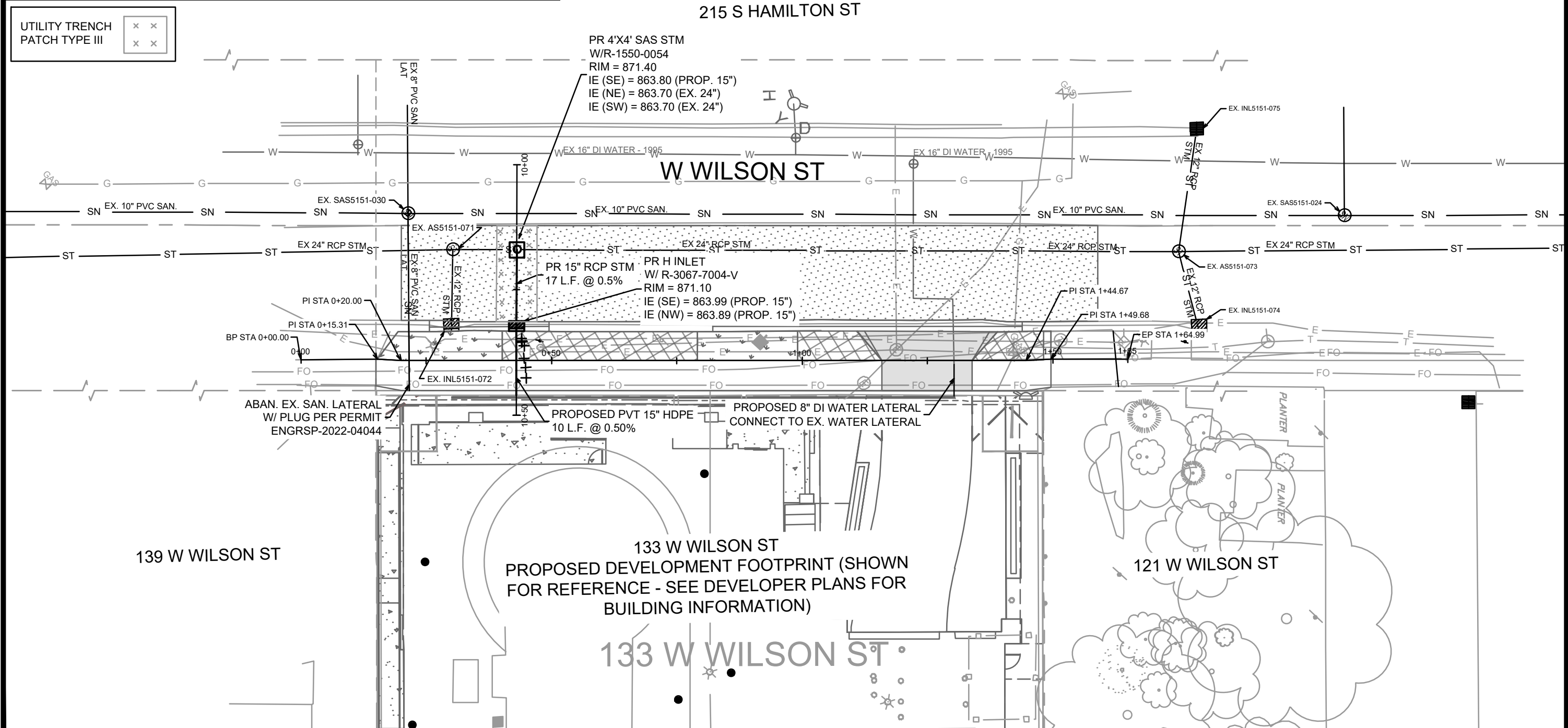
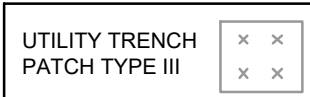
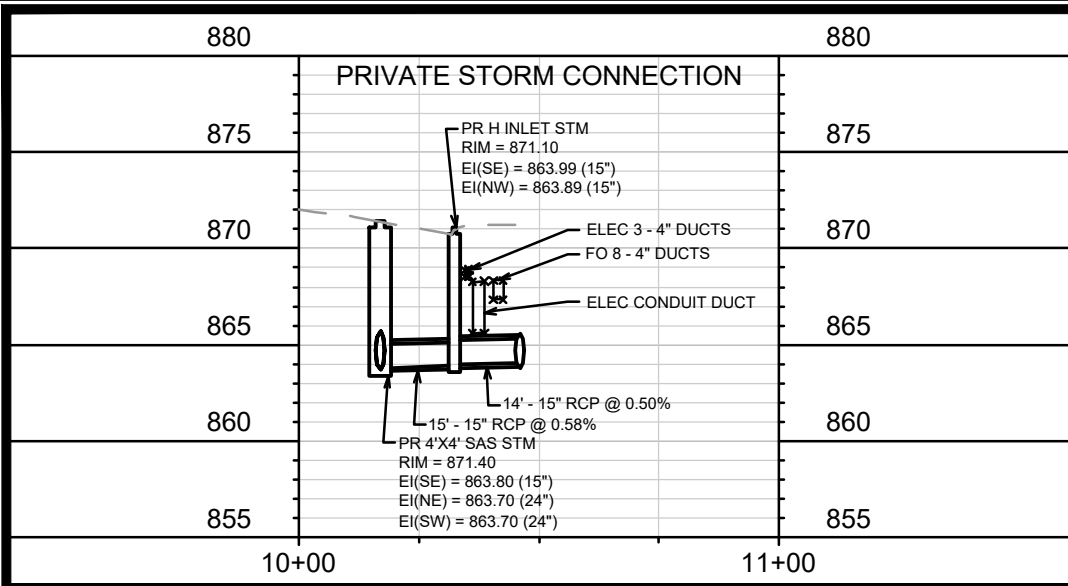

DATE	U-1
REVISION	
MARK	14619
DESIGNED BY	GCIT
DATE	09/28/2024 10:03 AM
SCALE	1:20

14619
MADISON, WI
9305
CONTRACT NO:

UTILITY PLAN & PROFILE - W WILSON ST
133 W WILSON ST

M:\DESIGN\Projects\14619\CAD\Drawings\14619SWR-PnP.dwg

14619
U-1

MARK	REVISION	DATE	BY
14619			
Designated By: GCIT	Date: 07/28/2024	10:03 AM	Scale: 1:20
			U-2

14619
MADISON, WI
9305
CONTRACT NO:

UTILITY PLAN - W WILSON ST
133 W WILSON ST
M:\DESIGN\Projects\14619\CAD\Sewers\14619SWR-PnP.dwg



14619
U-2

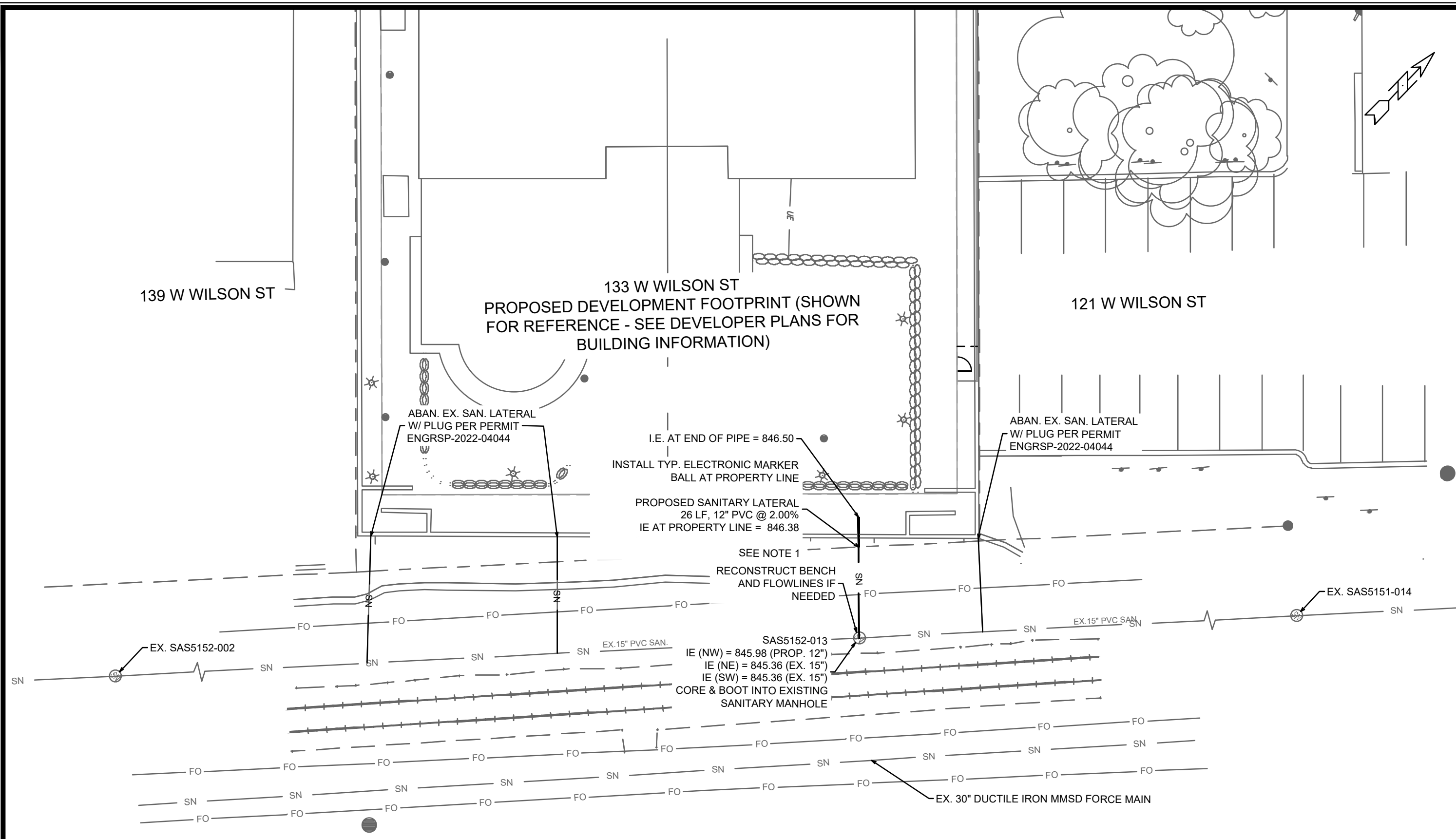

NOTE:
1. A RAILROAD PERMIT FROM WISDOT AND WISCONSIN & SOUTHERN INC. (WSOR) IS REQUIRED PRIOR TO DOING ANY WORK WITHIN THE RAILROAD RIGHT OF WAY

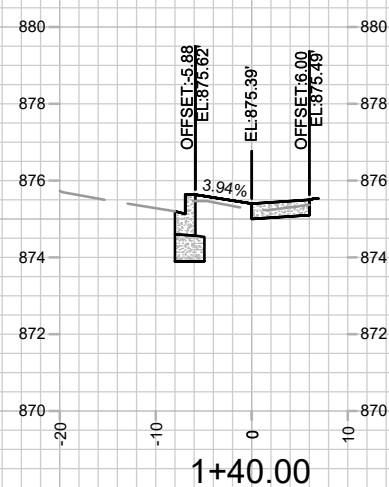
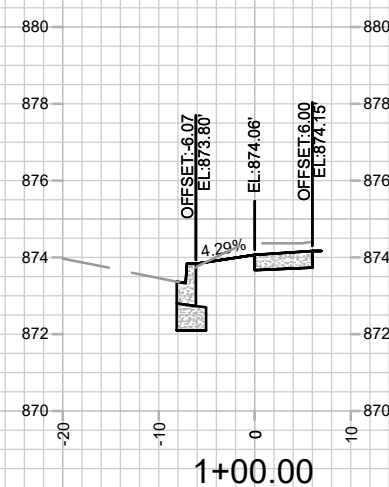
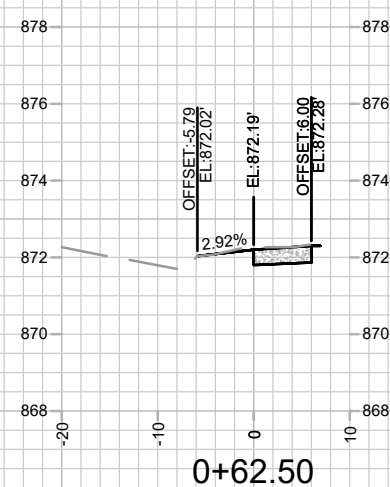
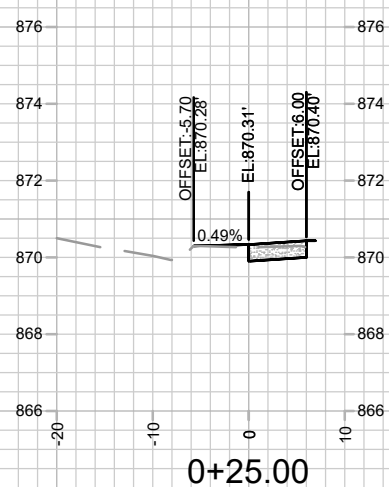
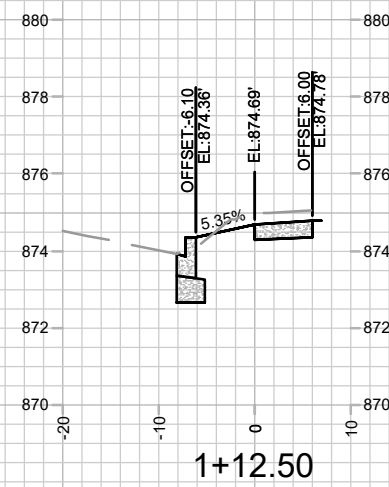
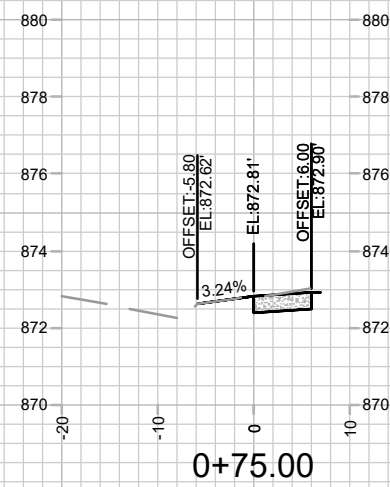
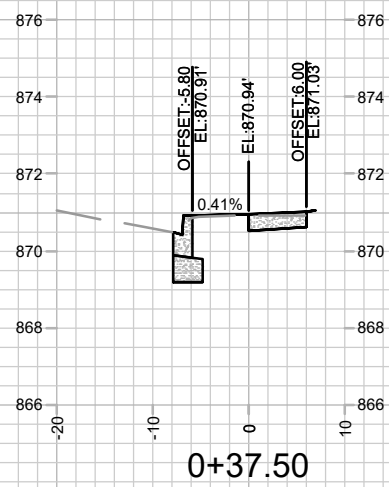
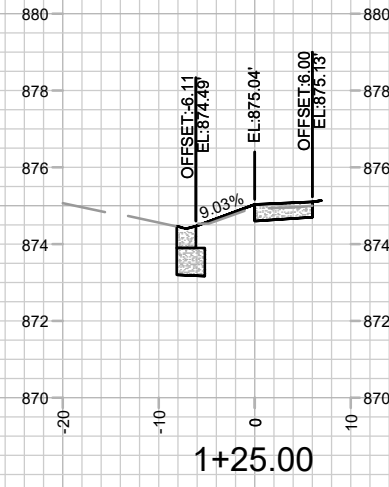
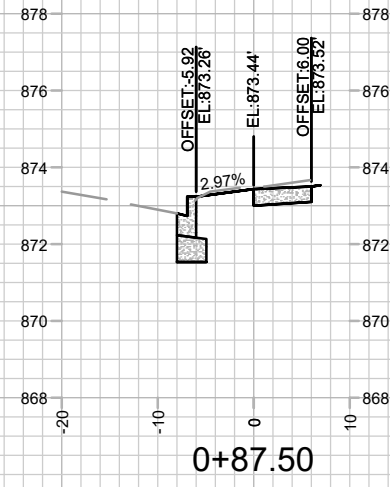
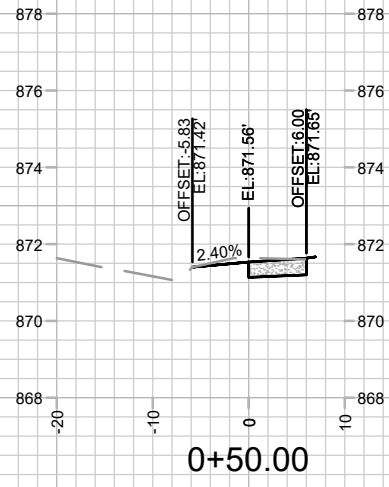

MARK	REVISION	DATE	BY
---	---	---	---
---	---	---	---
---	---	---	---
---	---	---	---

14619
MADISON, WI
9305
CONTRACT NO:

14619
MADISON, WI
9305
CONTRACT NO:

CROSS SECTIONS - W WILSON ST
133 W WILSON ST
M:\DESIGN\Projects\14619\CAD\Streets\14619EN-Xsections.dwg



14619
X-1