



Madison, Wisconsin

CITY OF MADISON

CITY ENGINEERING DIVISION

DEPARTMENT OF PUBLIC WORKS

PLAN OF PROPOSED IMPROVEMENT

INDEX OF SHEETS

SHEET NO. D1	STANDARD NOTES
SHEET NO. D2	TYPICAL SECTIONS
SHEET NO. D3-D4	DETAIL - TERRACE SUPPORT SYSTEMS
SHEET NO. P1	PLAN & PROFILE
SHEET NO. E1	ELECTRICAL PLANS
SHEET NO. PM1-PM2	MARKING PLANS
SHEET NO. L1	LANDSCAPING PLAN
SHEET NO. X1-X2	CROSS SECTIONS

NO MAINTENANCE PLAN REQUIRED

415 N LAKE ST - STATE STREET

CAMPUS GARAGE MIXED USE

CITY PROJECT NO. 14892
CONTRACT NO. 9360

PROJECT
LOCATION



PUBLIC IMPROVEMENT PROJECT
APPROVED

OCTOBER 17, 2023

BY THE COMMON COUNCIL
OF MADISON, WISCONSIN

PUBLIC IMPROVEMENT DESIGN
APPROVED BY:

Jan 28, 2025

City Engineer

Date

STREET
DESIGNED BY:



Jan 28, 2025

ELECTRICAL
DESIGNED BY:

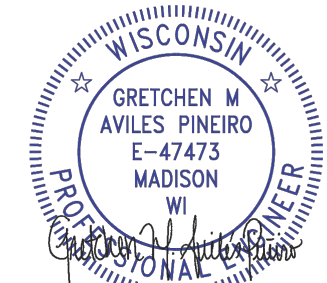

Jan 28, 2025

PAVEMENT MARKINGS
DESIGNED BY:

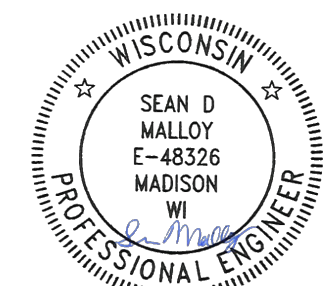

Jan 28, 2025

PLOT SCALE: 1 IN = 11.1 XREF

PLOT NAME: 11

REV. DATE: 1/28/2025 7:19 AM

ORIGINATOR: CITY_OF_MADISON

THE LOCATION AND INFORMATION FOR PROPOSED NEW TREES, IN THE PUBLIC RIGHT OF WAY OR ON PUBLIC LANDS ARE APPROXIMATE AND ARE SHOWN FOR REFERENCE ONLY. THE LOCATIONS, SPECIFICATIONS AND PLANTING METHODS OF ALL PROPOSED NEW OR REPLACEMENT TREES IN THE PUBLIC RIGHT OF WAY OR ON PUBLIC LANDS SHALL BE APPROVED BY THE CITY FORESTER PRIOR TO INSTALLATION.

NO TREES IN THE RIGHT OF WAY OR ON PUBLIC LANDS SHALL BE TRIMMED, PRUNED, REMOVED OR ADVERSELY AFFECTED IN ANY WAY UNTIL THE DEVELOPER HAS RECEIVED WRITTEN PERMISSION FROM THE CITY ENGINEER OR CITY FORESTER. SAID WRITTEN PERMISSION SHALL INCLUDE LANGUAGE INDICATING THAT SECTION 10.101 OF THE MADISON GENERAL ORDINANCES AND ADMINISTRATIVE PROCEDURE MEMORANDUM NO. 6-2, REFERRING TO NOTIFICATION OF PROPERTY OCCUPANTS AND/OR OWNERS, HAS BEEN COMPLIED WITH.

DEVELOPER MUST SUBMIT A TRAFFIC CONTROL PLAN TO CITY TRAFFIC ENGINEERING AT LEAST 14 DAYS PRIOR TO THE START OF WORK. WORK SHALL NOT PROCEED UNTIL AN APPROVED TRAFFIC CONTROL PLAN IS IN PLACE.

CONTACT THE PROJECT ENGINEER AND DESIGNER, GRECIA IZQUIERDO TORRES, AT GIZQUIERDO@CITYOFMADISON.COM FOR CAD FILES AND ALIGNMENT DATA PRIOR TO STAKING.

CONVENTIONAL SIGNS	
FIELD VERIFY ALL UTILITY LOCATIONS	
GAS	—— G ——
STORM SEWER	—— ST ——
SANITARY SEWER	—— SAN ——
WATER	—— W ——
BURIED ELECTRIC	—— E ——
OVERHEAD ELECTRIC	—— OH ——
POWER POLE	
ADA COMPLIANT RAMP W/ DETECTABLE WARNING FIELD	
COMBUSTIBLE FLUIDS	

UNDERDRAINS SHALL BE INSTALLED PER STANDARD DETAIL DRAWING 4.05 FOR 75' ON EACH SIDE OF THE LOW POINT, OR TO THE NEAREST CURB HIGH POINT. ALL UNDERDRAIN SHALL BE WRAPPED.

ALL GUTTERS SHALL DRAIN WITH A MINIMUM GRADE OF 0.5% TOWARD STORM SEWER INLETS.

ALL DITCHES SHALL DRAIN WITH A MINIMUM GRADE OF 0.5%

THE CROSS SLOPE OF SIDEWALKS AND BARRIER FREE SIDEWALK CURB RAMPS SHALL TYPICALLY BE 1.5%. THE LONGITUDINAL GRADE OF BARRIER FREE SIDEWALK CURB RAMPS SHALL NOT EXCEED 8.33%. ALL SIDEWALK RAMPS SHALL BE CONSTRUCTED ACCORDING TO S.D.D. 3.04. AT ALL OTHER LOCATIONS THE LONGITUDINAL GRADE OF SIDEWALKS SHALL NOT EXCEED 5.0 % OR THE ADJACENT STREET GRADE WHICHEVER IS GREATER NOR BE LESS THAN 0.5% AND SHALL DRAIN TOWARD STORM SEWER INLETS. SIDE SLOPES WITHIN TEN FEET OF A PUBLIC SIDEWALK SHALL NOT EXCEED 4:1. ALL SIDEWALK AND SIDEWALK RAMP ELEVATIONS AND GRADES SHALL BE FIELD VERIFIED AND SET TO COMPLY WITH THE CITY OF MADISON STANDARD SPECIFICATIONS AND THE A.D.A. GUIDELINES.

OBTAIN A PRINT OUT OF THE ALIGNMENTS FROM THE CITY PROJECT ENGINEER PRIOR TO STAKING THIS PROJECT. THE CITY PROJECT ENGINEER IS GRECIA IZQUIERDO TORRES, EMAIL: GIZQUIERDO@CITYOFMADISON.COM

CURB STATION AND OFFSETS SHALL BE TO THE EDGE OF PAVEMENT UNLESS OTHERWISE INDICATED. CURB ELEVATIONS SHALL BE TO THE EDGE OF PAVEMENT UNLESS OTHERWISE INDICATED.

POWER POLES AND OTHER OBSTRUCTIONS SHALL BE MOVED TO PROVIDE 2 FEET MINIMUM OF CLEAR DISTANCE FROM ANY FACE OF CURB OR EDGE OF SIDEWALK UNLESS OTHERWISE INDICATED ON THE PLANS.

ANY INFORMATION SHOWN ON THIS PLAN, WHICH IS NOT PART OF THIS RIGHT-OF-WAY PROJECT, IS PRELIMINARY AND NOT FOR CONSTRUCTION.

THERE MAY BE EXISTING UTILITIES OR OTHER FEATURES WHICH ARE EITHER NOT SHOWN OR SHOWN INCORRECTLY ON THIS PLAN. IT IS THE RESPONSIBILITY OF THE DEVELOPER TO LOCATE AND IDENTIFY ALL UTILITIES AND TOPOGRAPHY WHICH MAY AFFECT THE CONSTRUCTION OF THESE IMPROVEMENTS.

ALL PERMANENT SIGNING AND POSTING WILL BE DETERMINED AND PROVIDED BY THE TRAFFIC ENGINEERING DIVISION, FOLLOWING CONSTRUCTION OF THESE IMPROVEMENTS.

THE DEVELOPER SHALL PROVIDE, INSTALL AND MAINTAIN ALL STREET END BARRICADES, SIGNING AND TRAFFIC CONTROL, AS REQUIRED BY THE CITY TRAFFIC ENGINEER.

PAVEMENT SAWCUTS SHALL BE AS DIRECTED BY THE CITY CONSTRUCTION ENGINEER. SAWCUTS SHOWN ON THE PLAN ARE APPROXIMATE.

CURB ON CUL DE SACS SHALL BE INSTALLED ACCORDING TO S.D.D 3.05.

ALL WORK IN THE RIGHT OF WAY AND PUBLIC EASEMENTS SHALL BE IN ACCORDANCE WITH THE CITY OF MADISON STANDARD SPECIFICATIONS FOR PUBLIC WORKS CONSTRUCTION LATEST EDITION.

ALL PROPOSED IMPROVEMENTS IN THE RIGHT-OF-WAY ARE BASED ON SURVEY DATA PROVIDED BY THE DEVELOPER OR ITS CONSULTANT. IN THE CASE THAT THE PROPOSED IMPROVEMENTS CAN NOT BE INSTALLED PER THESE PLANS OR THE CITY OF MADISON STANDARD SPECIFICATION FOR PUBLIC WORKS CONSTRUCTION, LATEST EDITION, THE DEVELOPER SHALL BE RESPONSIBLE FOR THE COST OF EXTRA WORK DUE TO INACCURACIES OF THE SURVEY.

ALL UTILITY VERIFICATIONS AND ACCURACY OF THE DRAWINGS ARE THE RESPONSIBILITY OF THE DEVELOPER. ANY CONFLICTS THAT ARISE FROM MISSING OR ERRONEOUS INFORMATION WILL BE AT THE EXPENSE OF THE DEVELOPER. NO PRECAST STRUCTURES WILL BE APPROVED FOR STORM OR SANITARY SEWER UNTIL ALL POTENTIAL UTILITY CONFLICTS ARE RESOLVED.

STANDARD NOTES	14892	MADISON, WI	9360	CONTRACT NO:
	415 N LAKE ST - STATE STREET CAMPUS GARAGE MIXED USE			
M:\DESIGN\Projects\14892\CAD\Streets\14892EN-Details.dwg				
14892				
D-1				

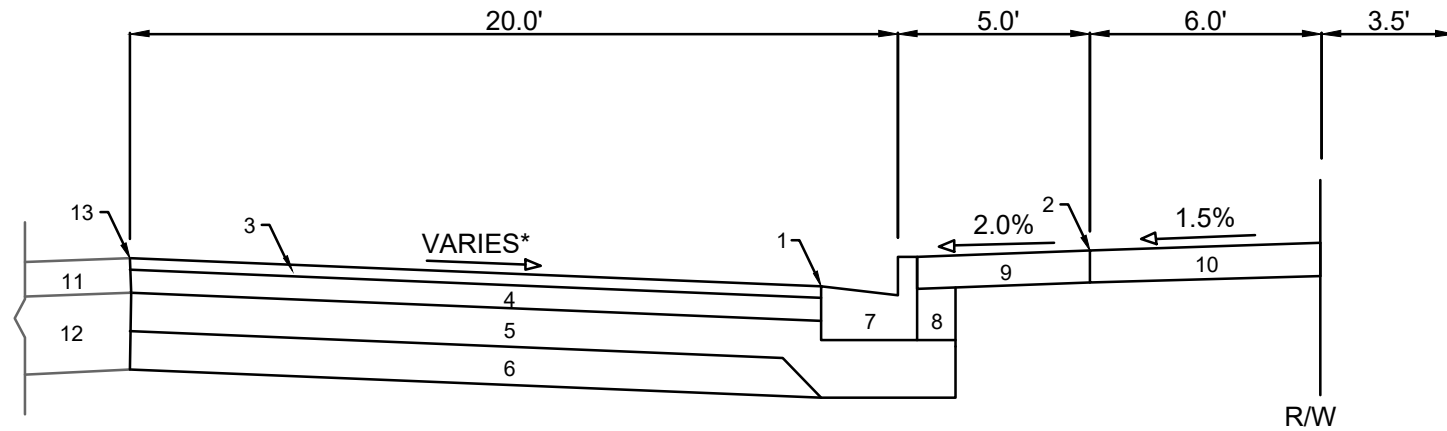

**TYPICAL SECTION
N LAKE ST
STA 0+81.21 TO STA 1+53.61**

PLE
SEE DOC NO. 5936596

- 1 POINT REFERRED TO ON PROFILE FOR EDGE OF PAVEMENT
- 2 POINT REFERRED TO ON PROFILE FOR FRONT OF SIDEWALK
- 3 2.00" H.M.A. PAVEMENT- TYPE 4 MT 58-28 S**
- 4 3.50" H.M.A. PAVEMENT- TYPE 3 MT 58-28 S**
- 5 6.00" CRUSHED AGGREGATE BASE COURSE GRADATION 2**
- 6 6.00" CRUSHED AGGREGATE BASE COURSE GRADATION 1**
- 7 CONCRETE CURB AND GUTTER TYPE 'A'.
- 8 FILL
- 9 5.00" CONCRETE TERRACE
- 10 5.00" CONCRETE SIDEWALK
- 11 EX. PAVEMENT TO REMAIN
- 12 EX. BASE COURSE TO REMAIN
- 13 PROPOSED SAWCUT LOCATION

SPECIAL NOTES:

- * SEE P & X SHEETS FOR CROSS SLOPES AND WIDTHS
- ** TO BE CONSTRUCTED UNDER CITY PROJECT NO. 14636. NOT PART OF THIS PROJECT

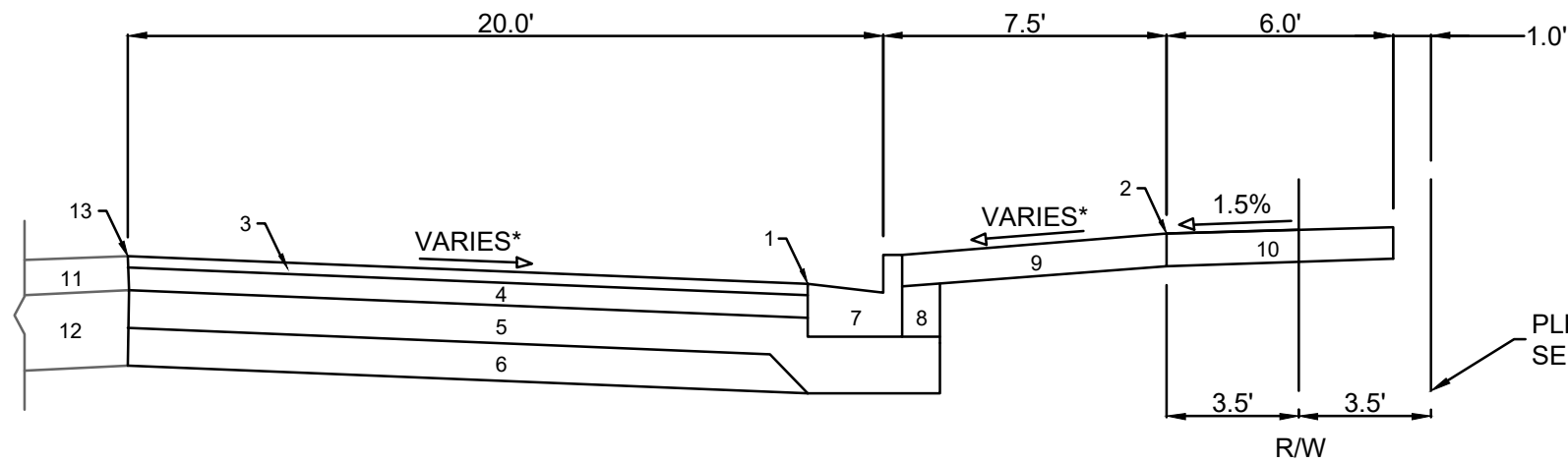

**TYPICAL SECTION
N LAKE ST
STA 0+45.23 TO STA 0+81.21
STA 1+53.61 TO STA 2+95.44**

PLE
SEE DOC NO. 5936596

- 1 POINT REFERRED TO ON PROFILE FOR EDGE OF PAVEMENT
- 2 POINT REFERRED TO ON PROFILE FOR FRONT OF SIDEWALK
- 3 2.00" H.M.A. PAVEMENT- TYPE 4 MT 58-28 S**
- 4 3.50" H.M.A. PAVEMENT- TYPE 3 MT 58-28 S**
- 5 6.00" CRUSHED AGGREGATE BASE COURSE GRADATION 2**
- 6 6.00" CRUSHED AGGREGATE BASE COURSE GRADATION 1**
- 7 CONCRETE CURB AND GUTTER TYPE 'A'.
- 8 FILL
- 9 5.00" CONCRETE TERRACE
- 10 5.00" CONCRETE SIDEWALK
- 11 EX. PAVEMENT TO REMAIN
- 12 EX. BASE COURSE TO REMAIN
- 13 PROPOSED SAWCUT LOCATION

SPECIAL NOTES:

- * SEE P & X SHEETS FOR CROSS SLOPES AND WIDTHS
- ** TO BE CONSTRUCTED UNDER CITY PROJECT NO. 14636. NOT PART OF THIS PROJECT

DATE	BY
1/28/2025	AM
REVISION	DATE
14892	14892
14892	14892

14892
MADISON, WI
9360
CONTRACT NO:

TYPICAL SECTION
415 N LAKE ST - STATE STREET CAMPUS GARAGE MIXED USE
M:\DESIGN\Projects\14892\CAD\Streets\14892EN-Details.dwg



14892
D-2

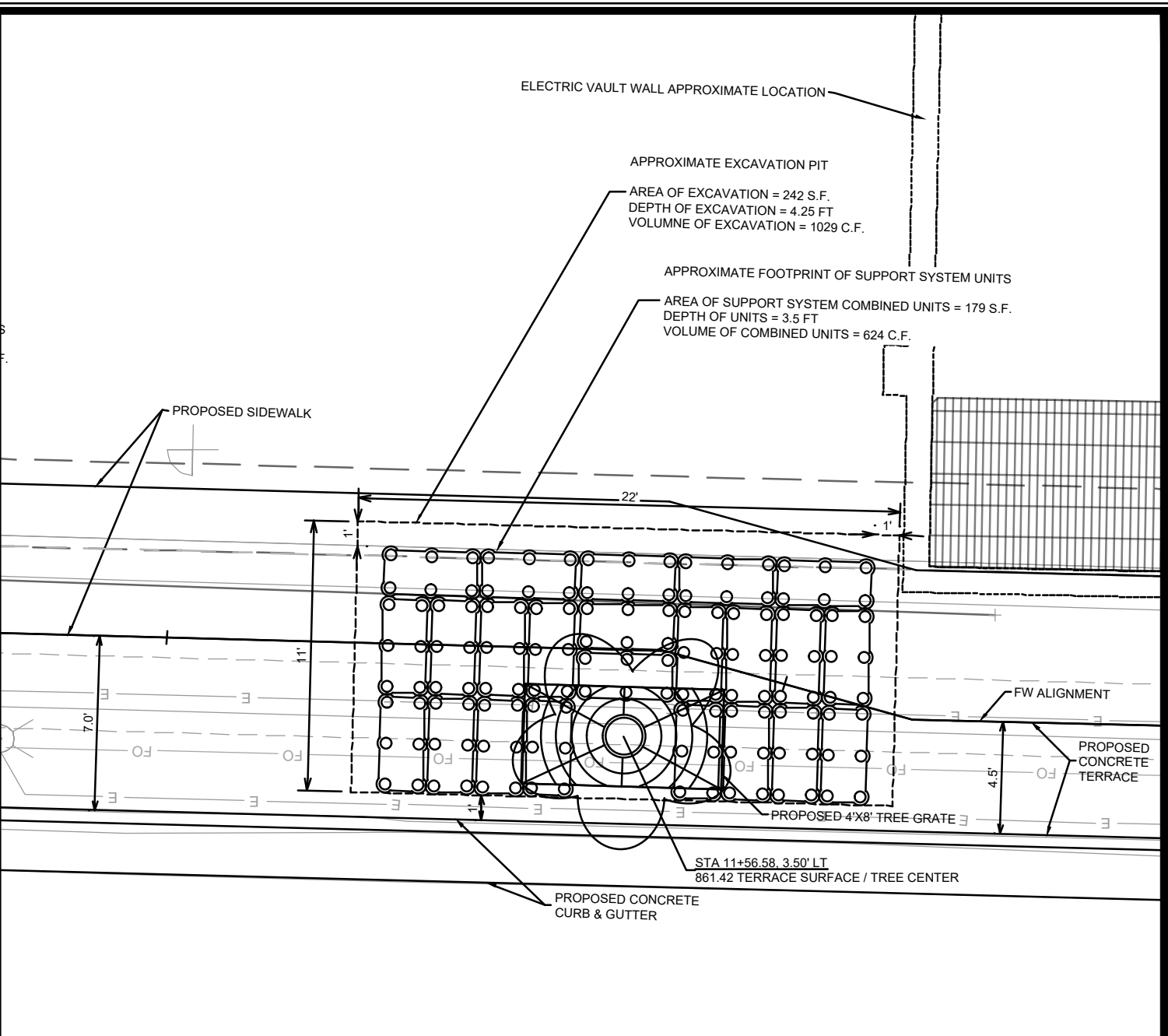
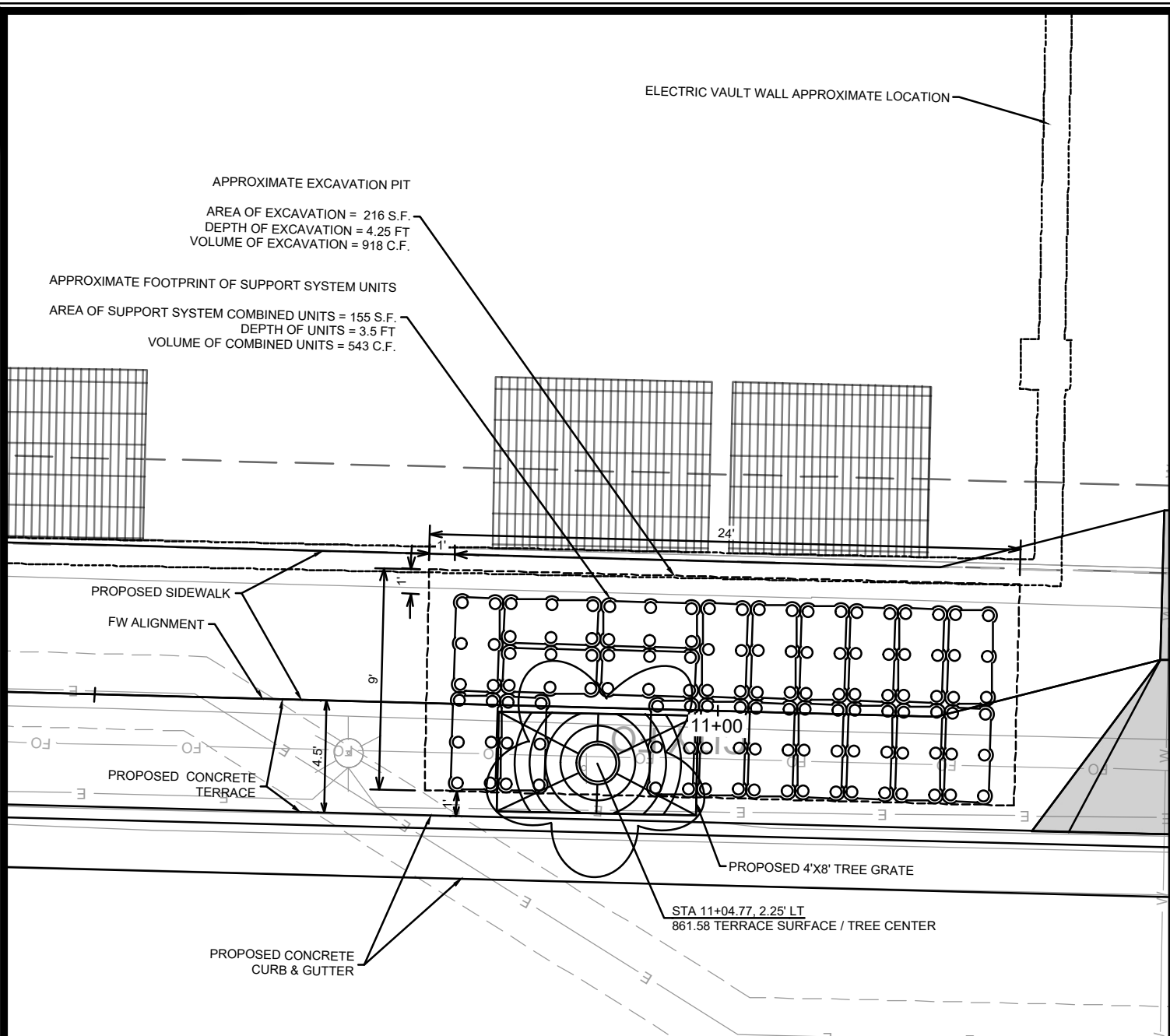

DETAIL TSS-1 TERRACE SUPPORT SYSTEM HORIZONTAL LAYOUT

DETAIL TSS-2 TERRACE SUPPORT SYSTEM HORIZONTAL LAYOUT

SPECIAL NOTES

1. TERRACE SUPPORT SYSTEM DIMENSIONS ARE BASED ON APPROVED BRAND, SILVA CELL BY DEEP ROOT. THE CONTRACTOR CAN INSTALL ANY OF THE APPROVED BRANDS AS DESCRIBED IN ARTICLE 214 OF THE CITY OF MADISON STANDARD SPECIFICATIONS FOR PUBLIC WORKS CONSTRUCTION. IF THE BRAND SELECTED BY THE CONTRACTOR IS NOT APPROVED BY THE CITY, THE CONTRACTOR SHALL SUBMIT THE PRODUCT SPECIFICATIONS TO THE ENGINEER FOR REVIEW AND APPROVAL PRIOR TO INSTALLATION.
2. TERRACE SUPPORT SYSTEMS SHALL BE INSTALLED PER S.D.D. 2.16 OF THE CITY OF MADISON STANDARD SPECIFICATIONS FOR PUBLIC WORKS.
3. THE TERRACE SUPPORT SYSTEM LAYOUT IS APPROXIMATE AND IS SUBJECT TO MODIFICATIONS IN THE FIELD BY THE CONSTRUCTION ENGINEER BASED ON UTILITY CONFLICTS OR SPACE RESTRICTIONS.
4. SEE SHEET L-1 FOR TREE SPECIES

14892	MADISON, WI	9360	CONTRACT NO.:	D-3
DETAILS - TERRACE SUPPORT SYSTEM 415 N LAKE ST - STATE STREET CAMPUS GARAGE MIXED USE M:\DESIGN\Projects\14892\CAD\Streets\14892EN-Details.dwg				
<div style="display: flex; justify-content: space-between;"> 14892 D-3 </div>				

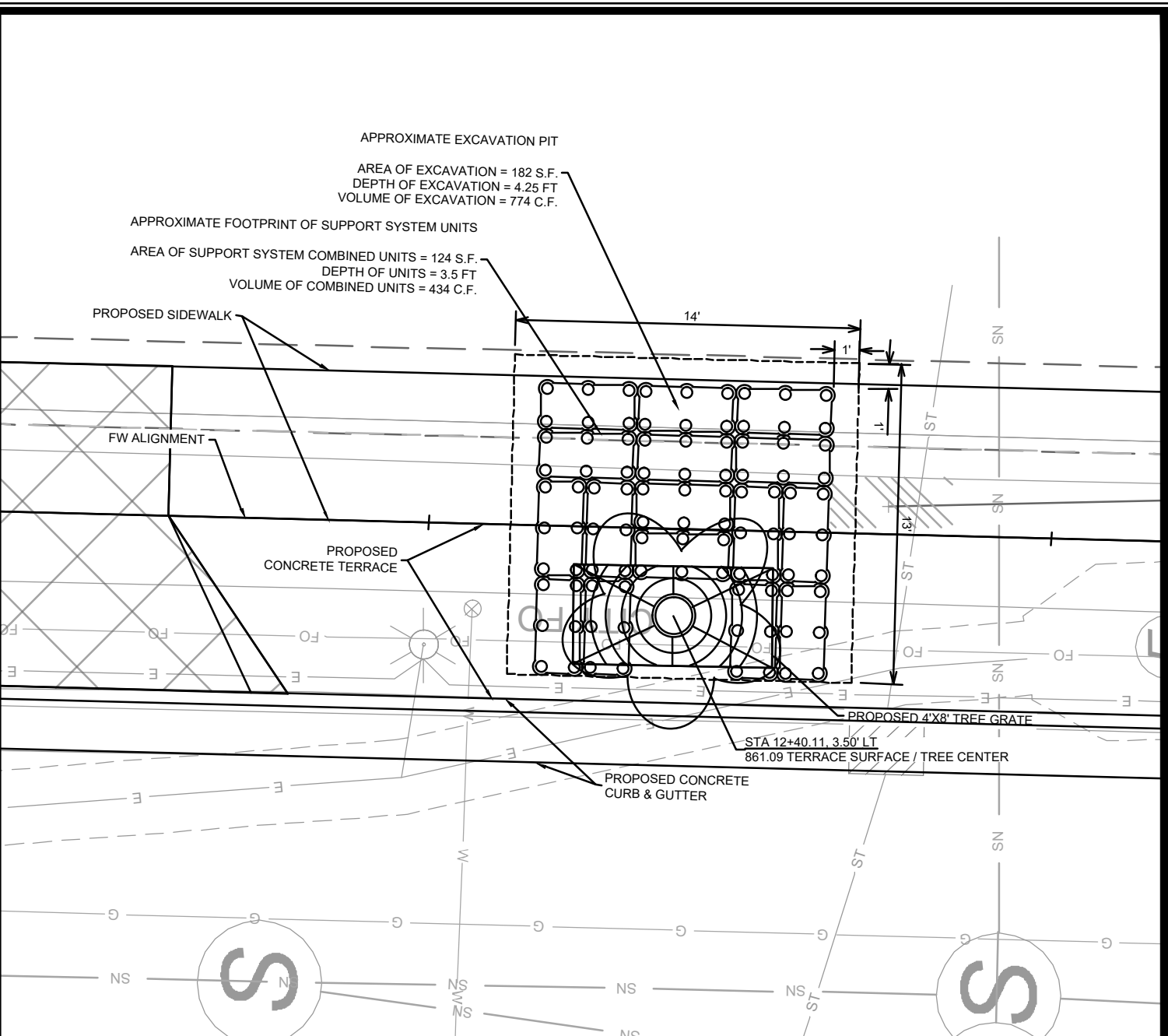
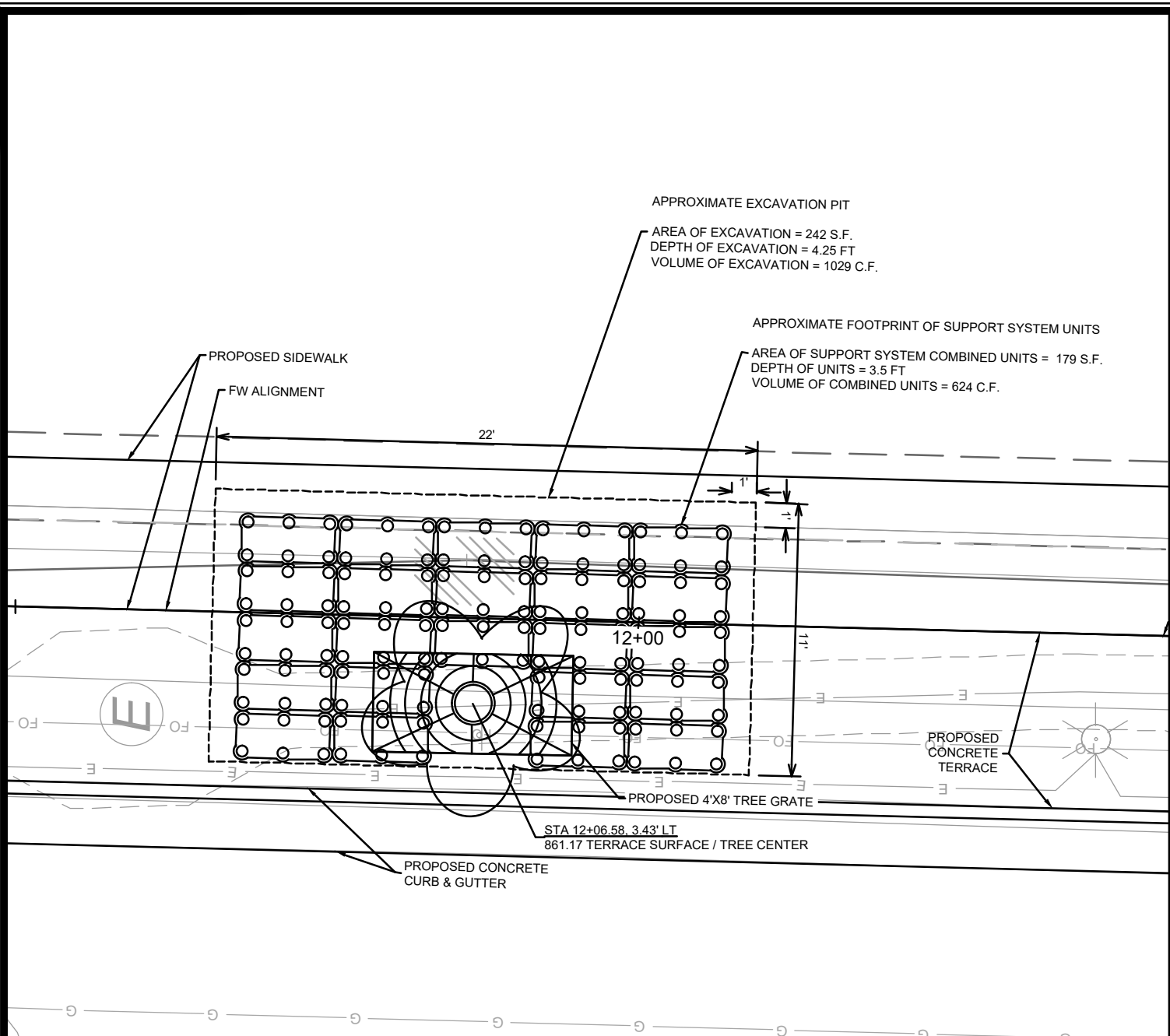

DETAIL TSS-3 TERRACE SUPPORT SYSTEM HORIZONTAL LAYOUT

DETAIL TSS-4 TERRACE SUPPORT SYSTEM HORIZONTAL LAYOUT

SPECIAL NOTES

1. TERRACE SUPPORT SYSTEM DIMENSIONS ARE BASED ON APPROVED BRAND, SILVA CELL BY DEEP ROOT. THE CONTRACTOR CAN INSTALL ANY OF THE APPROVED BRANDS AS DESCRIBED IN ARTICLE 214 OF THE CITY OF MADISON STANDARD SPECIFICATIONS FOR PUBLIC WORKS CONSTRUCTION. IF THE BRAND SELECTED BY THE CONTRACTOR IS NOT APPROVED BY THE CITY, THE CONTRACTOR SHALL SUBMIT THE PRODUCT SPECIFICATIONS TO THE ENGINEER FOR REVIEW AND APPROVAL PRIOR TO INSTALLATION.
2. TERRACE SUPPORT SYSTEMS SHALL BE INSTALLED PER S.D.D. 2.16 OF THE CITY OF MADISON STANDARD SPECIFICATIONS FOR PUBLIC WORKS.
3. THE TERRACE SUPPORT SYSTEM LAYOUT IS APPROXIMATE AND IS SUBJECT TO MODIFICATIONS IN THE FIELD BY THE CONSTRUCTION ENGINEER BASED ON UTILITY CONFLICTS OR SPACE RESTRICTIONS.
4. SEE SHEET L-1 FOR TREE SPECIES

14892	MADISON, WI	9360	D-4
CONTRACT NO.: 14892 415 N LAKE ST - STATE STREET CAMPUS GARAGE MIXED USE M:\DESIGN\Projects\14892\CAD\Streets\14892EN-Details.dwg			
14892 D-4			

- NOTES**
- 5" CONCRETE SIDEWALK
 - 7" CONCRETE SIDEWALK AND DRIVEWAY
 - 9" CONCRETE SIDEWALK AND DRIVEWAY
 - APPROXIMATE AREA FOR TERRACE SUPPORT SYSTEM
 - SEE COMMERCIAL DRIVEWAY PERMIT LINDUE-2022-00092 COMMERCIAL DRIVEWAY PERMIT:
M:\DESIGN\Projects\14892\Project Documents\Permits\TE Commercial Dwy Permit

- LEGEND**
- 7" CONCRETE SIDEWALK AND DRIVE
 - 9" CONCRETE SIDEWALK AND DRIVE
 - 4'X8' TREE GRATE
 - SAWCUT PAVEMENT
 - PROPOSED TREE; SEE SHEET L-1

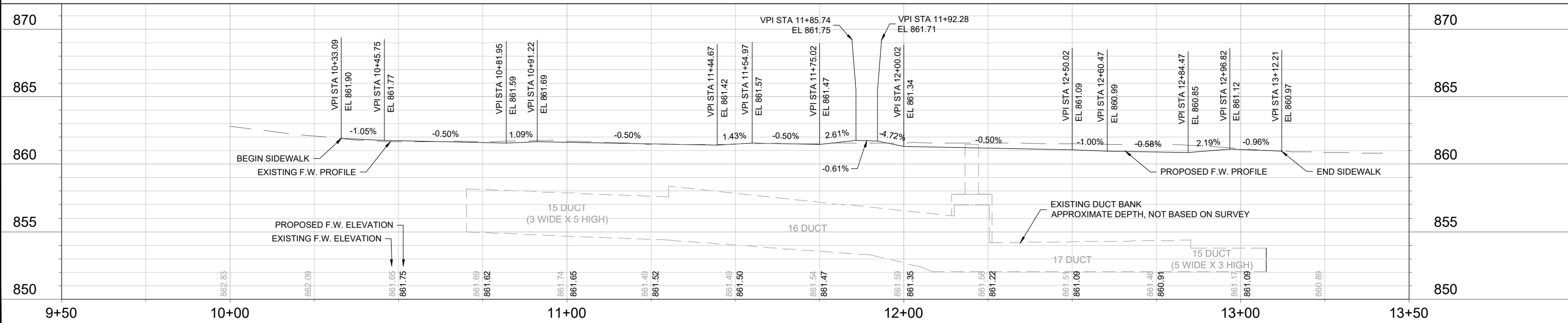
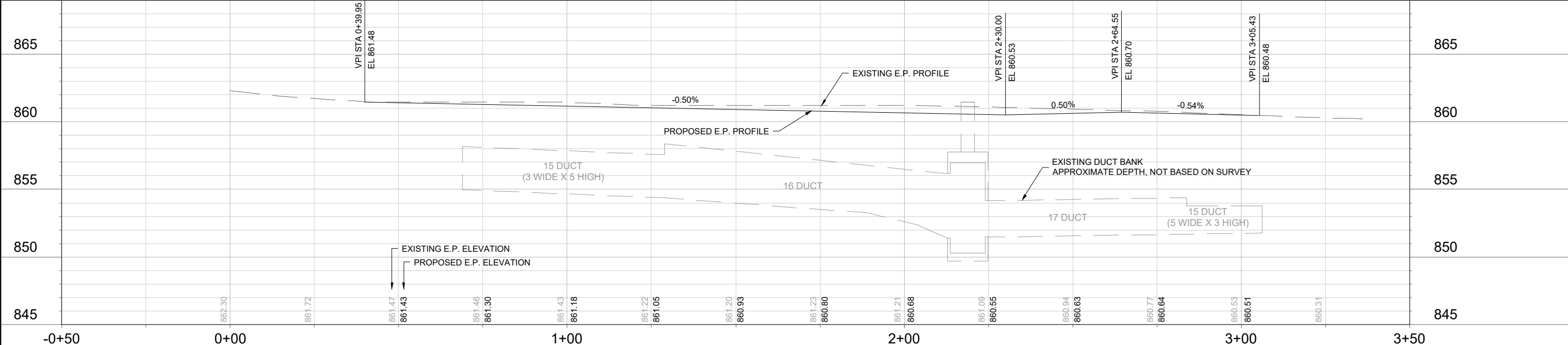
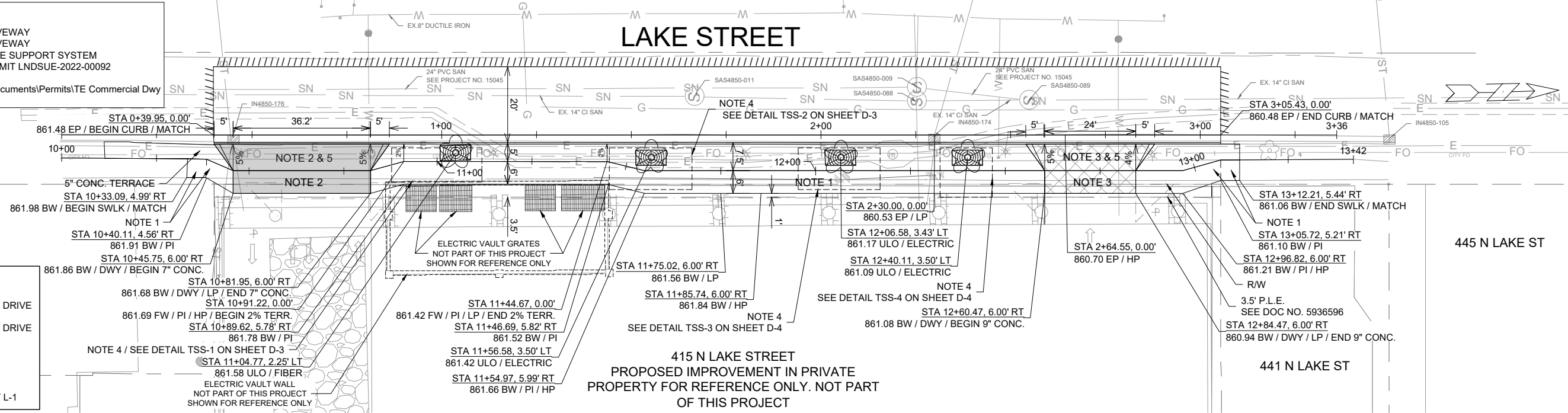

DATE	BY
10/13/2025	14892

14892
MADISON, WI
9360
CONTRACT NO:

PLAN & PROFILE - N LAKE STREET
415 N LAKE ST - STATE STREET CAMPUS GARAGE MIXED USE



14892
P-1

GENERAL ELECTRICAL NOTES:

- ALL LOCATIONS ARE APPROXIMATE. TRAFFIC ENGINEER SHALL APPROVE FINAL LOCATIONS INCLUDING SETBACK IN THE FIELD. AFTER CONTRACTOR SURVEY STAKING, THE CONTRACTOR SHALL NOTIFY GRETCHEN AVILES PINEIRO (266-4899), AT LEAST 24-HOURS IN ADVANCE OF NEEDING BASE LOCATIONS MARKED.
- THE CONTRACTOR SHALL DO ALL WORK IN ACCORDANCE WITH CITY OF MADISON STANDARD SPECIFICATIONS FOR PUBLIC WORKS CONSTRUCTION LATEST EDITION AND ALL ADDENDUMS THERETO.
[HTTPS://WWW.CITYOFMADISON.COM/ENGINEERING/DOCUMENTS/STANDARD-SPECIFICATIONS/COMPLETESPECBOOK.PDF](https://www.cityofmadison.com/engineering/documents/standard-specifications/completespecbook.pdf)
- ALL CONDUIT SHALL BE PVC SCHEDULE 80 UNDER PAVEMENT OR SCHEDULE 40 OTHERWISE. PULL WIRE REQUIRED AS PER STANDARD SPECIFICATIONS.
- THE CONTRACTOR SHALL CALL CITY TE SHOP (266-4767) AT THE TRAFFIC ENGINEERING SHOP AT LEAST 24-HOURS IN ADVANCE OF BURYING CONDUIT TO ARRANGE FOR INSPECTION AND PRIOR TO REMOVING OR CONNECTING TO EXISTING CONDUIT OR HANDHOLES. ANY WORK COMPLETED WITHOUT INSPECTION IS SUBJECT TO REJECTION.
- MATERIALS DESIGNATED TO BE FURNISHED AND INSTALLED BY THE CONTRACTOR SHALL BE SENT FOR APPROVAL TO GRETCHEN AVILES PINEIRO (GAVILESPINEIRO@CITYOFMADISON.COM).
- THE CONTRACTOR SHALL ARRANGE FOR PICKUP OF THE FOLLOWING CITY MATERIALS:
 1" X 40" ANCHOR BOLTS: 2 SETS OF 4 FOR LB-3R BASES

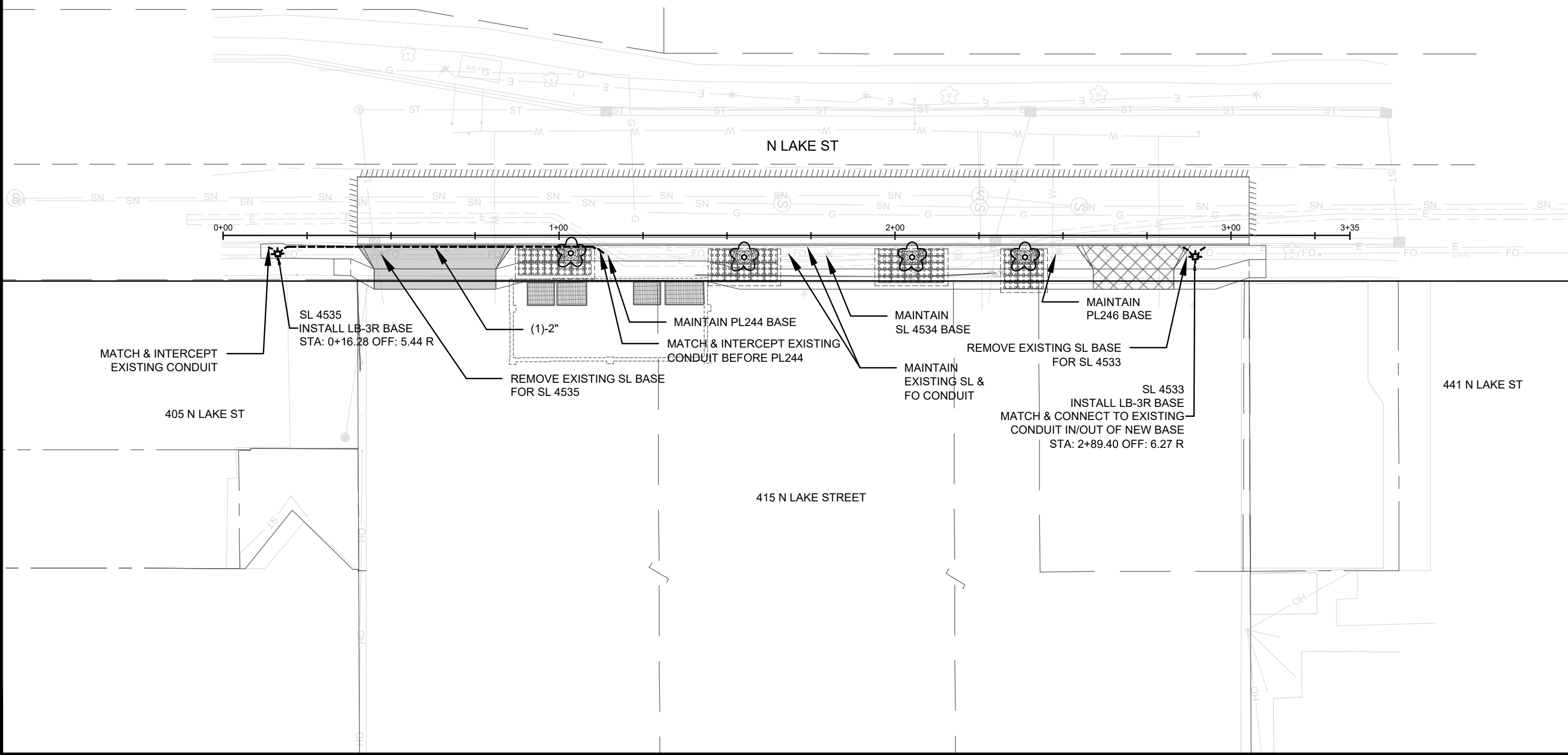
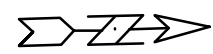

NO.	REVISION	DATE	BY
1			
2			
3			
4			
5			
6			
7			
8			
9			
10			

14892
 MADISON, WI
 9360
 CONTRACT NO:
 ELECTRICAL PLAN
 415 N LAKE ST - STATE STREET CAMPUS GARAGE MIXED USE
 M:\DESIGN\Projects\14892\CAD\Traffic\14892TE-Electrical.dwg
 14892
 E-1

UNIVERSITY AVENUE

STATE STREET

N. LAKE STREET

750

432

701

405

88'

415

441

673

626

661

622

639

Remove Existing
4" Double Yellow

Remove Existing
10' Line x 30' Gap Markings

Remove Existing
5' Line X 5' Gap Markings

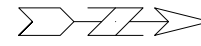

MARK	REVISION	DATE	BY

14892
 415 N LAKE ST - STATE STREET CAMPUS GARAGE MIXED USE
 MADISON, WI
 CONTRACT NO: 9360
 M:\DESIGN\Projects\14892\CAD\Traffic\14892TE-PavementMarkingRemoval.dwg



14892
 PM-1

Designed By: SDM
 Date: 1/14/2025 2:03 PM
 Scale: 1:40
 PM-1

UNIVERSITY AVENUE

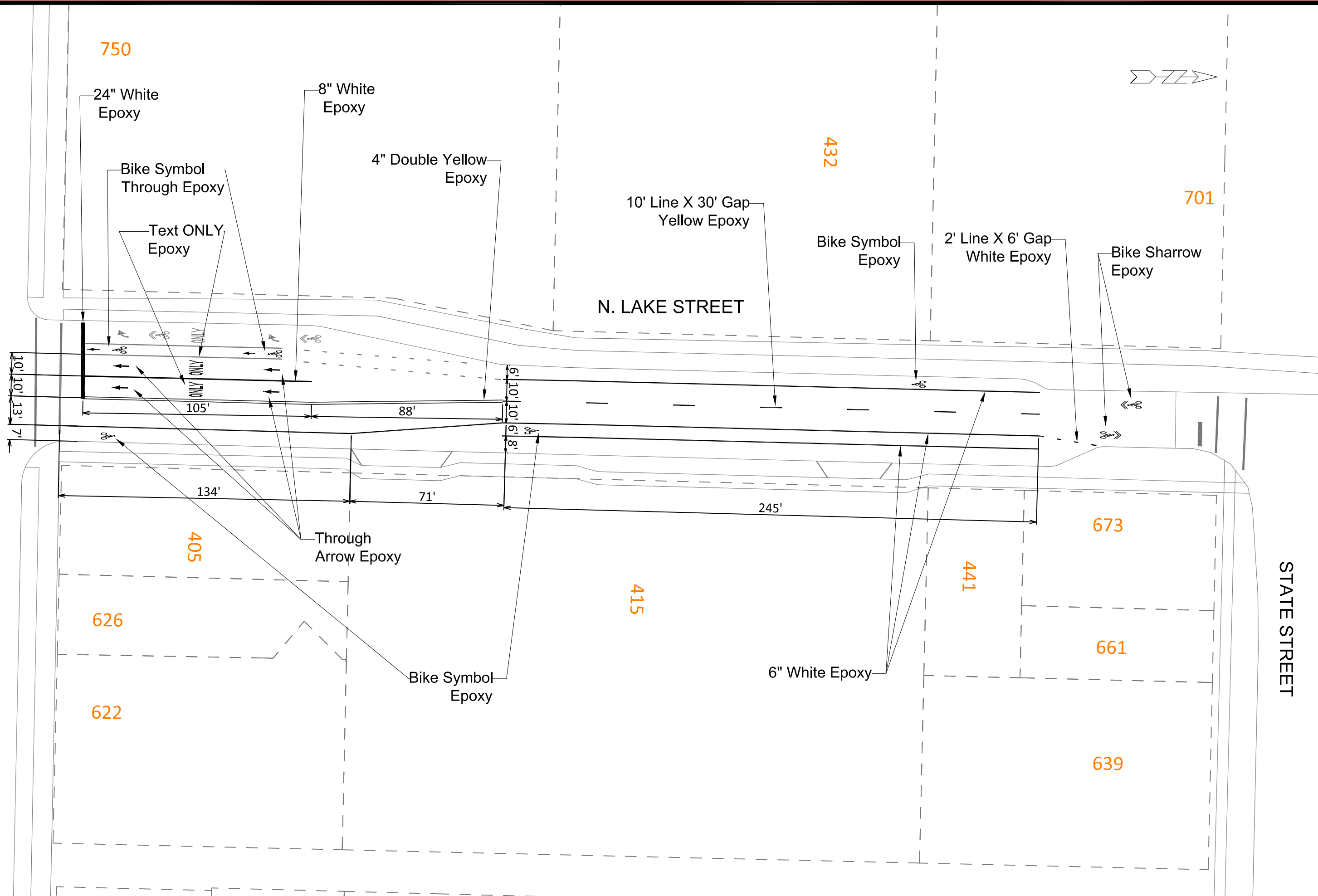

MARK	REVISION	DATE	BY
14892	14892	1/14/2023	257 PM

MARKING PLAN
 14892
 415 N LAKE ST - STATE STREET CAMPUS GARAGE MIXED USE
 MADISON, WI
 CONTRACT NO: 9360

M:\DESIGN\Projects\14892\CAD\Traffic\14892TE-PavementMarking.dwg
 14892
 PM-2



14892
 PM-2

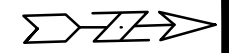

402 N LAKE ST

424 N LAKE ST

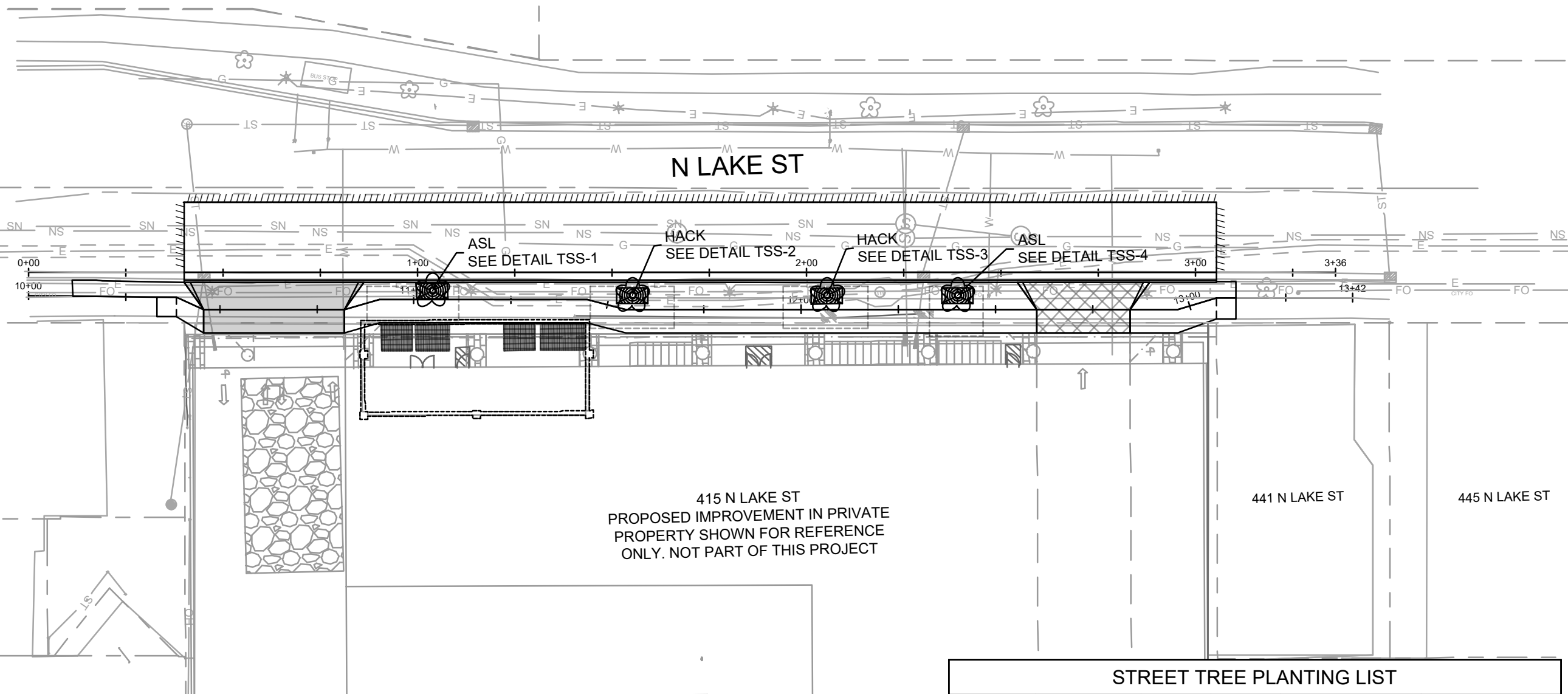

- NOTES:**
1. CONTRACTOR SHALL CONTACT CITY FORESTRY (608) 266-4816 AT LEAST ONE WEEK PRIOR TO PLANTING TO SCHEDULE INSPECTING THE NURSERY STOCK AND REVIEW PLANTING SPECIFICATIONS WITH THE LANDSCAPER
 2. NO LATER THAN FIVE BUSINESS DAYS PRIOR TO FORMING CONCRETE AND CONSTRUCTING TREE GRATE SITES, THE CONTRACTOR SHALL CONTACT CITY FORESTRY AT (608) 266-4816 TO IDENTIFY AND LOCATE UNDERGROUND CONFLICTS (UTILITIES, VAULTS, CONDUITS) OR OTHER UNDERGROUND OBSTRUCTIONS AND DETERMINE GRATE LOCATION.
 3. FOR TERRACE SUPPORT SYSTEM LAYOUTS, SEE SHEETS D-3 & D-4

STREET TREE PLANTING LIST					
SYMBOL	QUANTITY	SIZES	STOCK TYPE	COMMON NAME	BOTANICAL NAME
ASL	2	2 INCH	B&B	AMERICAN SENTRY LINDEN	TILIA AMERICA 'MCKSNENTRY'
HACK	2	2 INCH	B&B	HACKBERRY	CELTIS OCCIDENTALIS

MARK	REVISION	DATE	BY

Designated By: GCIT Date: 1/28/2025 10:14 AM Scale: 1:30
 14892 L-1

LANDSCAPING PLAN
 14892
 MADISON, WI
 415 N LAKE ST - STATE STREET CAMPUS GARAGE MIXED USE
 CONTRACT NO: 9360
 M:\DESIGN\Projects\14892\CAD\Streets\14892EN-LandscapingPlan.dwg



14892
 L-1

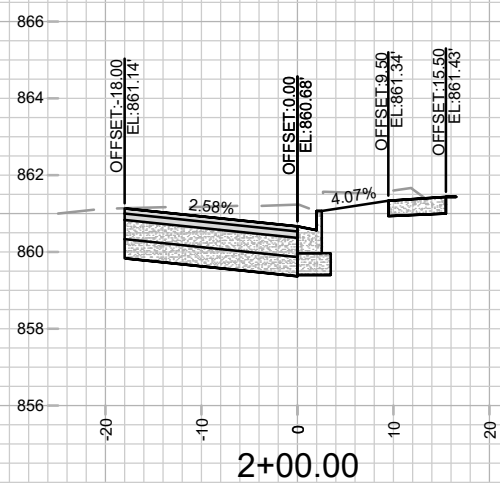
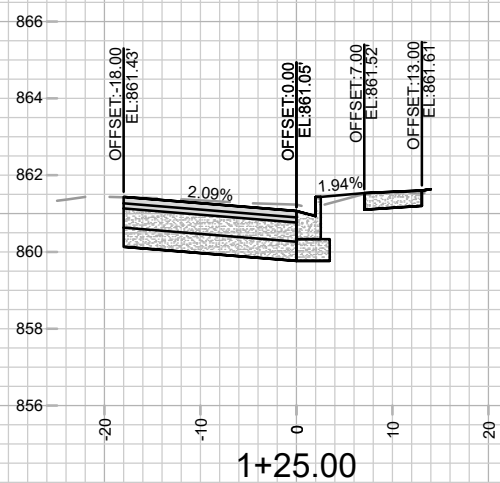
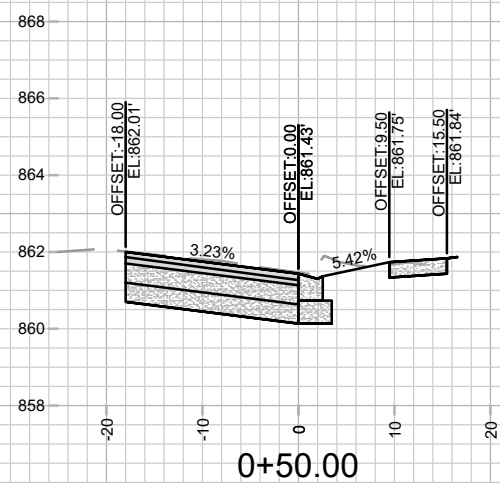
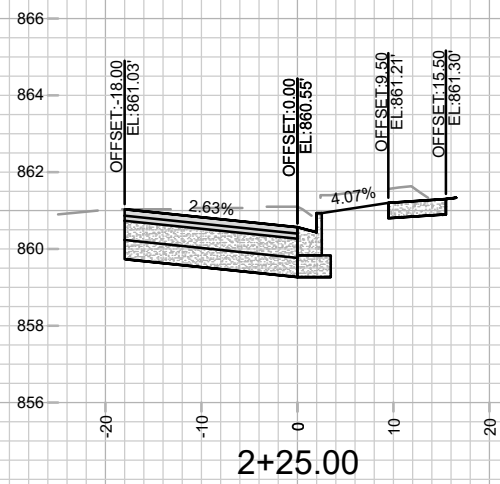
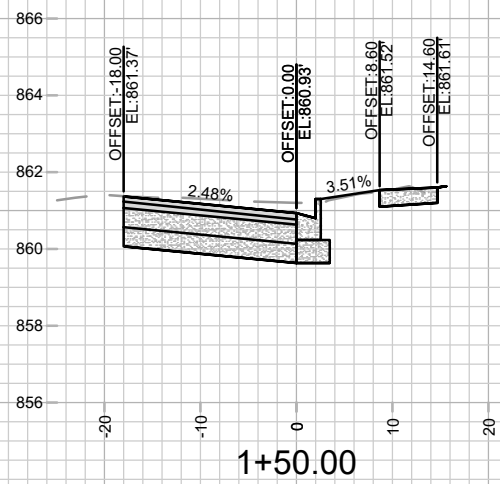
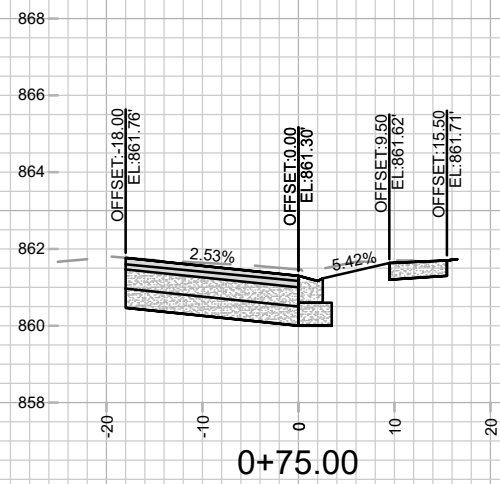
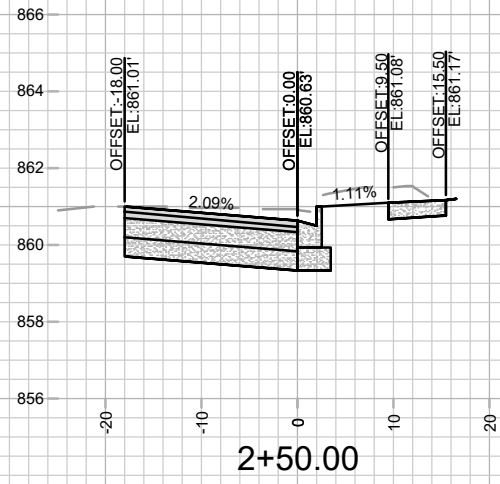
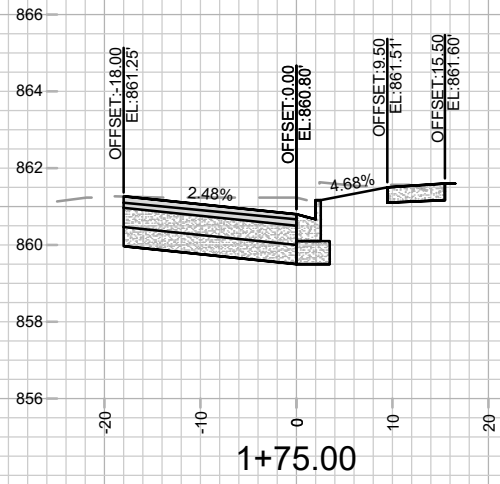
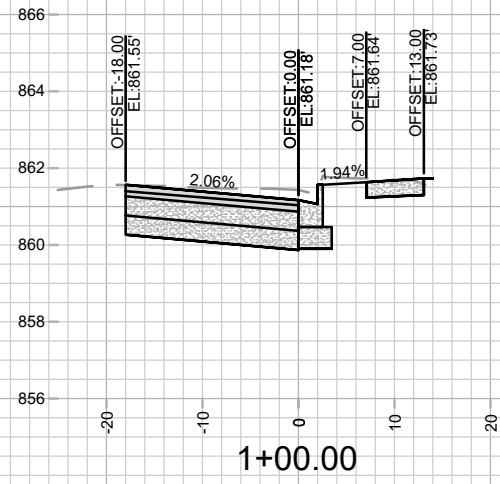

MARK	REVISION	DATE	BY

14892
MADISON, WI

CROSS SECTION - N LAKE STREET
415 N LAKE ST - STATE STREET CAMPUS GARAGE MIXED USE
M:\DESIGN\Projects\14892\CAD\Streets\14892EN-Xsections.dwg



14892
X-1

CONTRACT NO: 9360

14892
X-1

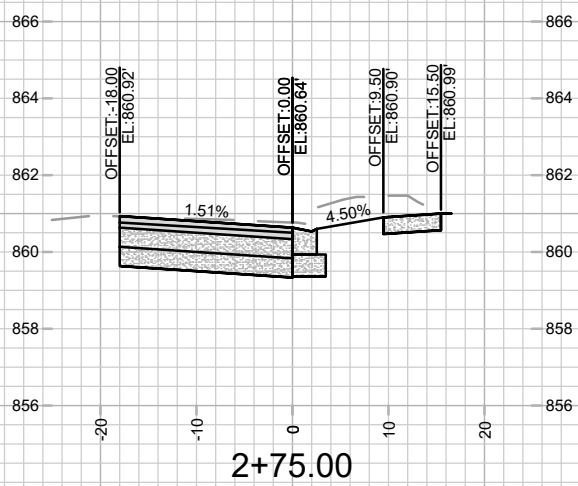
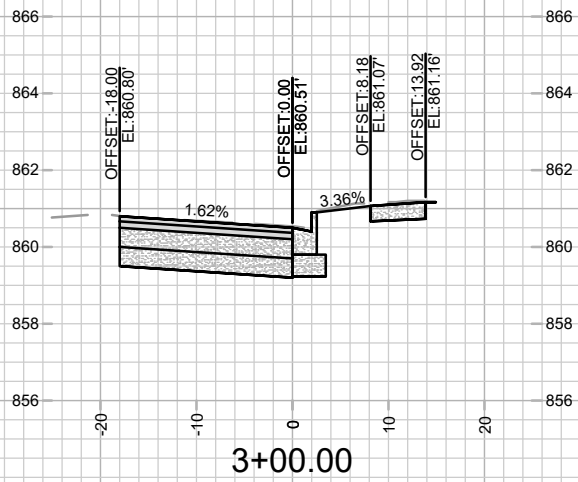

MARK	REVISION	DATE	BY
---	---	---	---
---	---	---	---
---	---	---	---
---	---	---	---

Designated By: GCIT
Date: 10/16/2024 2:44 PM
Scale: 1" = 20'

14892 X-2

14892
 CROSS SECTION - N LAKE ST
 415 N LAKE ST - STATE STREET CAMPUS GARAGE MIXED USE
 M:\DESIGN\Projects\14892\CAD\Streets\14892EN-Xsections.dwg
 CONTRACT NO: 9360



14892
 X-2