

**MONDAY (10/28)
- PAVING WORK**

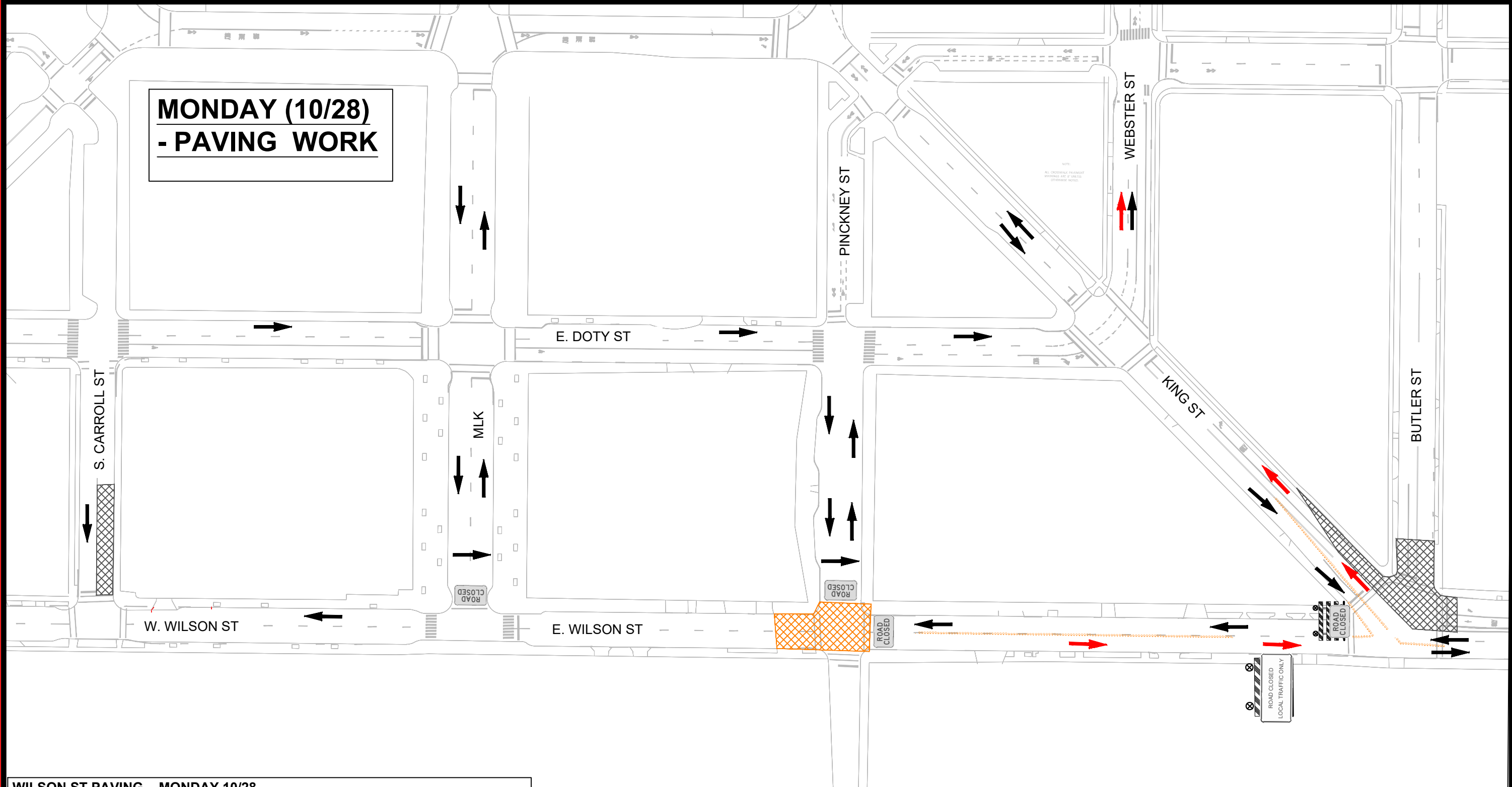

WILSON ST PAVING - MONDAY 10/28

- WILSON ST PAVING TO START AT 11:00AM.
- E. WILSON FROM KING ST TO PINCKNEY ST TO BECOME TEMPORARY TWO-WAY TRAFFIC FOR LOCAL ACCESS ONLY.
- KING ST FROM BUTLER TO DOTY TO BE TEMPORARY TWO-WAY TRAFFIC.
- WESTBOUND TRAFFIC TO FOLLOW POSTED DETOUR ON OUTER SQUARE LOOP. FOLLOW POSTED ROUTE OF WEBSTER ST TO DAYTON ST TO FAIRCHILD.
- CITY PARKING GARAGE WILL HAVE DOTY ST AS ENTRANCE ONLY AND PAVING CONTRACTOR TO MAINTAIN ACCESS TO WILSON ST AS EXIT ONLY.
- ACCESS TO HILTON HOTEL FROM MLK WITH USE OF FLAGGER.

LEGEND:

- TEMPORARY DETOUR ROUTE
- TRAFFIC FLOW
- LANE/ROAD CLOSED

TRAFFIC CONTROL - WILSON ST PAVING- SATURDAY		11543
DOTY & WILSON - RECONSTRUCTION		MADISON, WI
M:\DESIGN\Projects\11543\CAD\Traffic\11543TE-Traffic Control - Paving Saturday 10-19.dwg		8735
CONTRACT NO:		TC - 1
MARK	REVISION	DATE
11543	11543	10/25/2024 11:14 AM
Designed By: LMC	Scale: Custom	BY
		TC - 1

