

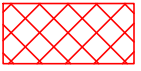

SW COMMUTER PATH CONCRETE WORK:

- STARTING MONDAY 11/4 CPR INC WILL BE RECONSTRUCTING THE EASTERN RAMP AND SIDEWALK TO THE SW COMMUTER PATH ON MIDVALE BLVD.
- DURING THIS WORK THE SW COMMUTER PATH WILL BE CLOSED FROM MIDVALE BLVD TO HIAWATH DR IN BOTH DIRECTIONS.
- PLEASE USE THE POSTED DETOUR ROUTE OF HIAWATH DR TO YUMA DR TO MIDVALE BLVD.
- THE BIKE PATH IS EXPECTED TO REOPEN WEDNESDAY 11/6.

LEGEND:

- PATH CLOSED 
- BIKE DETOUR ROUTE 

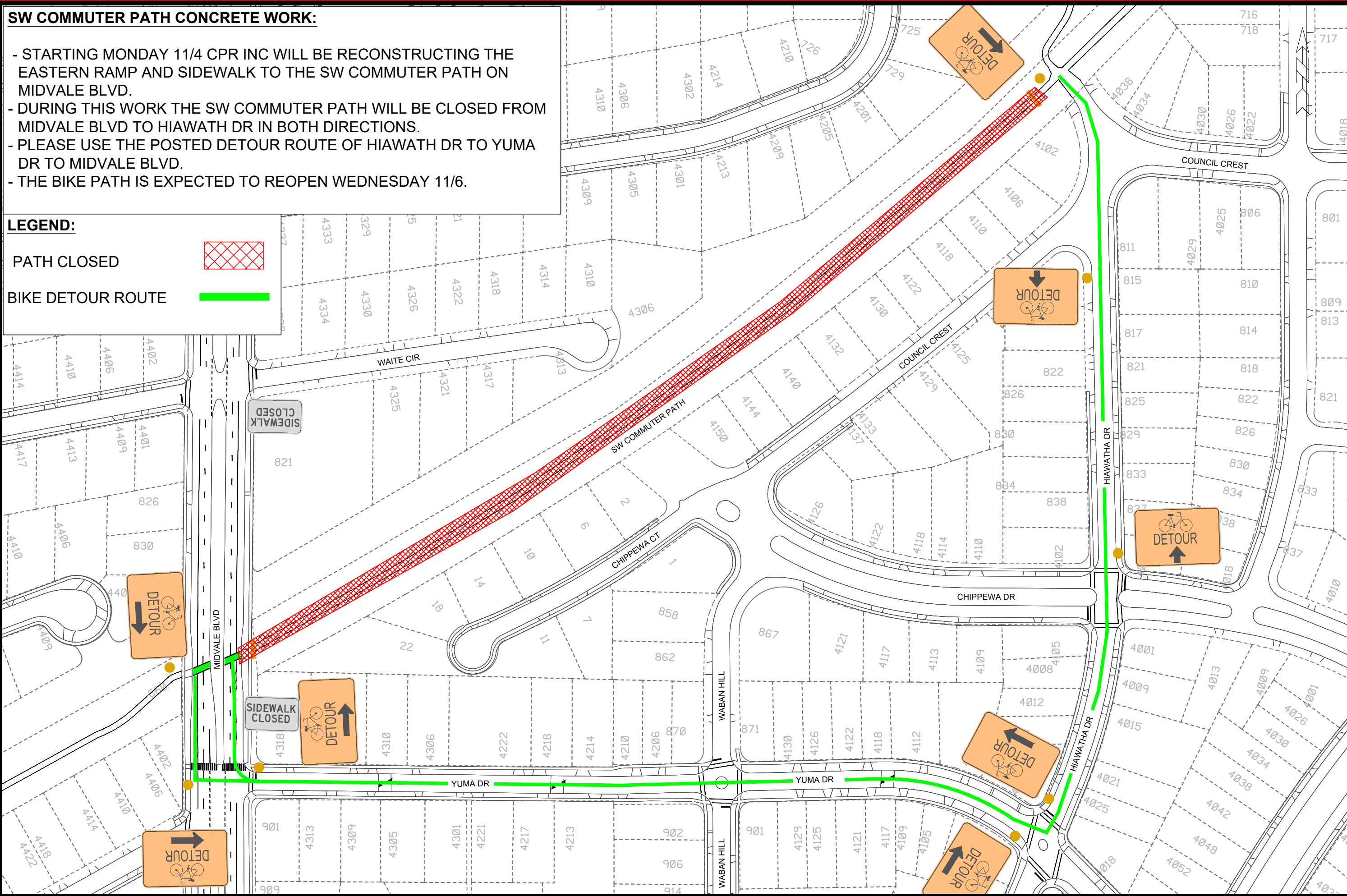

| | | | |
|-------|----------|---------------------|----|
| MARK | REVISION | DATE | BY |
| 14815 | 1 | 10/29/2024 10:01 AM | |

14815
MADISON, WI
8753

BIKE DETOUR PLAN
MIDVALE BLVD & SW COMMUTER PATH
M:\DESIGN\Traffic\Construction Projects\2024\Midvale Blvd and SW Commuter Path Detour.dwg
CONTRACT NO: