

# DRAFT - Route B Potential Loop Reversed and Bus Stop Changes

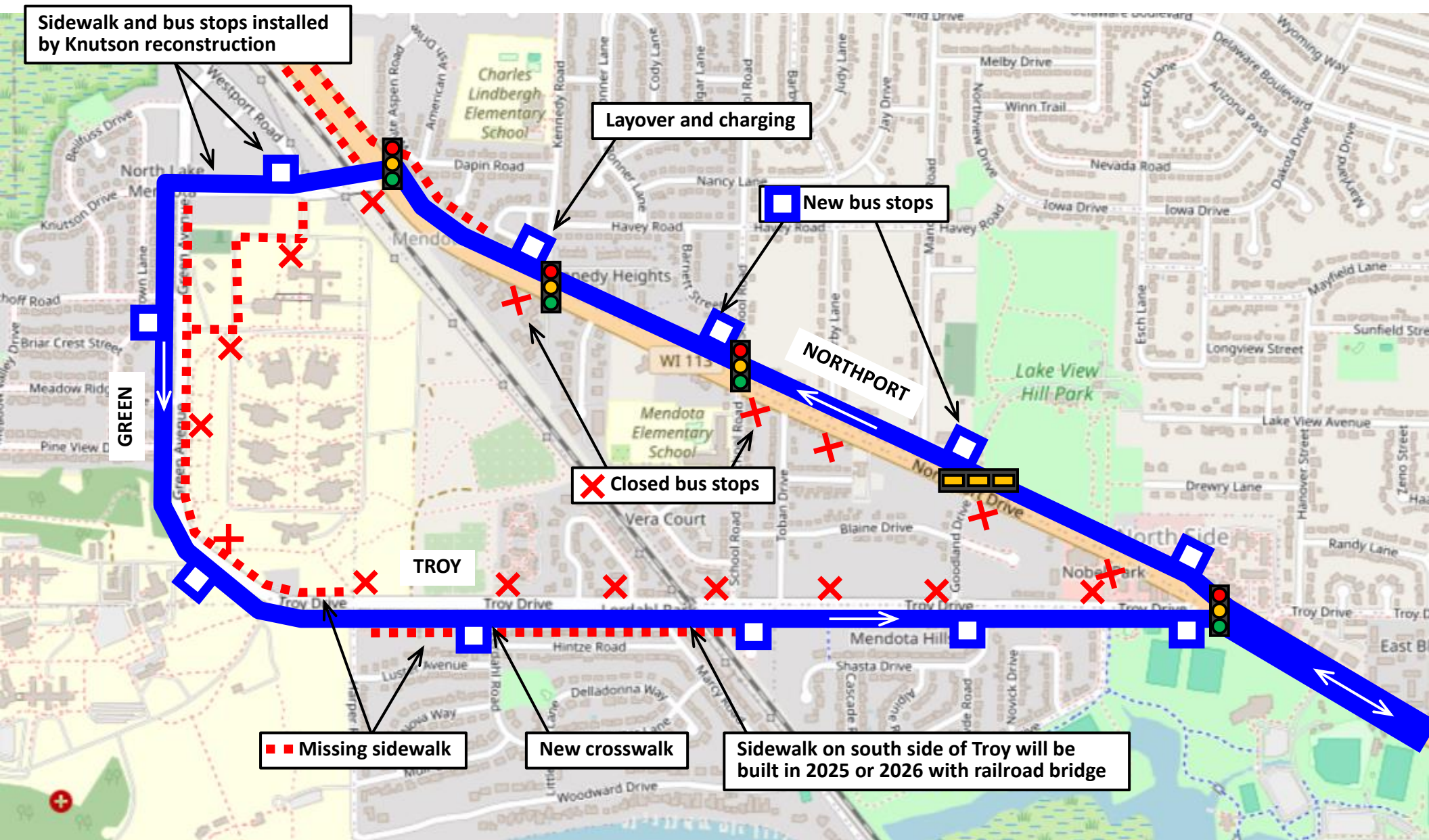

# Summary

- New bus on-route charger built at the northwest corner of Northport and Kennedy, includes pull-out lane, small building, and overhead charger.
- Route terminal moved from Troy and Northport to Northport and Kennedy. This means most people will not have to wait through a layover, they will go directly to and from their bus stop.
- Route B turn around loop via Troy, Green, and Northport would be reversed. Instead of going around clockwise, we would instead go around counterclockwise. This lets us pull into the new terminal at Northport and Kennedy going westbound.
- Reversing the loop would cause us to close all the bus stops on the inside of the loop and create new bus stops on the outside of the loop.
- Parallel projects: Knutson reconstruct, Green Avenue resurfacing, railroad bridge replacement, North-South BRT, lingering Redesign feedback (Route L)

# North End Terminal and Charger Location Westbound Northport at Kennedy

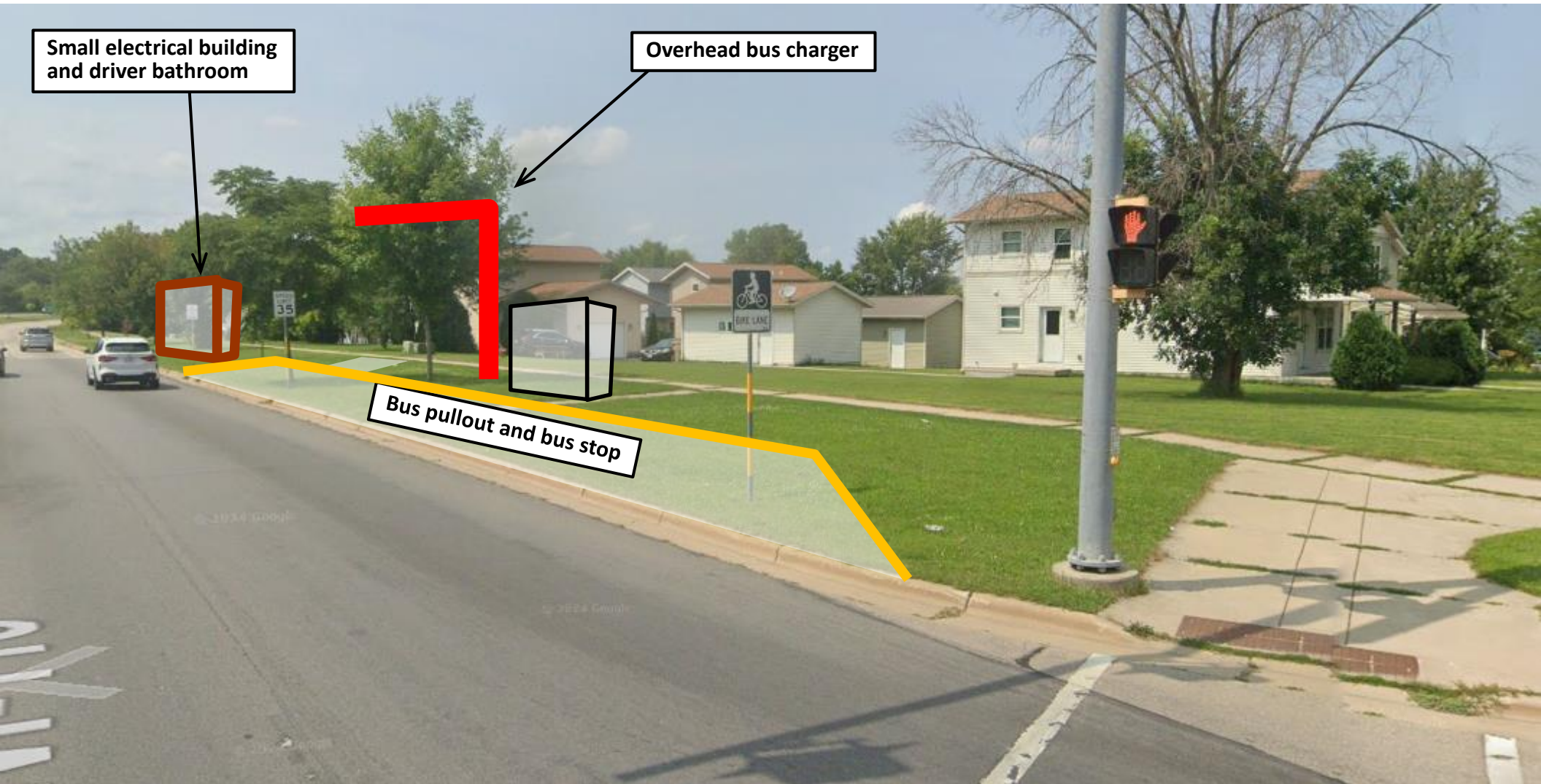



**Electrical building and operator bathroom  
Northport building will be smaller than this one**