



City of Madison
 Department of Public Works
PARKS DIVISION
 330 E. Lakeside St.
 Madison, WI 53715

**play
 MADISON
 PARKS**

Graphical Scale 0 60 N

PROJECT:
**SUN SHELTER
 INSTALLATIONS**

PROJECT ADDRESS:
**NORTH STAR PARK
 502 N. STAR DR.
 MADISON, WI 53704**

Although every effort has been made in preparing these plans and checking them for accuracy, the contractor and subcontractors must check all details and dimensions of their trade and be responsible for the same.

ITEM	DATE
DRAWN BY: AK	2024-08-29

PUBLIC WORKS PROJECT #:
9529

SHEET TITLE:
**PROJECT LOCATION
 AND ACCESS**

SHEET NUMBER:
C2.0

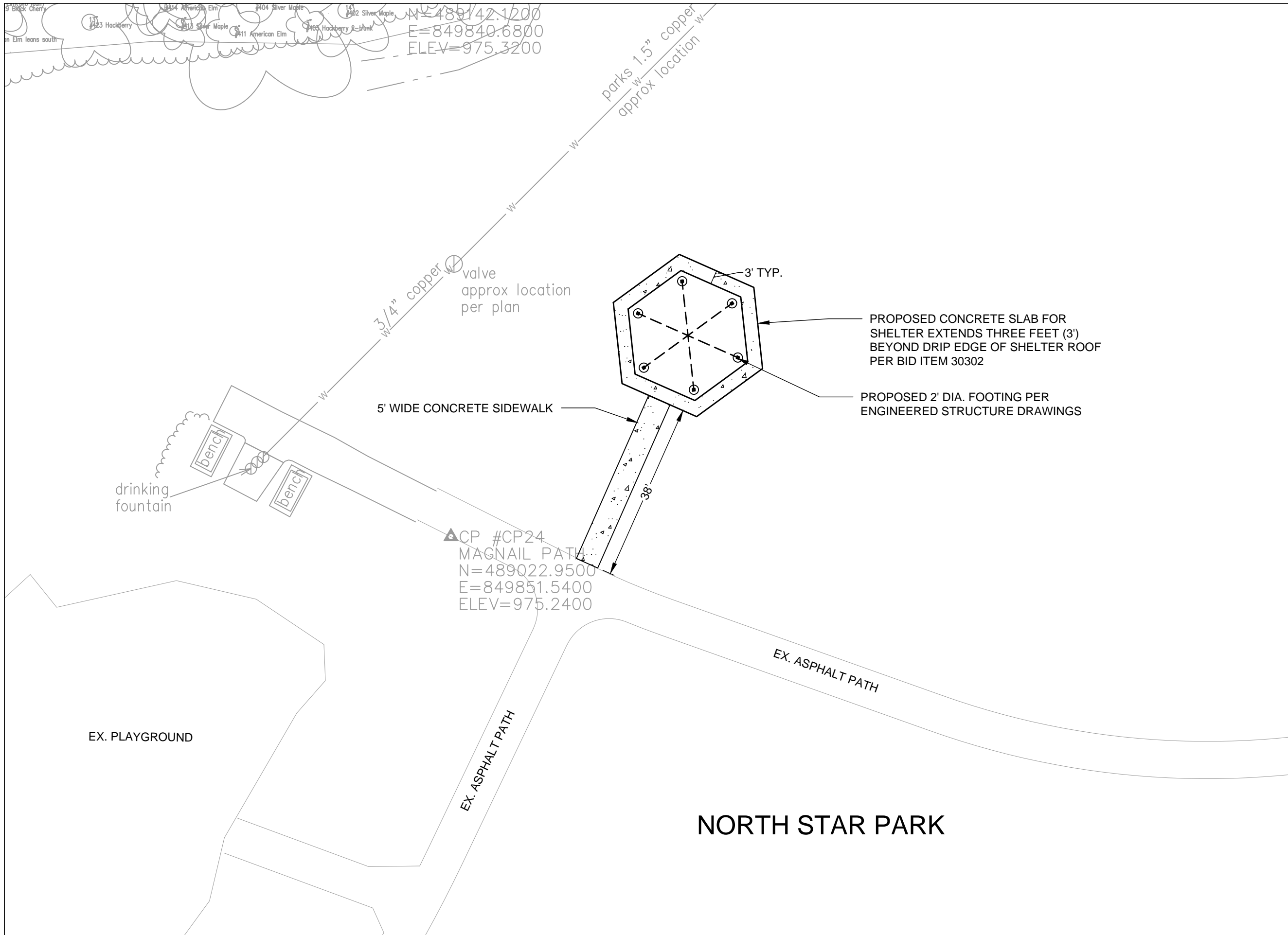

City of Madison
 Department of Public Works
PARKS DIVISION
 330 E. Lakeside St.
 Madison, WI 53715

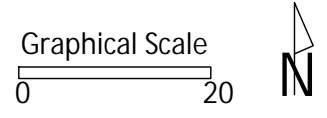

PROJECT:
**SUN SHELTER
 INSTALLATIONS**

PROJECT ADDRESS:
**NORTH STAR PARK
 502 N. STAR DR.
 MADISON, WI 53704**

Although every effort has been made in preparing these plans and checking them for accuracy, the contractor and subcontractors must check all details and dimensions of their trade and be responsible for the same.

ITEM	DATE
DRAWN BY: AK	2024-08-29

PUBLIC WORKS PROJECT #:
9529

SHEET TITLE:
SITE PLAN

SHEET NUMBER:
C2.2

