



**MADISON  
PARKS**

# Ontario Park Playground Replacement

# ONTARIO PARK – BREAKOUT SESSION

## Discussion Items

- Existing Equipment
- Playground Location
- Playground Surfacing
- Fundraising
- Playground Design – Option A
- Playground Design – Option B
- Next Meeting



# ONTARIO PARK- EX. PLAYGROUND EQUIPMENT



# ONTARIO PARK- EXISTING



# City of Madison Playground Options Surfacing

### City of Madison Playground Surfacing Options Comparison

Recycled Shredded Rubber	Engineered Wood Fiber Mulch
<ul style="list-style-type: none"><li>• Meets U.S. Access Board's ADA Accessibility Guidelines for Play Areas</li><li>• Meets CPSC fall height requirements</li><li>• Softer play surface material</li><li>• Provides alternative use for recycled tires</li><li>• Sandalwood/brown color-coated to reduce heat impact compared to non-coated black recycled rubber</li><li>• Higher initial cost, lower maintenance cost</li><li>• Needs to be topped off every 5 years depending on site conditions and use</li><li>• Non-biodegradable</li><li>• Thaws fast, playgrounds available throughout the year</li></ul>	<ul style="list-style-type: none"><li>• Meets U.S. Access Board's ADA Accessibility Guidelines for Play Areas</li><li>• Meets CPSC fall height requirements</li><li>• Not as soft as recycled shredded rubber</li><li>• Created by the City from fallen trees and limbs that would otherwise be chipped for mulch</li><li>• More likely to get mold and mildew spores</li><li>• Lower initial cost, higher maintenance cost</li><li>• Needs to be topped off every 1 to 3 years depending on site conditions and use</li><li>• Biodegrades</li><li>• Thaws slowly, playground use limited during winter conditions</li></ul>



Waltham Park- Rubber



Dudgeon School Park- Wood

# Fundraising

- Commitment to raise \$2,000 for the installation of an approx. 10'x10' pea gravel box area.

# Playground Design

- Include monkey bars with a flat top
- 2 slides – one lower, one higher
- Multi-level structure
- “Obstacle course”
- Include faux boulders
- Include lower level play elements
- No shade structure elements needed

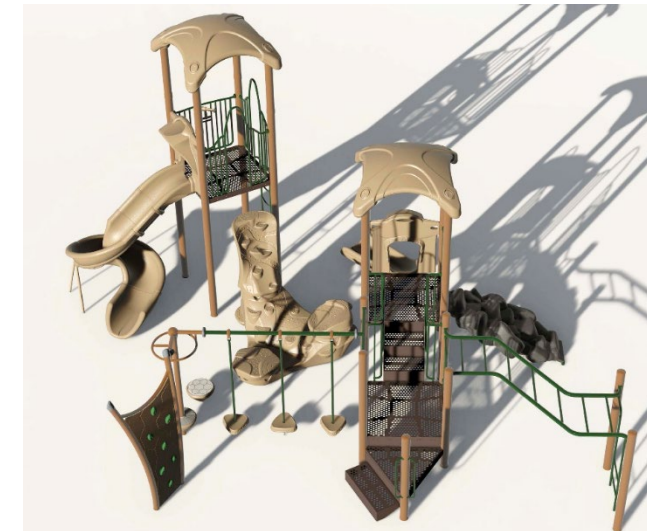

# Playground Design Option A

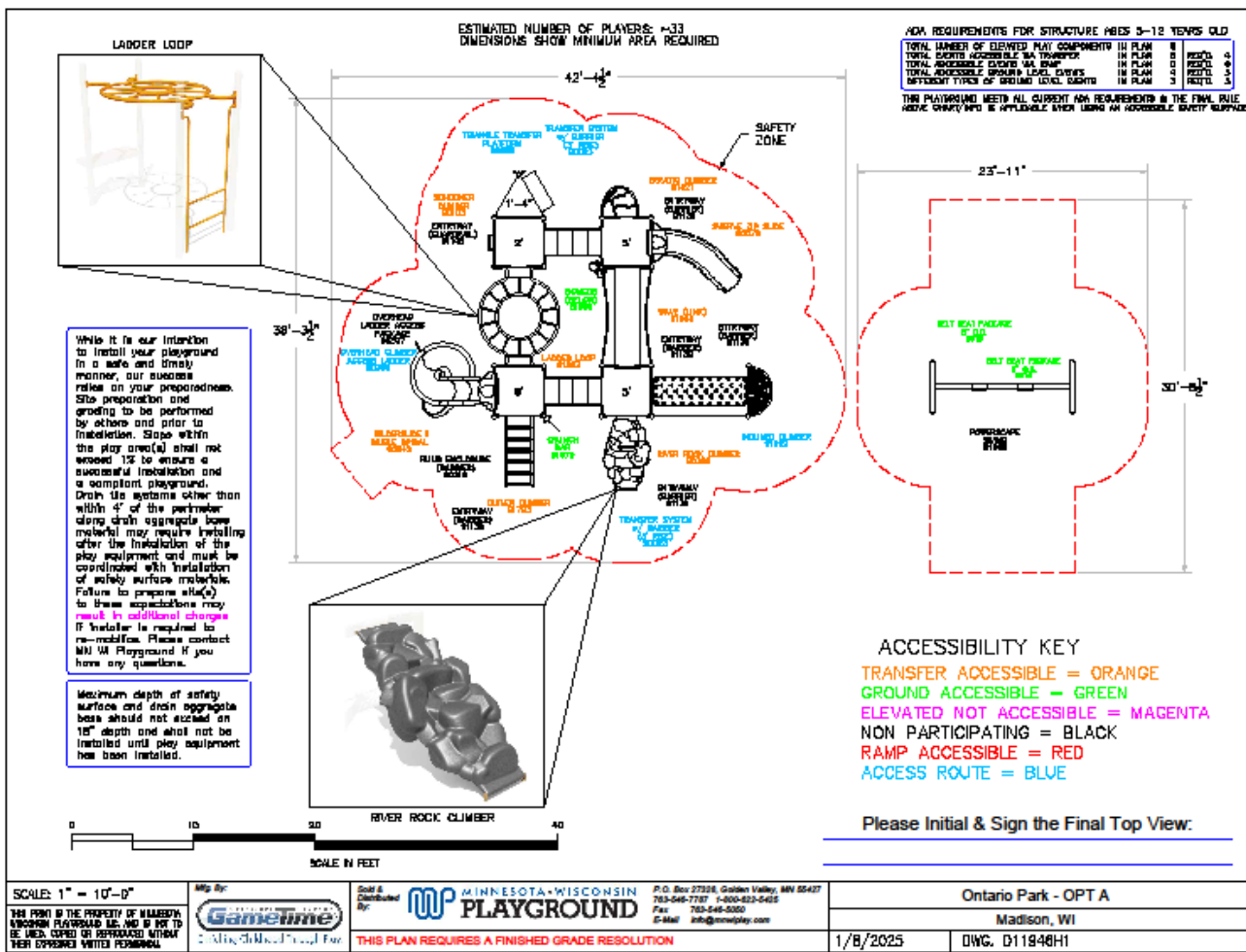

**ONTARIO PARK - OPT A**  
Madison, WI D11946H1

Images are a representation only. Actual product may vary.



# Playground Design Option A



Color Palette: Custom

- Uprights: Sky Blue
- Accent: Azure
- Roto Plastic: Beige
- Rock: Deep Granite
- Decks: Brown



**ONTARIO PARK - OPT A**  
Madison, WI D11946H1



Images are a representation only.  
Actual product may vary.

# Playground Design Option A



**ONTARIO PARK - OPT A**  
Madison, WI D11946H1



Images are a representation only.  
Actual product may vary.

# Playground Design Option A



**ONTARIO PARK - OPT A**  
Madison, WI D11946H1



# Playground Design Option A

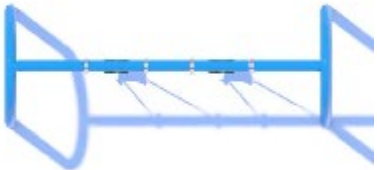
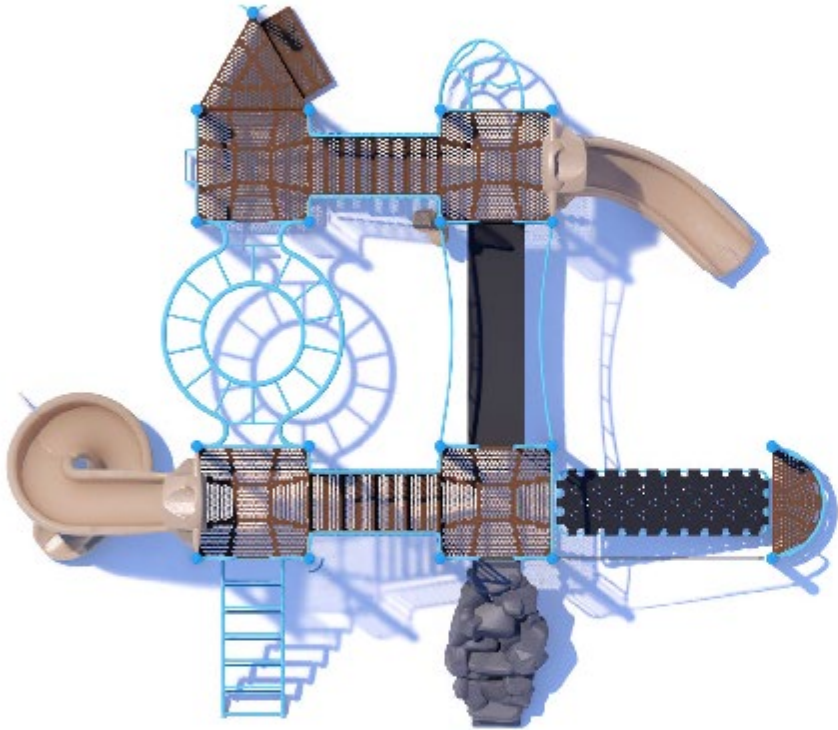

**ONTARIO PARK - OPT A**  
Madison, WI D11946H1



Images are a representation only.  
Actual product may vary.

# Playground Design Option A



## Playground Design Option B

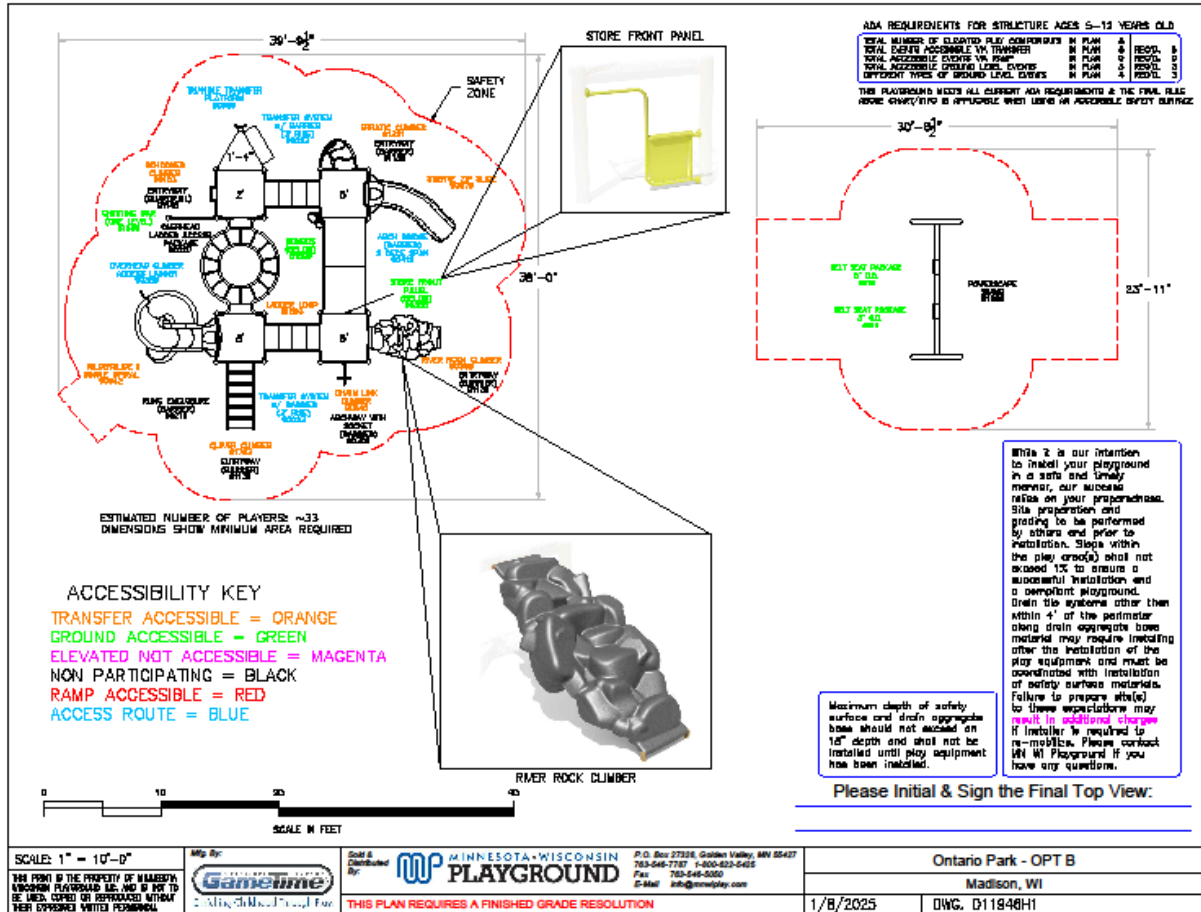

**ONTARIO PARK - OPT B**  
Madison, WI D11946H1

Images are a representation only. Actual product may vary.

# Playground Design Option B



Color Palette: Custom

- Uprights: Sky Blue
- Accent: Royal Purple
- Roto Plastic: Beige
- Rock: Deep Granite
- Decks: Brown



**ONTARIO PARK - OPT B**  
Madison, WI D11946H1



# Playground Design Option B



**ONTARIO PARK - OPT B**  
Madison, WI D11946H1



Images are a representation only.  
Actual product may vary.



# Playground Design Option B



**ONTARIO PARK - OPT B**  
Madison, WI D11946H1



# Playground Design Option B

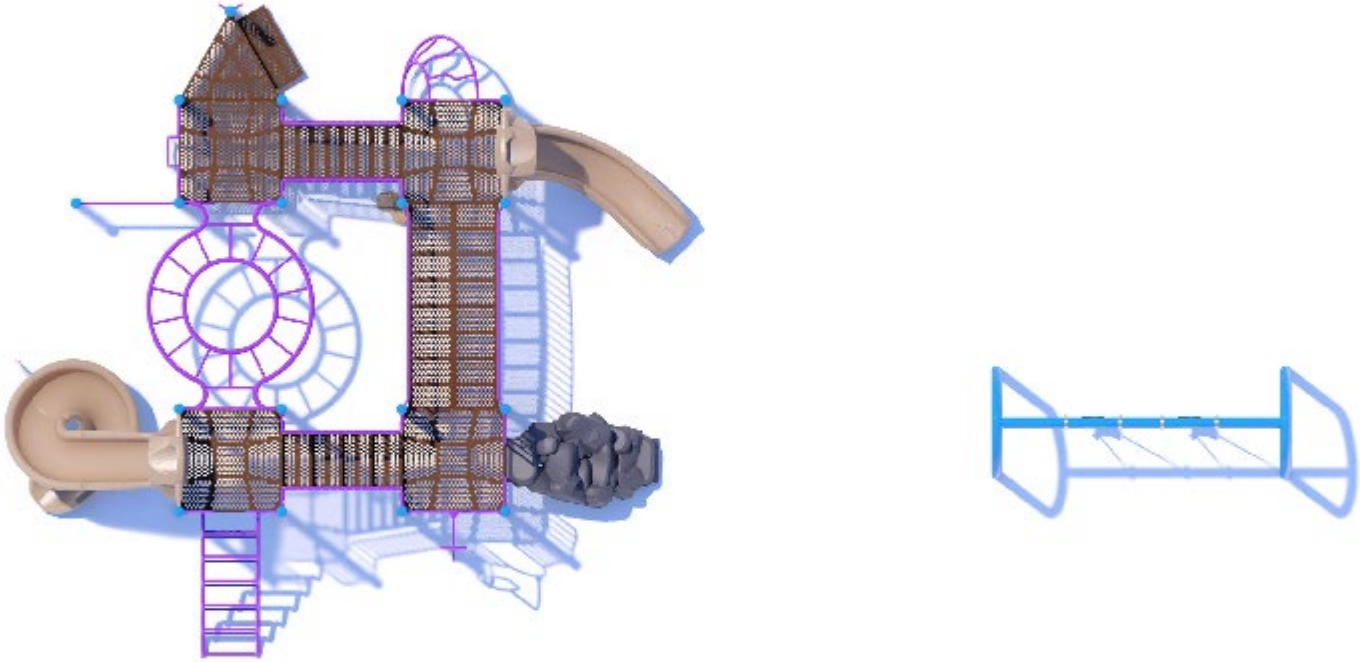

**ONTARIO PARK - OPT B**  
Madison, WI D11946H1



# Playground Design Option B

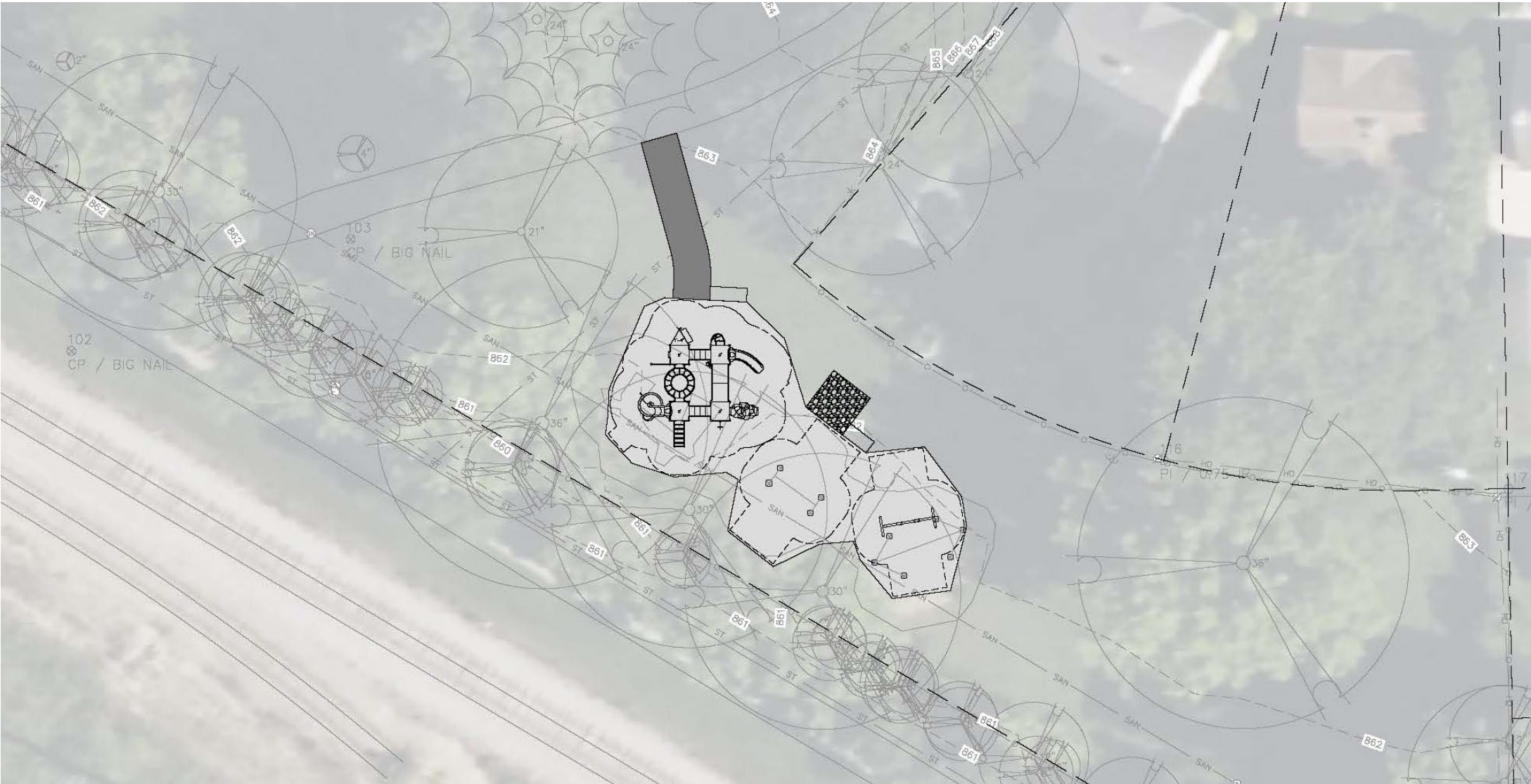

# Playground Design Option C



Color Palette: Custom  
Uprights: Sky Blue  
Accent: Orange  
Roto Plastic: Beige  
Rock: Deep Granite  
Decks: Brown



**ONTARIO PARK - OPT C**  
Madison, WI D11946H1



**ONTARIO PARK - OPT C**  
Madison, WI D11946H1



Images are a representation only.  
Actual product may vary.

Images are a representation only.  
Actual product may vary.

**If additional input is needed, staff will reach out to meeting attendees via email.**

**Construction is anticipated to occur during the Summer of 2025. Specific dates will be posted on the project page when they are available.**

**Additional information related to this project is posted on the Parks Project Portal, here: <https://www.cityofmadison.com/parks/projects/ontario-park-playground-improvements>**

**Contact Adam Kaniewski, project manager, with additional questions or comments.  
(608) 261-4281 or [akaniewski@cityofmadison.com](mailto:akaniewski@cityofmadison.com)**

**85% of the total fundraising goal must be received by Madison Parks Foundation by: 3/31/2025**